

11/29/95
11/29/95

11/20/12 477
CANCELED 12 1999
STATE RECORD FEE \$2.00

BERRIEN COUNTY REMONUMENTATION

LAND CORNER RECORDATION CERTIFICATE
Filing Requirement of Act 74, Mich. P.A. 1970

Warren A. Law
4-25-95

RECORDED

Nov 29 3 39 PM '95

Warren A. Law
REGISTER OF DEEDS
BERRIEN COUNTY MICHIGAN

Register of Deeds Stamp & File Number

For corners in

<u>BERRIEN</u> (County)	Located In:	Corner Code #
1. Public Land Survey	T 6S R 17W	A-1
Comment: T5S, R17W, A13	T _____ R _____	_____
T5S, R18W, M13	T _____ R _____	_____
T6S, R18W, M1	T _____ R _____	_____
2. Property Controlling in Section	S _____ T _____ R _____	_____
3. Miscellaneous Property in Sec.	S _____ T _____ R _____	_____
4. Lot No. _____, Recorded Plat _____		
5. Private Claims _____		

A	B	C	D	E	F	G	H	I	J	K	L	M
2	6	5	4	3	2	1						
3												
4	7	8	9	10	11	12						
5												
6	18	17	16	15	14	13						
7												
8	19	20	21	22	23	24						
9												
10	30	29	28	27	26	25						
11												
12	31	32	33	34	35	36						
13												

I, JOHN G. KAMER, in a field survey on NOVEMBER 17, 19 95, do hereby certify that under requirements of P.A. 74, Michigan P.A. of 1970, the corner points mentioned in lines 1 and 2 above were in conformance with regulations and rules therefore as required in the current manual of survey instructions of the United States Department of the Interior, Bureau of Land Management or by a decree of a Court of Law and/or that the corner points mentioned in lines 3, 4 and 5 above were in conformance with the rules of the Michigan Board of Land Surveyors or by a Decree of a Court of Law; established, re-established, monumented, re-monumented, recovered, found as expressed below:

NOTE: Not more than 4 corners, all in the same town and range, may be recorded on this certificate.

A. Description of original monument and accessories and/or subsequent restoration:
(SEE BACK.)

COPIED & MONUMENTATION
MAR 27 1996
COMMISSION

B. Description of corner evidence found and/or method applied in restoring or reestablishing corner:

FOUND IRON AT FENCE INTERSECTION PER 1930± SURVEY NOTES. THE PERPETUATION OF THE CORNER AS EVIDENCED BY THE WITNESS TIES APPEARS RELIABLE AND ACCURATE.

C. Description of monument for corner and accessories established to perpetuate locating the position of the corner:

REMOVED 2' X 1 1/2" IRON PIPE
SET STANDARD 3' X 4" CONCRETE MONUMENT WITH BRASS PLATE. ALSO SET CARSONITE MARKER IN VICINITY OF CORNER.
SET NAIL W/TAG IN 16" TULIP S50° E 22.72'
SET NAIL W/TAG IN 18" TULIP S40° E 24.30'
SET NAIL W/TAG IN 16" CHERRY S25° E 25.16'
SET NAIL W/TAG IN 36" STUMP N60° E 12.22'
CORNER IS ACCEPTED AS A CAREFUL AND FAITHFUL PERPETUATION OF THE POSITION OF THE ORIGINAL CORNER.

Signed by *John G. Kamer*
Surveyor's Michigan License No. 27449

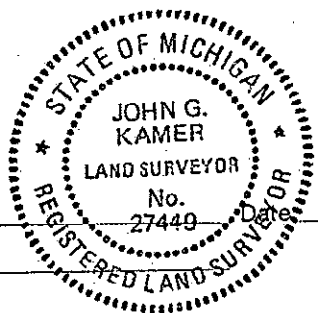

11-29-95

**Berrien Township (T 6 S, R 17 W)
NW Cor. Sec. 6 (A-1)**

March 15, 1827

William Brookfield, D.S.
(From East) 82.00 Set @ Cor. to Towns 5 & 6 South
Ranges 17 & 18 West
Beech 9 S 35½ E 22
Beech 14 N 22¼ W 19

1930±

Notes on file @ W&A
No Jog - Fence Corner at Corner
Surveyed Surrounding Parcels

April 2, 1973

Richard Garrett @ W&A, LCRC, Liber 1, page 292
⅝" Bolt in Mon. Box
Utility Pole S 45° W 48.25'
Light Pole S 45° E 40.35'
St. Sign Pole N 45° E 44.30'

Nov. 6, 1975

E.R. Stefan
Point Found - No Witnesses

March 22, 1988

May 4, 1988

Sept. 26, 1988

Nov. 22, 1989

Kamer @ W&A
NW Cor. 6-6-18
Fd. Iron
16" Oak S 60° E 22.8'
20" Oak S 45° E 24.4'

Sept. 24, 1991

Nov. 6, 1991

At Intersection of Fence Lines South and West
Strebs @ W&A
Northeast Corner
Sec. 1-6-18
(Fnd. 1 ¼" Iron Pipe at Intersection of Fences)
PK Nail in 16" Tulip S 50° E 22.86'
PK Nail in 18" Tulip S 45° E 24.48'
PK Nail in 16" Cherry S 35° E 25.20'
PK Nail in 36" Stump N 40° E 12.10'