

SURVEY & REMONUMENTATION

RAISED BY THE BERRIEN COUNTY SURVEY PEER GROUP AS THE OFFICIAL CORNER UNDER MICHIGAN PUBLIC ACT 345 OF 1990

APR 26 1995

12/22/94

111#9309

A33

CORNER

\$9.00

12/22/94

111#9309

A33

STATE REMON FEE \$2.00

W. G. Kamer
October 27, 1994
 For corners in

COMMISSION LAND CORNER RECORDATION CERTIFICATE

Filing Requirement of Act 74, Mich. P.A. 1970
 Berrien County Remonumentation

Berrien <small>(County)</small>	Located In:	Corner Code #/	
1. Public Land Survey	T 6S R 17W	C-10	
	T 6S R 17W	B-10	
	T _____ R _____	_____	
	T _____ R _____	_____	
2. Property Controlling in Section	S _____ T _____ R _____	_____	
	S _____ T _____ R _____	_____	
3. Miscellaneous Property in Sec.	S _____ T _____ R _____	_____	
	S _____ T _____ R _____	_____	
4. Lot No. _____, Recorded Plat _____			
5. Private Claims _____			

Christine D. ...
 REGISTERED LAND SURVEYOR

DEC 22 10 03 AM '94

RECORDED

Register of Deeds Stamp & File Number

	A	B	C	D	E	F	G	H	I	J	K	L	M
2	6	5	4	3	2	1							
3													
4	7	8	9	10	11	12							
5													
6	18	17	16	15	14	13							
7													
8	19	20	21	22	23	24							
9													
10	●	●	29	28	27	26	25						
11													
12	31	32	33	34	35	36							
13													

I, John G. Kamer, in a field survey on December 14, 19 94, do hereby certify that under requirements of P.A. 74, Michigan P.A. of 1970, the corner points mentioned in lines 1 and 2 above were in conformance with regulations and rules therefore as required in the current manual of survey instructions of the United States Department of the Interior, Bureau of Land Management or by a decree of a Court of Law and/or that the corner points mentioned in lines 3, 4 and 5 above were in conformance with the rules of the Michigan Board of Land Surveyors or by a Decree of a Court of Law; established, re-established, monumented, re-monumented, recovered, found as expressed below:

NOTE: Not more than 4 corners, all in the same town and range, may be recorded on this certificate.

A. Description of original monument and accessories and/or subsequent restoration:
 C-10 (See back) B-10 (See back)

B. Description of corner evidence found and/or method applied in restoring or reestablishing corner:
 C-10 Found 1" iron pipe in mon. box Distances to adjacent corners were reasonable & consistant, accepted 1" iron pipe as best evidence of corner. Previous Strebs LCRC Lb. 2 pg. 422.
 B-10 Found RR spike & reestablish nail location per Streb 9/82 survey. Distances to adjacent corners were reasonable & consistant accepted nail location as best evidence of corner. Previous Strebs LCRC Lb. 2 pg. 422.

C. Description of monument for corner and accessories established to perpetuate locating the position of the corner:
 C-10 Set standard 3' pipe with brass plate in new mon. box in place of 1" x 14" iron pipe and is accepted as a careful and faithful perpetuation of the position of the original corner.
 Set nail w/tag in 12" ash S03°W 49.16'
 Set nail w/tag in power pole S63°E 88.03'
 Set nail w/tag in 22" ash N33°E 30.24'
 SW cor. white 1 story house N20°W 27.77'
 B-10 Set standard 32" pipe with brass plate in new mon. box in place of nail location. This position not established by original government surveyors. This monument is accepted as the best available evidence of the position of the corner.
 Set nail w/tag in 10" maple N08°W 35.20'
 Set nail w/tag in 12" maple N36°E 45.32'
 Set nail w/tag in 7" twin tulip S40°W 46.74'
 Set nail w/tag in post N64°W 67.54'
 Centerline road north 3.10'

Signed by *John G. Kamer*
 Surveyor's Michigan License No. 27449

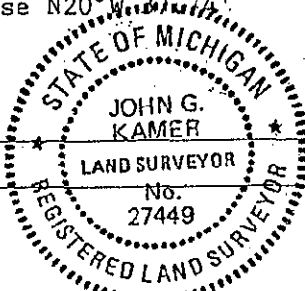

Date 12-20-94