

RATIFIED BY THE BERRIEN COUNTY SURVEY PEER GROUP AS THE OFFICIAL CORNER UNDER MICHIGAN PUBLIC ACT 345 OF 1990
John G. Kamer
 8-18-94
 For corners in

09/02/94 111#2445 A33
 CORNER \$9.00
 09/02/94 111#2445 A33
 STATE REMON FEE \$2.00

BERRIEN COUNTY REMONUMENTATION
 LAND CORNER RECORDATION CERTIFICATE
 Filing Requirement of Act 74, Mich. P.A. 1970

RECORDED
 SEP 2 4 21 PM '94
 REGISTER OF DEEDS
 BERRIEN COUNTY MICHIGAN
James J. Stasbury

Berrien (County)	Located In:	Corner Code #
1. Public Land Survey	T 6S R 18W	A-4
	T R	
	T R	
	T R	
2. Property Controlling in Section	S T R	
	S T R	
3. Miscellaneous Property in Sec.	S T R	
	S T R	
4. Lot No. _____, Recorded Plat _____		
5. Private Claims _____		

Register of Deeds Stamp & File Number

I, John G. Kamer, in a field survey on August 25, 19 94, do hereby certify that under requirements of P.A. 74, Michigan P.A. of 1970, the corner points mentioned in lines 1 and 2 above were in conformance with regulations and rules therefore as required in the current manual of survey instructions of the United States Department of the Interior, Bureau of Land Management or by a decree of a Court of Law and/or that the corner points mentioned in lines 3, 4 and 5 above were in conformance with the rules of the Michigan Board of Land Surveyors or by a Decree of a Court of Law; established, re-established, monumented, re-monumented, recovered, found as expressed below:

A	B	C	D	E	F	G	H	I	J	K	L	M
2	6	5	4	3	2	1						
3												
4	7	8	9	10	11	12						
5												
6	18	17	16	15	14	13						
7												
8	19	20	21	22	23	24						
9												
10	30	29	28	27	26	25						
11												
12	31	32	33	34	35	36						
13												

NOTE: Not more than 4 corners, all in the same town and range, may be recorded on this certificate.

A. Description of original monument and accessories and/or subsequent restoration:

See Back.
SURVEY & REMONUMENTATION
 NOV 07 1994
 COMMISSION

B. Description of corner evidence found and/or method applied in restoring or reestablishing corner:

Found 5/8" Iron Rod in Mon. box. The perpetuation of the corner as evidenced by this chain of witness ties appears reliable and accurate.

C. Description of monument for corner and accessories established to perpetuate locating the position of the corner:

A-4 Set standard 3' pipe w/brass plate in existing mon. box
 This position not established by original government surveyors. This monument is accepted as the best available evidence of the position of the corner.
 Removed 5/8" x 24" Iron Rod.
 Set 8 Penny nail w/tag in P. Pole S21°W 73.55'
 Set 8 Penny nail w/tag in Grape Pose N85°W 27.09'
 Set 8 Penny nail w/tag in Grape Pose S51°W 44.79'
 E 1/4 Corner 12-6-19 South 4.28'

Signed by *John G. Kamer*
 Surveyor's Michigan License No. 27449

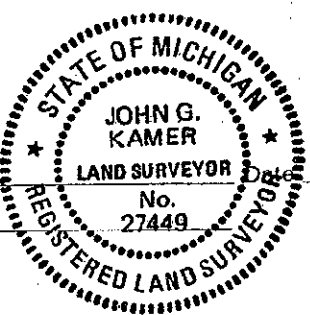

9-01-94

LIBER 3 PAGE 153

1948-1965

BCRC

July 18, 1972

E 1/4 Cor. 12-6-19 4.3' N.
Garrett (W & A) Lb. 933 pg. 103
E. 1/4 Cor. 12-6-19 4.3' N

June 5, 1973

Garett (W & A) L956 P322
3/4" Iron Rod in Mon Box
15" Apple S 65° E - 37.24'
End Grape Post S 65° W - 29.20'
End Grape Post N 65° W - 27.73'
East 1/4 Cor. 12-6-19 North - 4.28'

March 16, 1973

Alton W. Howard (SW Survey & Eng. Co.)
L 957 P 157
Mon Box
S. 45° E. 39.44 ft. nail south face 12" apple tree
S. 75° W. 31.20 ft. nail in north face of railroad tie
N. 85° W. 27.15 ft. nail in south face of railroad tie

1974

Dewey Notes
S. 45° E. 39.44' 12" Apple Tree
S. 75° W. 31.20' Nail North Face Railraod Tie
N. 85° W. 27.15' Nail in South Face R.R. Tie

Sept. 9, 1975

W & A
E 1/4 Cor. 12-6-19 4.28' N

Nov. 12, 1987

W & A
Mon. Box
E 1/4 Cor. 12-6-19 4.27' N

Oct. 9, 1991

Kamer
Find. 1" I.P. in Mon. Box
1" I.P. in Mon Box North 4.28'
Nail in R.R. Tie Post N 80° W 27.75'
Set P.K. in R.R. Tie Post S 75° W. 42.34'
Fnd. P.K. in P.P. S 30° W 69.60'

SURVEY &
REMONUMENTATION

NOV 07 1994

COMMISSION

LIBER

3 PAGE 154