

11/29/95  
 11/29/95

CDRAL#2012  
 111W2012  
 STATE FEE \$2.00

BERRIEN COUNTY REMONUMENTATION  
**LAND CORNER RECORDATION CERTIFICATE**  
 Filing Requirement of Act 74, Mich. P.A. 1970

RECORDED

For corners in

BERRIEN (County)	Located In:	Corner Code #
1. Public Land Survey	T <u>6S</u> R <u>18W</u>	<u>A-9</u>
	T _____ R _____	_____
	T _____ R _____	_____
	T _____ R _____	_____
2. Property Controlling in Section	S _____ T _____ R _____	_____
	S _____ T _____ R _____	_____
3. Miscellaneous Property in Sec.	S _____ T _____ R _____	_____
	S _____ T _____ R _____	_____

Nov 29 3 39 PM '95

*Bernice T. ...*  
 REGISTER OF DEEDS  
 BERRIEN COUNTY, MICHIGAN

Register of Deeds Stamp & File Number

4. Lot No. \_\_\_\_\_, Recorded Plat \_\_\_\_\_  
 5. Private Claims \_\_\_\_\_

	A	B	C	D	E	F	G	H	I	J	K	L	M
2	6		5		4		3		2		1		
3													
4	7		8		9		10		11		12		
5													
6	16		17		18		19		20		21		22
7													
8	19		20		21		22		23		24		
9													
10	30		29		28		27		26		25		
11													
12	31		32		33		34		35		36		
13													

I, JOHN G. KAMER, in a field survey on NOVEMBER 29, 1995, do hereby certify that under requirements of P.A. 74, Michigan P.A. of 1970, the corner points mentioned in lines 1 and 2 above were in conformance with regulations and rules therefore as required in the current manual of survey instructions of the United States Department of the Interior, Bureau of Land Management or by a decree of a Court of Law and/or that the corner points mentioned in lines 3, 4 and 5 above were in conformance with the rules of the Michigan Board of Land Surveyors or by a Decree of a Court of Law; established, re-established, monumented, re-monumented, recovered, found as expressed below:

**NOTE: Not more than 4 corners, all in the same town and range, may be recorded on this certificate.**

A. Description of original monument and accessories and/or subsequent restoration:  
 (SEE BACK.)

B. Description of corner evidence found and/or method applied in restoring or reestablishing corner:  
 FOUND CORNER OF (M-9) 6-19 4.62 FEET NORTH AND FOUND BROKEN CONCRETE POST 33.00 FEET WEST OF M-9 PER OLD NOTES - SPECIFICALLY 1959. NOTES AS SHOWN ON BACK PAGE. THE PERPETUATION OF THE CORNER AS EVIDENCED BY THE HISTORY OF WITNESS TIES PRIOR TO 1982 APPEAR RELIABLE AND ACCURATE.

C. Description of monument for corner and accessories established to perpetuate locating the position of the corner:  
 SET STANDARD 3' X 4" CONCRETE MONUMENT WITH BRASS PLATE 4.62 FEET SOUTH OF M-9.  
 SET NAIL W/TAG IN 7" HICKORY S 27° W 8.54'  
 SET NAIL W/TAG IN 5" WILD CHERRY N 48° W 21.00'  
 SET NAIL W/TAG IN 25" HICKORY NORTH 22.65'  
 SET NAIL W/TAG IN 15" TWIN HICKORY N 16° E 3.61'  
 CORNER IS ACCEPTED AS A CAREFUL AND FAITHFUL PERPETUATION OF THE POSITION OF THE ORIGINAL CORNER.

SURVEY &  
 REMONUMENTATION  
 MAR 27 1996  
 COMMISSION

Signed by *John G. Kamer*  
 Surveyor's Michigan License No. 27449

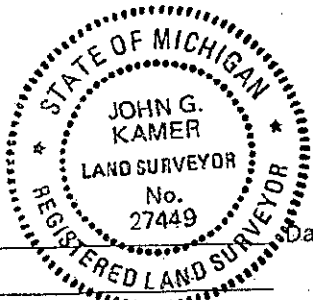

Date 11-29-95

Oronoko Township (T 6 S, R 18 W)  
SW Cor. Sec. 19 (A-9)

Feb. 13, 1830

Lucius Lyon, D.S.  
(From East) 78.07 W. Boundary 7 Lks. S. of Post  
W. Oak 10 S 58½ E 45  
W. Oak 16 N 10 W 90

Nov. 12, 13, 14, 1874

Silas Ireland Dep. Co. Surveyor  
Subdivision of Section 19  
Stone at SW Corner

Old Bearing W Oak 16 N. 10 E 75 New Bearing  
W. Oak N 58 E - 5.5  
Var. 3° 20' E Thence S 89° 39' E on True Line ¼ Post N &  
38.18 Chs. Put in Stone (This Corner was Lost)

The Above Silas Ireland Info was Recorded Feb. 22, 1876  
Thomas Love, County Surveyor

April 15, 1920

Notes @ W&A  
Big Post at Corner  
Survey in Sec. 30

Circa 1940±

J.H. Dewey Range Book  
Big Post on Corner, Jog N 7 for Sec Cor. to West

Circa 1959±

G.L. Wightman - Notes  
Corner Gone & Cor. 4.62' N Gone  
Used Conc. - Post 4.62' N & 33' W. & Irons S. & Mon. S  
1319.08 to Reestablish Location of Corners.

March 25, 1982

V.J. Strebs - Survey  
No Witnesses

Sept. 17, 1985

WRONG  
CORNER  
JOG  
4.62'S.

J.G. Kamer W&A  
N.W. Corner - Sec 30-6-18  
Fnd. 3' Steel Angle Iron  
PK in Fence Post West 2.5'  
PK in Twin 6" Hickory S 45° E 1.0'  
PK in Fence Post N 80° E 5.3'