

09/02/94

111#2445 A33
CORNER \$9.00
111#2445 A33
STATE RECORD FEE \$2.00

BERRIEN COUNTY REMONUMENTATION LAND CORNER RECORDATION CERTIFICATE
Filing Requirement of Act 74, Mich. P.A. 1970

Register of Deeds
 REGISTER OF DEEDS
 BERRIEN COUNTY MICHIGAN

SEP 2 4 21 PM '94

RECORDED

For corners in
Berrien
(County)

Located In: Corner Code #

1. Public Land Survey	T <u>6S</u> R <u>19W</u>	<u>H-10</u>
	T _____ R _____	_____
	T _____ R _____	_____
	T _____ R _____	_____
2. Property Controlling in Section	S _____ T _____ R _____	_____
	S _____ T _____ R _____	_____
3. Miscellaneous Property in Sec.	S _____ T _____ R _____	_____

Register of Deeds Stamp & File Number

4. Lot No. _____, Recorded Plat _____
5. Private Claims _____

	A	B	C	D	E	F	G	H	I	J	K	L	M
2	6	5	4	3	2	1							
3													
4	7	8	9	10	11	12							
5													
6	18	17	16	15	14	13							
7													
8	19	20	21	22	23	24							
9													
10	30	29	28	27	26	25							
11													
12	31	32	33	34	35	36							
13													

I, John G. Kamer, in a field survey on August 25, 19 94, do hereby certify that under requirements of P.A. 74, Michigan P.A. of 1970, the corner points mentioned in lines 1 and 2 above were in conformance with regulations and rules therefore as required in the current manual of survey instructions of the United States Department of the Interior, Bureau of Land Management or by a decree of a Court of Law and/or that the corner points mentioned in lines 3, 4 and 5 above were in conformance with the rules of the Michigan Board of Land Surveyors or by a Decree of a Court of Law; established, re-established, monumented, re-monumented, recovered, found as expressed below:

NOTE: Not more than 4 corners, all in the same town and range, may be recorded on this certificate.

A. Description of original monument and accessories and/or subsequent restoration:
(See Back)

B. Description of corner evidence found and/or method applied in restoring or reestablishing corner:
Found plug in mon. box - distances to adjacent corners were reasonable and consistent.
The perpetuation of the corner as evidenced by the history of witness ties appears reliable and accurate.

SURVEY & REMONUMENTATION

NOV 07 1994

COMMISSION

C. Description of monument for corner and accessories established to perpetuate locating the position of the corner:
H-10
Removed found plug.
Set 2' pipe w/brass plate in existing mon box.
This position not established by original government surveyors. This monument is accepted as the best available evidence of the position of the corner.
Set 8 penny nail w/tag in p. pole S63°E 70.99'
Set 8 penny nail w/tag in p. pole N69°E 66.86'
Set 8 penny nail w/tag in wood post N33°E 25.46'
NE corner of conc headwall S65°W 35.34'

Signed by John G. Kamer
Surveyor's Michigan License No. 27449

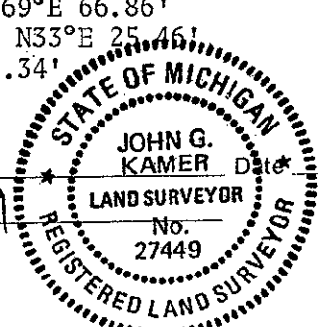

9-01-94

1945
BCRC '48, '54, '60, '65

J.H. Dewey & B.C.R.C. (Fnd. Stone)
Cor. School NE 89
2" Pear SE 43.5'
4" Elm NE 68.5
10" Walnut N 92.0
(Dist. E to 1/8 Cor. 1329.87 Dewey, 1328.8 BCRC)
(Dist. S to 1/8 Cor. 1325.1 Dewey)

Aug. 17, 1960

W&A notes
Fnd I.P.

Oct. 14, 1968

GL Wightman
Fnd Plug
(Dist. Cen. 27-6-19 to
Cen. 34-6-19 5296.4')

Oct. 14, 1969

Wightman
(Dist. to S 1/4 post 2650.2
Dist. S. to 1/8 line 1313.27')

Jan. 23, 1970

Wightman
(Dist. E. to 1/8 line 1329.87')
(Dist. S. to 1/8 line 1325.1')

March 15, 1976

Robert J. Beland
Iron - Center Sec. 27
Cor. Hdw. S.W. 28.32'
Cor. Hdw. N.W. 29.7'
Walnut N. 92.0'
Elm N. 42° E. 68.5'
Tel. Pole N. 47°E 38.7'

1980 SURVEY &
REMONUMENTATION

NOV 07 1994

COMMISSION

BCRC
Fnd Mon Box
Flag Pole N 3° E 33.0'
P.P. N 60° E 66.6'
NE Cor. HDWL S 60° W 35.3'
NW Cor. HDWL S 60° E 31.8'
[Dist. E. to 1/8 Cor. (Mon Box) 1328.8']

May 6, 1982

John G. Kamer (W & A)
Witness:
Center of Section
Mon. Box (Plug)
Buried Cable Riser N 20° E 26.75'
PK in PP N 40° E 66.88'
PK in PP S 60° E 71.00'

July 8, 1992

John G. Kamer (W & A)
Occupied Cen. Sec. 27-6-19
(Fnd. Plug in Mon. Box)
Buried Cable Riser N 20° E 26.75'
NE Cor. Conc. Headwall S 60° W 35.36'
NW Cor. Conc. Headwall S 60° E 31.74'
Found P.K. in P.P. N 70° E 66.91'
Dist. to S 1/4 Cor. 2648.81