

09/02/94

111W2445

13

09/02/94

REGISTER

1.00

111W2445

A33

STATE REMON FEE \$2.00

RATIFIED BY THE BERRIEN COUNTY SURVEY PEER GROUP AS THE OFFICIAL CORNER UNDER MICHIGAN PUBLIC ACT 345 OF 1990

BERRIEN COUNTY REMONUMENTATION LAND CORNER RECORDATION CERTIFICATE Filing Requirement of Act 74, Mich. P.A. 1970

REGISTER OF DEEDS BERRIEN COUNTY MICHIGAN

SEP 2 4 21 PM '94

RECORDED

Form with fields for Berrien (County), Located In: T 6S R 19W, Corner Code # M-2, and numbered sections 1-5 for survey details.

Register of Deeds Stamp & File Number

Grid table with columns A-M and rows 2-13, containing numbers 1-36.

I, John G. Kamer, in a field survey on August 26, 19 94, do hereby certify that under requirements of P.A. 74, Michigan P.A. of 1970, the corner points mentioned in lines 1 and 2 above were in conformance with regulations and rules therefore as required in the current manual of survey instructions of the United States Department of the Interior, Bureau of Land Management or by a decree of a Court of Law and/or that the corner points mentioned in lines 3, 4 and 5 above were in conformance with the rules of the Michigan Board of Land Surveyors or by a Decree of a Court of Law; established, re-established, monumented, re-monumented, recovered, found as expressed below:

NOTE: Not more than 4 corners, all in the same town and range, may be recorded on this certificate.

A. Description of original monument and accessories and/or subsequent restoration: (See Back)

SURVEY & REMONUMENTATION

NOV 07 1994

COMMISSION

B. Description of corner evidence found and/or method applied in restoring or reestablishing corner: Found R.R. spike.

Measure distance from established common twp. cor. at NE cor. Sec 1, to existing box at SW cor. Sec. 6, 5024.99 - 8.58 jog to SE sec. 1 = 5016.41' (govt. 76.62 = 5056.92). Based on occupation and old notes it appears government surveyors dropped 1/2 chain in the N Fr 1/2 of sec. 1 (5056.92 - 33 + 5024.99'). By proration distances match existing spike at E 1/4 of 1 and calculated 1/2 jog for Sec. 6 matches existing spike. Both spikes date back to surveys 1973 +/- This also agrees with old ditchline occupation believed to date back 75 - 100 years +/- An old culvert crossing the road at the 1/4 corners must have removed them many years ago.

C. Description of monument for corner and accessories established to perpetuate locating the position of the corner: M-2

Removed RR spike. Set standard 3 x 1 pipe w/brass plate in set mon box. Corner is accepted as a careful and faithful reestablishment of the position of the original corner. Set 8 penny nail w/tag in p. pole S23°W 97.45' Set 8 penny nail w/tag in 2 1/2" Maple S78°W 85.03' Set 8 penny nail w/tag in p. pole S86°W 98.80' W 1/4 corner 6-6-18 South 4.09'

Signed by [Signature] JOHN G. KAMER LAND SURVEYOR No. 27449

9-01-94

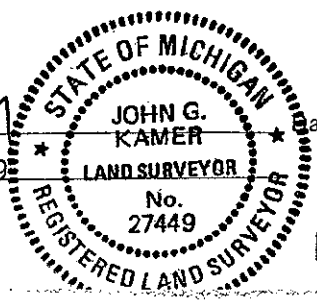

1829

Lucius Lyon
40.00 Set Half Mile Post
Willow 7 N 32 1/2 W 1.95
No other timber near

March 7, 1894

Old notes at W & A
Found Post Set in Ditch

1945

J.H. Dewey
6" Oaks S 10° E, 34
Cor. Post N.W. 21.7
Twin Elm N 88 W 66

April 2, 1973

W & A
E 1/4 Cor. Gone

October 20, 1967

W & A Notes Found Corner

1978

W & A
Fnd R.R. Spike
10" Maple S 60° W 50.58'
Centerline Rd. West 3.70
PK in PP S 35° W 97.54
W 1/2 6-6-18 South 4.08 (R.R. Spike)