

RATIFIED BY THE BERRIEN COUNTY SURVEY PEER GROUP AS THE OFFICIAL CORNER UNDER MICHIGAN PUBLIC ACT 345 OF 1990

BERRIEN COUNTY REMONUMENTATION LAND CORNER RECORDATION CERTIFICATE Filing Requirement of Act 74, Mich. P.A. 1970

97 NOV 17 PM 2:05 BERNICE TRETHERWAY REGISTER OF DEEDS BERRIEN COUNTY, MICHIGAN

RECORDED

For corners in Berrien County Located in: Corner Code #

- 1. Public Land Survey T 7S R 18W I-13 T 8S R 18W I-11(common)
2. Property Controlling in Section S T R
3. Miscellaneous Property in Sec. S T R
4. Lot No Recorded Plat
5. Private Claims

Table with 3 columns: Date (11/17/97), File Number (111#3739), and Fee (\$9.00, \$9.00, \$2.00). Includes 'Register of Deeds Stamp & File Number'.

I, Alan Bartlett in a field survey on November 7 1997 hereby certify that under requirements of P.A. 74, Michigan P.A. of 1970, the corner points mentioned in lines 1 and 2 above were in conformance with regulations and rules...

Grid table with columns A-M and rows 2-13. Contains numbers 1-36 in a grid pattern.

NOTE: Not more than 4 corners, all in the same town and range, may be recorded on this certificate.

SURVEY & REMONUMENTATION MAR 06 1998 SECTION

A. Description of original monument and accessories and/or subsequent restoration:

(PLEASE SEE BACK OF PAGE)

B. Description of corner evidence found and/or method applied in restoring or reestablishing corner:

- (1) Found State Cap in Monument Box @ Center Line of E/W Road. Verified corner location using existing witnesses.
(2) Historical usage, documentation, and evidence of corner location reviewed and ratified by the BCRP Peer Group October 23rd 1997.

C. Description of monument for corner and accessories established to perpetuate locating the position of the corner:

Found Brass State Cap in Monument Box. Replaced existing Cap and 1"x15" Pipe with Berrien County Remonumentation Cap (stamped 1997, 35988) on 1" x 36" Pipe. Excavated down 1.5' and Found 1 1/2" x 18" Pinch Pipe, Excavated down 2.2' and found Pointed Stone in Center of Monument Box.

Witnesses

- Set Nail in Mail Box Post N70°E 77.83'
Found PK Nail in SW Face of P.Pole S50°E 57.29'
NW House Foundation Corner S30°E 110.75'
Found PK Nail in S Face of P.Pole N65°W 74.80'
SE House Foundation Corner N45°W 101.23'

Corner is accepted as a careful and faithful perpetuation of the position of the original corner.

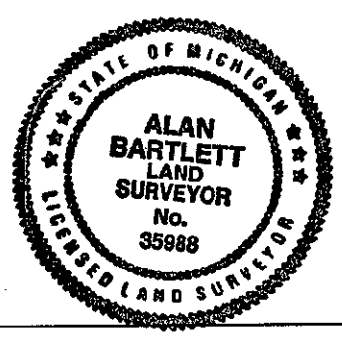

Signed by Alan K. Bartlett Date 11/13/97 Surveyor's Michigan License No. 35988

I-13 T7S,R18W
I-1 T8S,R18W(common)

GLO Robert Clark Jr. November 15 1835
80.00 Set Post Corner to Section 34 & 35

Witnesses
Red Oak 18" N67 1/2°W 38 lks
Red Oak 18" S29°W 97 lks

Berrien County Road Commission (no dates)
Stone

Witnesses
NW 111.3' House Corner
SW 44.6' Electric Pole
N 33.9' Fence Post
N60°E 54.6' 18" Locust
N75°W 75.0' P.Pole
N45°E 55.6' 36" Locust
S50°E 57.6' P.Pole

Wightman: John Kamer RLS# 27449 recorded survey 1/24/84 Liber 1198, Page 280
Found 1/2" Iron in Monument Box

Witnesses
Iron Pipe North 33.00'
Iron Rod S5°E 33.15'
Power Pole S45°W 74.75'

Landmark Tech: Alan Bartlett RLS# 35988
Found State of Michigan Brass Cap in Monument Box @ Centerline of E/W Road

Witnesses
Found Iron S5°E bent over
Set Nail in Mail Box Post N70°E 77.83'
Found PK Nail in SW face of P. Pole S50°E 57.29'
NW House Foundation Corner S30°E 110.75'
Found Pk Nail in S.Face of Power Pole N65°W 74.80'
SE House Foundation Corner N45°W 101.23'

SURVEY &
REMONUMENTATION

MAR 06 1998

SECTION