

RATIFIED BY THE BERRIEN COUNTY SURVEY PEER GROUP AS THE OFFICIAL CORNER UNDER MICHIGAN PUBLIC ACT 345 OF 1990

RECORDED

RE RECORDED TO CORRECT TOWNSHIP BERRIEN COUNTY REMONUMENTATION LAND CORNER RECORDATION CERTIFICATE Filing Requirement of Act 74, Mich. P.A. 1970

97 OCT 31 PM 2:04

BERNICE TRETHERWAY REGISTER OF DEEDS BERRIEN COUNTY, MICHIGAN

For corners in BERRIEN (County)

Located In: Corner Code #

- 1. Public Land Survey T 6 R 19 H-13
Common to: T75, R19W, H-1
T R
T R
T R
T R
- 2. Property Controlling S T R
in Section S T R
- 3. Miscellaneous S T R
Property in Sec. S T R
- 4. Lot No. _____, Recorded Plat _____
- 5. Private Claims _____

SURVEY & REMONUMENTATION

MAR 06 1998

SECTION Register of Deeds Stamp & File Number

I, CHARLES W. BARGER, in a field survey on OCTOBER, 19 97, do hereby certify that under requirements of P.A. 74, Michigan P.A. of 1970, the corner points mentioned in lines 1 and 2 above were in conformance with regulations and rules therefore as required in the current manual of survey instructions of the United States Department of the Interior, Bureau of Land Management or by a decree of a Court of Law and/or that the corner points mentioned in lines 3, 4 and 5 above were in conformance with the rules of the Michigan Board of Land Surveyors or by a Decree of a Court of Law; established, re-established, monumented, re-monumented, recovered, found as expressed below:

A	B	C	D	E	F	G	H	I	J	K	L	M
2	6	5	4	3	2	1						
3												
4	7	8	9	10	11	12						
5												
6	18	17	16	15	14	13						
7												
8	19	20	21	22	23	24						
9												
10	30	29	28	27	26	25						
11												
12	31	32	33	34	35	36						
13												

NOTE: Not more than 4 corners, all in the same town and range, may be recorded on this certificate.

A. Description of original monument and accessories and/or subsequent restoration:

L. LYON SET POST
1830 MAPLE 12 N68W 39
ALDER 4 N14E 13

01/02/98 111#7267 A99
CORNER \$9.00
01/02/98 111#7267 A99
STATE REMON FEE \$2.00

B. Description of corner evidence found and/or method applied in restoring or reestablishing corner:

C. BARGER FOUND 1" BAR
AUG 1997 P.K. IN W SIDE 48" POPULAR S10DEGW 34.41'
P.K. IN PP N40DEG54'E 44.0'
P.K. IN PP N30DEG30'W 41.95'
P.K. IN PP S8DEG25'E 28.65'

98 JAN -2 PM 3:00

BERNICE TRETHERWAY REGISTER OF DEEDS BERRIEN COUNTY, MICHIGAN

C. Description of monument for corner and accessories established to perpetuate locating the position of the corner:

H-13 1" PIPE 36" LONG WITH 2 1/2" REMONUMENTATION BRASS CAP IN MONUMENT BOX
WITNESS TAG IN W SIDE 48" POPULAR S10DEGW 34.41'
WITNESS TAG IN PP N40DEG54'E 44.0'
WITNESS TAG IN PP N30DEG30'W 41.95'
WITNESS TAG IN PP S8DEG25'E 28.65'

AND IS ACCEPTED AS A CAREFUL AND FAITHFUL PERPETUATION OF THE POSITION OF THE ORIGINAL CORNER.

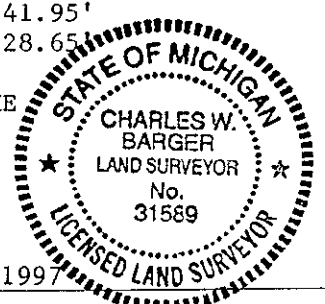

Signed by Charles W. Barger Date OCTOBER 31, 1997
Surveyor's Michigan License No. 31589

BARGER ENGINEERING, INC.
BERRIEN COUNTY REMONUMENTATION

NORTH QUARTER CORNER SECTION 3, TOWNSHIP 6 SOUTH, RANGE 19 WEST
(H-13)

LONDON ROAD & BROWNTOWN ROAD

L. Lyon 1830	Set Post Maple 12 N68w 39 Alder 4 N14E 13
Berrien County Road Commission 1940-1959	No Record
Strebs ?	Survey A4461 Shows Existing Corner
R. Garrett July 1972	Iron Pipe PP N40degW 41.7' Guy Pole N45degE 43.5' 24" Elm S 33.7'
C. Barger Aug 1997	1" Bar P.K. in W. Side 48" Popular S10degW 34.41' P.K. in PP N40deg54'E 44.0' P.K. in PP N30deg30'W 41.95' P.K. in PP S8deg25'E 28.65'

SURVEY &
REMONUMENTATION

MAR 06 1998

SECTION

JOB ASSIGNMENT 1997-02-0300

LIBER 4 PAGE 18

LIBER 4 PAGE 59