

RAITIFIED BY THE BERRIEN COUNTY
SURVEY PEER GROUP AS THE
OFFICIAL CORNER UNDER MICHIGAN
PUBLIC ACT 345 OF 1990

09/25/96

111#3578
CORNER

\$9.00

09/25/96

111#3578
STATE REMON FEE

A33

\$2.00

**BERRIEN COUNTY REMONUMENTATION
LAND CORNER RECORDATION CERTIFICATE**
Filing Requirement of Act 74, Mich. P.A. 1970

SEP 25 11 32 AM '96

John G. Kamer
6-20-96
For corners in

Berrien
(County)

Located In:

Corner Code #

- | | | |
|--|--------------------------|-----|
| 1. Public Land Survey
Common to: T7S, R20W, M-5 | T <u>7S</u> R <u>19W</u> | A-5 |
| | T ___ R ___ | M-5 |
| | T ___ R ___ | |
| | T ___ R ___ | |
| 2. Property Controlling
in Section | S ___ T ___ R ___ | |
| | S ___ T ___ R ___ | |
| 3. Miscellaneous
Property in Sec. | S ___ T ___ R ___ | |
| | S ___ T ___ R ___ | |

Berrien County
BERRIEN COUNTY
REGISTER OF DEEDS

Register of Deeds Stamp & File Number

4. Lot No. _____, Recorded Plat _____
5. Private Claims _____

I, John G. Kamer, in a field survey on June 25, 1996 do hereby state that under requirements of P.A. 74, Michigan P.A. of 1970, the corner points mentioned in lines 1 and 2 above were in conformance with regulations and rules therefore as required in the current manual of survey instructions of the United States Department of the Interior, Bureau of Land Management or by a decree of a Court of Law and /or that the corner points mentioned in lines 3, 4 and 5 above were in conformance with the rules of the Michigan Board of Land Surveyors or by a Decree of a Court of Law; established, re-established, monumented, recovered, found as expressed below:

NOTE: Not more than 2 corners, all in the same town and range, may be recorded on this certificate.

	A	B	C	D	E	F	G	H	I	J	K	L	M
1													
2	6		5		4		3		2		1		
3													
4	7		8		9		10		11		12		
5													
6	18		17		16		15		14		13		
7													
8	19		20		21		22		23		24		
9													
10	30		29		28		27		26		25		
11													
12	31		32		33		34		35		36		
13													

A. Description of original monument and accessories and/or subsequent restoration:

(See back)

SURVEY &
REMONUMENTATION

DEC 16 1996

COMMISSION

B. Description of corner evidence found and/or method applied in restoring or reestablishing corner:

- Found and Removed large stone with point from monument box.
- Occupation to north looked good.
- Also old broken dishes found around and under stone.

C. Description of monument for corner and accessories established to perpetuate locating the position of the corner:

- Removed 30" x 1" rod and also a stone w/point from monument box
- Set standard 3' x 1" iron pipe with brass plate in monument box.
- Set nail w/tag in power pole N 28° W 34.74'
- Set nail w/tag in 15" pine N 38° E 33.27'
- Set nail w/tag in wood post south 36.37'
- Set nail w/tag in 7" ash S 22° E 43.64'

Corner is accepted as a careful and faithful perpetuation of the position of the original corner.

Signed by *John G. Kamer*
Surveyor's Michigan License No. 27449

Date 9-24-96

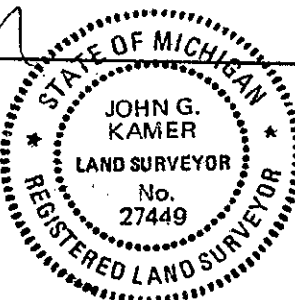

FORM APPROVED BY MICHIGAN STATE BOARD OF PROFESSIONAL SURVEYORS, JAN 28, 1971
REVISED MAY 14, 1975
REVISED JAN, 1983
REVISED OCT, 1995

LIBER

3 PAGE 358

SW Corner 7-7-19 A-5
Common with SE Corner 12-7-20 M-5
June 20, 1996

- 1830 Lucius Lyon D.S.
North on East Boundary of Sec. 13 T 7 S R 20 W
80.00 Set post corner to Sec. 12 & 13
Beech 18 S13 W30
Do 15 N 20W 30
also
West between Sec's 7 & 18
76.47 West Boundary at Post
- 1930± Dewey
SE Cor. 16-7-20 (Also SW Cor. 7-7-19)
Stone
End Fence N5W 21.9
24" Apple NW 54.3
36" Maple S80°W 12.6 (126)
20" Apple SW 61
- 1948 Laukus (G.L. Wightman)
SE Cor. 12-7-20
Iron
Meas. 1319W & 1319W

Wightman Notes
NE Cor. 13-7-20
Stone
Meas. 1319W & 1319W
- 1957 Wightman Notes
SE Cor. 12-7-20
Stone
Meas. 1318W
- 1971 BCRC
Stone (1971)
14" Pine N20°E 44.92
P.P. N30°W 34.60'
6" Elm S45°W 46.8
Fence Post S20°E 29.0
Iron North 33.?
Iron South 32.5'
8" Pine N30°E 33.?
Tel Junction Box Post 41.?
- 1972 Wightman (Garrett)
Found Stone
14" Pine N 20°E 44.92'
1.P. North 32.90'
1.P. South 32.84'
- 1988 Kamer, Wightman and Associates, Inc.
3/4" Pin in mon. box
PK in PP N10°W 34.81'
PK in 12" Pine N15°E 33.91'
PK in 8" Maple S10°W 42.44'
Centerline road south 4'

HHHMMNTARAKAMBRVJNDNTS