

RATIFIED BY THE BERRIEN COUNTY SURVEY PEER GROUP AS THE OFFICIAL CORNER UNDER MICHIGAN PUBLIC ACT 345 OF 1990

RECORDED

BERRIEN COUNTY REMONUMENTATION

LAND CORNER RECORDATION CERTIFICATE
Filing Requirement of Act 74, Mich. P.A. 1970

DEC 13 10:50 AM '95

For corners in BERRIEN
(County)

Located In:	Corner Code #
T <u>8</u> S R <u>18</u> W	<u>E-9</u>
T _____ R _____	_____
T _____ R _____	_____
T _____ R _____	_____
T _____ R _____	_____
S _____ T _____ R _____	_____
S _____ T _____ R _____	_____
S _____ T _____ R _____	_____
S _____ T _____ R _____	_____

Bernice Thompson
REGISTER OF DEEDS
BERRIEN COUNTY MICHIGAN

Register of Deeds Stamp & File Number

- 1: Public Land Survey
- 2: Property Controlling in Section
- 3: Miscellaneous Property in Sec.
- 4: Lot No. _____, Recorded Plat _____
- 5: Private Claims _____

	A	B	C	D	E	F	G	H	I	J	K	L	M
2	6	5	4	3	2	1							
3													
4	7	6	9	10	11	12							
5													
6	18	17	16	15	14	13							
7													
8	19	20	21	22	23	24							
9													
10	30	29	28	27	26	25							
11													
12	31	32	33	34	35	36							
13													

I, Robert W. Prestine, in a field survey on November 24, 19 95, do hereby certify that under requirements of P.A. 74, Michigan P.A. of 1970, the corner points mentioned in lines 1 and 2 above were in conformance with regulations and rules therefore as required in the current manual of survey instructions of the United States Department of the Interior, Bureau of Land Management or by a decree of a Court of Law and/or that the corner points mentioned in lines 3, 4 and 5 above were in conformance with the rules of the Michigan Board of Land Surveyors or by a Decree of a Court of Law; established, re-established, monumented, re-monumented, recovered, found as expressed below:

NOTE: Not more than 4 corners, all in the same town and range, may be recorded on this certificate.

A. Description of original monument and accessories and/or subsequent restoration:

B-9 South Quarter Corner Section 19 T. 8 S., R. 18 W. 12/13/95 111#2978 A66
 This corner not set by Govt. CORNER \$7.00
 Unable to find corner or record of corner ever set by others. 12/13/95 111#2978 A66
 STATE REMON FEE \$2.00

B. Description of corner evidence found and/or method applied in restoring or reestablishing corner:

B-9
 Did not find corner, set in line with W.P.A. monuments on State Line as set for Indiana State Line in Section 8, T. 38 N., R. 1 E. (1938) and in line with occupation to North, set half way between SW & SE corners of Section 19.

MAR 27 1996

COMMISSION

C. Description of monument for corner and accessories established to perpetuate locating the position of the corner:

B-9
 Set 4" round Berrien County Remonumentation monument
 Nail & tag in 48" Walnut N 3° E 28.85'
 Nail & tag in 20" Oak West 49.00'
 Nail & tag in 14" Walnut N 45° E 2.80'
 Nail & tag in 26" Oak S 70° E 9.83'

This position is accepted as a careful and faithful reestablishment of the position of the original corner.

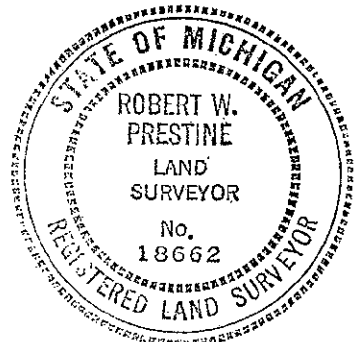

Signed by Robert W. Prestine Date December 11, 1995
 Surveyor's Michigan License No. 18662