

RATIFIED BY THE BERRIEN COUNTY SURVEY PEER GROUP AS THE OFFICIAL CORNER UNDER MICHIGAN PUBLIC ACT 345 OF 1990

09/02/94

111#2445

A33

CORNER

\$7.00

09/02/94

111#2445

A33

STATE REMON FEE \$2.00

BERRIEN COUNTY REMONUMENTATION LAND CORNER RECORDATION CERTIFICATE

Filing Requirement of Act 74, Mich. P.A. 1970

Warren S. [Signature]
4-29-94

BERRIEN COUNTY REGISTER OF DEEDS

SEP 2 4 21 PM '94

RECORDED

Berrien (County)	Located In:	Corner Code #
1. Public Land Survey	T <u>8S</u> R <u>20W</u>	<u>C-5</u>
	T _____ R _____	_____
	T _____ R _____	_____
	T _____ R _____	_____
2. Property Controlling in Section	S _____ T _____ R _____	_____
	S _____ T _____ R _____	_____
3. Miscellaneous Property in Sec.	S _____ T _____ R _____	_____
	S _____ T _____ R _____	_____

Register of Deeds Stamp & File Number

4. Lot No. _____, Recorded Plat _____
5. Private Claims _____

I, John G. Kamer, in a field survey on August 19, 19 94, do hereby certify that under requirements of P.A. 74, Michigan P.A. of 1970, the corner points mentioned in lines 1 and 2 above were in conformance with regulations and rules therefore as required in the current manual of survey instructions of the United States Department of the Interior, Bureau of Land Management or by a decree of a Court of Law and/or that the corner points mentioned in lines 3, 4 and 5 above were in conformance with the rules of the Michigan Board of Land Surveyors or by a Decree of a Court of Law; established, re-established, monumented, re-monumented, recovered, found as expressed below:

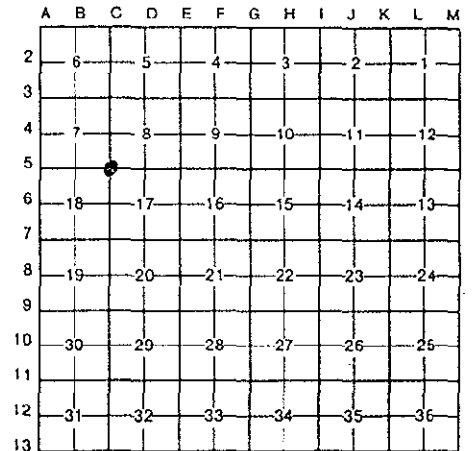

NOTE: Not more than 4 corners, all in the same town and range, may be recorded on this certificate.

A. Description of original monument and accessories and/or subsequent restoration:

1830	Lucius Lyon	Aug 29, 1991	V.J. Strebs - W&A
	80.00 Set Post Com. to Secs 7-8-17 & 18.	Oct. 29, 1991	Northeast Corner
	Elm 17 S 61 W 20		Section 18-8-20
	Walnut 40 S 6 W 39		(Fnd. 1" Pinched Pipe)
Dec. 1948 to Jan. 1960	BCRC		P.K. Nail in top of guard
	Stone		post on Bridge-N10°E-61.10'
	E. Side of Rd. 60' S of Bridge		P.K. Nail in 20" Tree-N80°W-32.00'
			P.K. Nail in 8" Tree-S80°E-21.20'
			P.K. Nail in 8" Tree-N80°E-28.03'

B. Description of corner evidence found and/or method applied in restoring or reestablishing corner:

Found 1" pinched pipe and 1948 to 1960, and 1991 witness ties as shown above.

SURVEY & REMONUMENTATION

NOV 07 1994

COMMISSION

C. Description of monument for corner and accessories established to perpetuate locating the position of the corner:

C-5 Set standard 3' pipe w/brass plate in new mon, box in gravel road in place of 1" pinched IP 12" long
Corner is accepted as a careful and faithful perpetuation of the original corner.
Set Nail w/tag in 19" Cottonwood N89°W 31.45'
Set Nail w/tag in 6" Sycamore S80°E 21.19'
Set Nail w/tag in 9" Sycamore N60°W 28.31'
Set Nail w/tag in top of guard post east side of bridge N 07° E 61.07'

Signed by *[Signature]*
Surveyor's Michigan License No. 27449

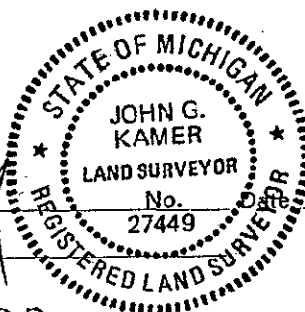

9-01-94