

**SURVEY &
REMONUMENTATION**

MAR 13 1998

**BRANCH COUNTY REMONUMENTATION CORNER
LAND CORNER RECORDATION CERTIFICATE
Filing Requirement of Act 74, Mich. P.A. 1970**

For corners in **SECTION**

<u>BRANCH</u>	Located In:	Corner Code #
(County)		
GIRARD TWP.		
1. Public Land Survey	T <u>5</u> S R <u>6</u> W	<u>E-3</u>
	T <u> </u> R <u> </u>	<u> </u>
	T <u> </u> R <u> </u>	<u> </u>
	T <u> </u> R <u> </u>	<u> </u>
2. Property Controlling in Section	S <u> </u> T <u> </u> R <u> </u>	<u> </u>
	S <u> </u> T <u> </u> R <u> </u>	<u> </u>
3. Miscellaneous Property in Sec.	S <u> </u> T <u> </u> R <u> </u>	<u> </u>
	S <u> </u> T <u> </u> R <u> </u>	<u> </u>

STATE OF MICHIGAN
Branch County
Recorded

12-30-1997 10:05:23

Linda Lee Morrison-Mathews
REGISTER OF DEEDS

Liber **00003** Page **0192**

Register of Deeds Stamp & File Number

4. Lot No. _____, Recorded Plat _____
5. Private Claims _____

I, EDWARD W. REED, in a field survey on OCTOBER 8, 1997 do hereby state that under requirements of P.A. 74, Michigan P.A. of 1970, the corner points mentioned in lines 1 and 2 above were in conformance with regulations and rules therefore as required in the current manual of survey instructions of the United States Department of the Interior, Bureau of Land Management or by a decree of a Court of Law and /or that the corner points mentioned in lines 3, 4 and 5 above were in conformance with the rules of the Michigan Board of Land Surveyors or by a Decree of a Court of Law; established, re-established, monumented, recovered, found as expressed below:

NOTE: Not more than 2 corners, all in the same town and range, may be recorded on this certificate.

A	B	C	D	E	F	G	H	I	J	K	L	M
1												
2	6		5		4		3		2		1	
3				●								
4	7		8		9		10		11		12	
5												
6	18		17		16		15		14		13	
7												
8	19		20		21		22		23		24	
9												
10	30		29		28		27		26		25	
11												
12	31		32		33		34		35		36	
13												

A. Description of original monument and accessories and/or subsequent restoration:
CORNER COMMON TO SECTIONS 4-5-8-9

- 1825: R. CLARK jr. D.S. - CORNER SET
- 1892: I.D. MINER, SURVEYOR - FOUND STAKE
- 1938: R.V. TERRILL, SURVEYOR - DUG FOR CORNER, COULD NOT FIND
- 1963: E.R. REED, CO. SURVEYOR, DUG LONG TRENCH, FOUND OLD ROTTEN REMAINS OF WOOD STAKE & TILE PIECES IN LINE WITH FENCE RUNNING EAST AND IN C/L OF ROAD, SET 1" SQUARE IRON WITH BROKEN TILE

B. Description of corner evidence found and/or method applied in restoring or reestablishing corner:

FOUND OLD 1" SQUARE SHAPED IRON WITH BROKEN TILE AROUND.
DROVE 1" IRON DOWN AND SET 1/2" X 18" REBAR IRON OVER TOP WITH REMON CAP IN CI-MONUMENT BOX 4" BELOW GRAVEL ROAD GRADE

C. Description of monument for corner and accessories established to perpetuate locating the position of the corner:

- FACE OF SQUARE CONC. ANCHOR POST, EAST 32.2'
- NAIL & WASHER IN 8" ASH, N36E 43.25'
- NAIL & WASHER IN 44" OAK, N45W 45.51'
- ROUND FENCE CORNER POST, S56W 44.6' TO FACE
- TEL PED, N50W 52.1' TO FACE

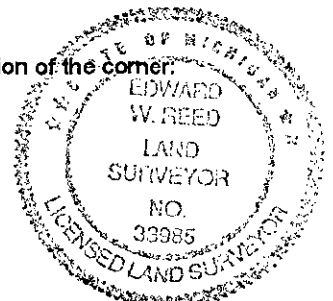

AND IS ACCEPTED AS A CAREFUL AND FAITHFUL PERPETUATION OF THE POSITION OF THE ORIGINAL CORNER

Signed by Edward W. Reed Date OCTOBER 8, 1997
EDWARD W. REED

Surveyor's Michigan License No. 33985

ACCEPTED BY THE BRANCH COUNTY SURVEY PEER GROUP AS THE OFFICIAL CORNER UNDER MICHIGAN PUBLIC ACT 345 OF 1890 AT A MEETING HELD ON 12-08-97

FORM APPROVED BY MICHIGAN STATE BOARD OF PROFESSIONAL SURVEYORS, JAN. 28
REVISED MAY 14, 1975

REVISED JAN, 198
REVISED OCT., 199

E.R. Reed
E.R. REED