

SURVEY & REMONUMENTATION

APR 26 1995

ACCEPTED BY THE BRANCH COUNTY SURVEY PEER GROUP AS THE OFFICIAL CORNER UNDER MICHIGAN PUBLIC ACT 345 OF 1999 AT A MEETING HELD ON 12-16-94

BRANCH COUNTY REMONUMENTATION CORNER
LAND CORNER RECORDATION CERTIFICATE
Filing Requirement of Act 74, Mich. P.A. 1970

E. Reed C. Rep.

For corners in

Branch (County)	Located In:	Corner Code =/≠
1. Public Land Survey	T <u>5</u> S R <u>7</u> W	<u>L-3</u>
	T _____ R _____	_____
	T _____ R _____	_____
	T _____ R _____	_____
2. Property Controlling in Section	S _____ T _____ R _____	_____
	S _____ T _____ R _____	_____
3. Miscellaneous Property in Sec.	S _____ T _____ R _____	_____
	S _____ T _____ R _____	_____

STATE OF MICHIGAN
Branch County
Recorded

12-28-1994 15:02:46

Linda Lee Morrison-Mathews
REGISTER OF DEEDS

Register of Deeds Stamp & File Number

4. Lot No. _____, Recorded Plat _____
5. Private Claims _____

	A	B	C	D	E	F	G	H	I	J	K	L	M
2	6	5	4	3	2	1							
3													
4	7	8	9	10	11	12							
5													
6	16	17	16	15	14	13							
7													
8	19	20	21	22	23	24							
9													
10	30	29	28	27	26	25							
11													
12	31	32	33	34	35	36							
13													

I, Edward W. Reed, in a field survey on December 8, 19 94, do hereby certify that under requirements of P.A. 74, Michigan P.A. of 1970, the corner points mentioned in lines 1 and 2 above were in conformance with regulations and rules therefore as required in the current manual of survey instructions of the United States Department of the Interior, Bureau of Land Management or by a decree of a Court of Law and/or that the corner points mentioned in lines 3, 4 and 5 above were in conformance with the rules of the Michigan Board of Land Surveyors or by a Decree of a Court of Law; established, re-established, monumented, re-monumented, recovered, found as expressed below:

NOTE: Not more than 4 corners, all in the same town and range, may be recorded on this certificate.

A. Description of original monument and accessories and/or subsequent restoration:

Quarter corner common to Sections 1 and 2, Town 5 South, Range 7 West, Union Township, Branch County, Michigan.

- 1825: GLO notes, corner not set
- 1873: Ricker, stake and stones found

B. Description of corner evidence found and/or method applied in restoring or reestablishing corner:

Proportioned actual and GLO distances. Dug and found nothing.
Set 1/2" x 18" rebar
Set cast iron monument box with remonumentation cap on line and midway between corners

C. Description of monument for corner and accessories established to perpetuate locating the position of the corner:

- 1/2" rebar as noted above:
- South 35 East 45.58-nail and washer 2' up west side of brace pole
- North 50 East 47.80-nail and washer 2' up north side of telephone pole
- South 50 West 104.5-northwest corner of house
- North 2 West 74.67-southwest corner of barn
- North 45 West 40.15-nail and washer 2' up south side of telephone pole

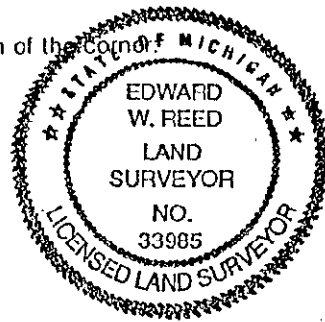

And is accepted as a careful and faithful reestablishment of the position of the original corner.

Signed by Edward W. Reed Date December 8, 1994
Surveyor's Michigan License No. 33985