

**BRANCH COUNTY REMONUMATION PROGRAM
LAND CORNER RECORDATION CERTIFICATE
Filing Requirement of Act 74, Mich. P.A. 1970**

SECTION

For corners in

BRANCH COUNTY Located In: Corner Code #
COLDWATER TWP

1. Public Land Survey T 6 S R 6 W A-9
T _____ R _____
T _____ R _____
T _____ R _____

2. Property Controlling in Section S _____ T _____ R _____
S _____
T _____ R _____

3. Miscellaneous S _____
T _____ R _____

Property in Sec. S _____
T _____ R _____

STATE OF MICHIGAN
Branch County
Recorded

11-08-1999 15:13:59

Linda Lee Morrison-Mathews
REGISTER OF DEEDS

Liber **00004** Page **0027**
Register of Deeds Stamp & File Number

4. Lot No. _____, Recorded Plat _____

5. Private Claims _____

I, EDWARD W. REED, in a field survey on JUNE 1, 19 99 do hereby state that under requirements of P.A. 74, Michigan P.A. of 1970, the corner points mentioned in lines 1 and 2 above were in conformance with regulations and rules therefore as required in the current manual of survey instructions of the United States Department of the Interior, Bureau of Land Management or by a decree of a Court of Law and /or that the corner points mentioned in lines 3, 4 and 5 above were in conformance with the rules of the Michigan Board of Land Surveyors or by a Decree of a Court of Law; established, re-established, monumented, recovered, found as expressed below:

NOTE: Not more than 2 corners, all in the same town and range, may be recorded on this certificate.

CORNER COMMON TO SECTIONS 24 & 25, BATAVIA TOWNSHIP, AND SECTIONS 19 & 30, BRANCH COUNTY, MICHIGAN

A	B	C	D	E	F	G	H	I	J	K	L	M
1												
2	6	5	4	3	2	1						
3												
4	7	8	9	10	11	12						
5												
6	18	17	16	15	14	13						
7												
8	19	20	21	22	23	24						
9												
10	30	29	28	27	26	25						
11												
12	31	32	33	34	35	36						
13												

A. Description of original monument and accessories and/or subsequent restoration:

- 1825: JOHN MULLETT, D.S., CORNER SET
- 1952: H.L. RUSSELL, R.L.S., PLAT OF NASH SUBDIVISION-REFERENCED TO CORNER H.L. RUSSELL, R.L.S., PLAT OF BROOKS SUBDIVISION, REFERENCED TO CORNER
- 1958: E.R. REED, R.L.S., PLAT OF NASH SUBDIVISION NO. 2, REFERENCED TO CORNER
- 1964: E.R. REED, R.L.S., SURVEY
- 1975: F.E. SPICER, R.L.S., R.R. SPIKE 1.8 DOWN, WITNESSED

ACCEPTED BY THE BRANCH COUNTY SURVEY PEER GROUP AS THE OFFICIAL CORNER UNDER MICHIGAN PUBLIC ACT 345 OF 1990 AT A MEETING HELD ON 10-06-1999
E.R. Reed, Co. Rep.
E.R. REED

B. Description of corner evidence found and/or method applied in restoring or reestablishing corner:

- FOUND T IRON AT ROAD SURFACE FITTING WITNESS OF NASH & BROOKS SUBDIVISION & SPICER WITNESSES
- FOUND 24" BELOW ROAD SURFACE, OLD IRON PIPE AND FLAGGING
- SET 1/2" X 18" REBAR AND REMON CAP
- SET CAST IRON BOX FLUSH WITH ROAD SURFACE

C. Description of monument for corner and accessories established to perpetuate locating the position of the corner:

- 1/2" X 18" REBAR WITH REMON CAP IN CAST IRON BOX
- N 4 E 32.66' FACE OF 3' SQUARE CONCRETE POST
- S 60 W 51.45' TAG IN NORTH SIDE OF POWER POLE
- N 65 E 51.2' GAS LINE POST
- N 54 W 57.85' TAG SOUTH SIDE POWER POLE
- S 68 E 72.79' FACE OF RAILROAD SIGNAL SIGN

AND IS ACCEPTED AS THE BEST AVIABLE EVIDENCE OF THE POSITION OF THE ORIGINAL CORNER

Signed by Edward W. Reed
EDWARD W. REED

Date JUNE 1, 1999

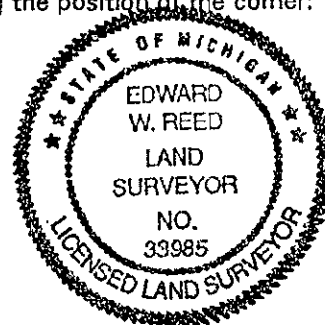

Surveyor's Michigan License No. 33985