

**SURVEY &
REMONUMENTATION**

MAR 13 1998

SECTION

**BRANCH COUNTY REMONUMENTATION CORNER
LAND CORNER RECORDATION CERTIFICATE
Filing Requirement of Act 74, Mich. P.A. 1970**

For corners in

BRANCH	Located In:	Corner Code #
(County)		
COLDWATER TWP.		
1. Public Land Survey	T <u>6</u> S R <u>6</u> W	<u>J-5</u>
	T <u> </u> R <u> </u>	<u> </u>
	T <u> </u> R <u> </u>	<u> </u>
	T <u> </u> R <u> </u>	<u> </u>
2. Property Controlling in Section	S <u> </u> T <u> </u> R <u> </u>	<u> </u>
	S <u> </u> T <u> </u> R <u> </u>	<u> </u>
3. Miscellaneous Property in Sec.	S <u> </u> T <u> </u> R <u> </u>	<u> </u>
	S <u> </u> T <u> </u> R <u> </u>	<u> </u>

STATE OF MICHIGAN
Branch County
Recorded

12-30-1997 10:04:59

Linda Lee Morrison-Mathews
REGISTRAR
LIBER 000053 Page 0189

Register of Deeds Stamp & File Number

4. Lot No. _____, Recorded Plat _____
5. Private Claims _____

I, EDWARD W. REED, in a field survey on OCTOBER 16, 1997 do hereby state that under requirements of P.A. 74, Michigan P.A. of 1970, the corner points mentioned in lines 1 and 2 above were in conformance with regulations and rules therefore as required in the current manual of survey instructions of the United States Department of the Interior, Bureau of Land Management or by a decree of a Court of Law and /or that the corner points mentioned in lines 3, 4 and 5 above were in conformance with the rules of the Michigan Board of Land Surveyors or by a Decree of a Court of Law; established, re-established, monumented, recovered, found as expressed below:

NOTE: Not more than 2 corners, all in the same town and range, may be recorded on this certificate.

	A	B	C	D	E	F	G	H	I	J	K	L	M
1													
2		6		5		4		3		2		1	
3													
4		7		8		9		10		11		12	
5										●			
6		18		17		16		15		14		13	
7													
8		19		20		21		22		23		24	
9													
10		30		29		28		27		26		25	
11													
12		31		32		33		34		35		36	
13													

A. Description of original monument and accessories and/or subsequent restoration:
QUARTER CORNER COMMON TO SECTIONS 11 & 14

- 1829: O. RISDON, D.S - CORNER SET
- 1860: M. KNOWLES, SURVEYOR - STONE WITH BRICK
- 1955: E.R. REED, CO. SURVEYOR - SURVEY TIED TO CORNER
- 1963: J. CORBIT, SURVEYOR, MDOT - 1" GAS PIPE
- 1967: R. WELKE, MDOT - 3/4" STEEL ROD IN MONUMENT BOX
- 1975: E.R. REED, CO. SURVEYOR - FOUND 3/4" IRON ROD IN MON. BOX, RECORDED LCRC # 158

ACCEPTED BY THE BRANCH COUNTY SURVEY PEER GROUP AS THE OFFICIAL CORNER UNDER MICHIGAN PUBLIC ACT 345 OF 1990 AT A MEETING HELD ON 12-08-97

E. R. Reed
E. R. REED

B. Description of corner evidence found and/or method applied in restoring or reestablishing corner:

FOUND 3/4" IRON ROD IN CI-MONUMENT BOX 4" BELOW PAVED ROAD SURFACE
RAISED BOX TO NEW ROAD SURFACE WITH RINGS, REMOVED 3/4" IRON, SET 1/2" X 18" REBAR IRON WITH REMON CAP

C. Description of monument for corner and accessories established to perpetuate locating the position of the corner:

- NAIL & WASHER S SIDE OF POWER POLE, S65E 91.61'
- NAIL & WASHER E. SIDE OF POWER POLE, S40W 77.10'
- NAIL & WASHER W. SIDE OF POWER POLE, S28E 81.50'
- CENTER OF 10" ELM, N10E 29.2'
- ANGLE IRON FENCE POST, N25W 87.00'

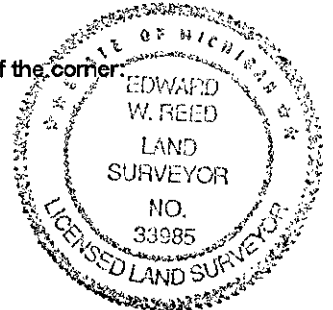

AND IS ACCEPTED AS A CAREFUL AND FAITHFUL PERPETUATION OF THE POSITION OF THE ORIGINAL CORNER

Signed by Edward W. Reed
EDWARD W. REED

Date OCTOBER 16, 1997

Surveyor's Michigan License No. 33985