

**SURVEY & REMONUMENTATION**

**MAR 13 1998**

**SECTION**

**BRANCH COUNTY REMONUMENTATION CORNER  
LAND CORNER RECORDATION CERTIFICATE**

**Filing Requirement of Act 74, Mich. P.A. 1970**

For corners in

<u>BRANCH</u>	Located In:	Corner Code #
(County)		
KINDERHOOK TWP.	<u>T 8 S R 6 W</u>	<u>C-3</u>
1. Public Land Survey	T <u>    </u> R <u>    </u>	<u>    </u>
	T <u>    </u> R <u>    </u>	<u>    </u>
	T <u>    </u> R <u>    </u>	<u>    </u>
2. Property Controlling	S <u>    </u> T <u>    </u> R <u>    </u>	<u>    </u>
in Section	S <u>    </u> T <u>    </u> R <u>    </u>	<u>    </u>
3. Miscellaneous	S <u>    </u> T <u>    </u> R <u>    </u>	<u>    </u>
Property in Sec.	S <u>    </u> T <u>    </u> R <u>    </u>	<u>    </u>

STATE OF MICHIGAN  
Branch County  
Recorded

12-30-1997 10:05:39

Linda Lee Morrison-Mathews  
REGISTER OF DEEDS

Liber **00003** Page **0194**

Register of Deeds Stamp & File Number

4. Lot No. \_\_\_\_\_, Recorded Plat \_\_\_\_\_  
5. Private Claims \_\_\_\_\_

I, EDWARD W. REED, in a field survey on OCTOBER 8, 1997 do hereby state that under requirements of P.A. 74, Michigan P.A. of 1970, the corner points mentioned in lines 1 and 2 above were in conformance with regulations and rules therefore as required in the current manual of survey instructions of the United States Department of the Interior, Bureau of Land Management or by a decree of a Court of Law and /or that the corner points mentioned in lines 3, 4 and 5 above were in conformance with the rules of the Michigan Board of Land Surveyors or by a Decree of a Court of Law; established, re-established, monumented, recovered, found as expressed below:

**NOTE: Not more than 2 corners, all in the same town and range, may be recorded on this certificate.**

A	B	C	D	E	F	G	H	I	J	K	L	M
1												
2	6	5		4		3		2		1		
3		●										
4	7	8		9		10		11		12		
5												
6	18	17		16		15		14		13		
7												
8	19	20		21		22		23		24		
9												
10	30	29		28		27		26		25		
11												
12	31	32		33		34		35		36		
13												

A. Description of original monument and accessories and/or subsequent restoration:  
CORNER COMMON TO SECTIONS 5-6-7-8

- 1828: R. CLARK jr. D.S.- CORNER SET
- 1974: E.R. REED, CO. SURVEYOR - OLD INFORMATION INDICATE ANCHOR POST, FOUND ANCIENT WOOD ANCHOR POST 14" IN DIA. WELL SET IN STONES WITH ANCIENT FENCELINE RNG N-S-E-W, RECORDED IN LCRC # 00112
- 1987: JIM BOYNTON, SURVEYOR - SET 1/2" IRON BAR IN MOUND OF ROCKS, RECORDED IN LCRC # II-00128

B. Description of corner evidence found and/or method applied in restoring or reestablishing corner:

FOUND 1/2" IRON ROD IN MOUND OF ROCKS FITTING BOTH WITNESS OF LCRC # 00112 & II-00128  
SET REMON CAP ON TOP OF 1/2" IRON REBAR

C. Description of monument for corner and accessories established to perpetuate locating the position of the corner:

- SET CARSONITE MARKER ALONG SIDE OF POINT
- PK NAIL IN 10" WALNUT, N10E 26.27'
- PK NAIL IN 24" HICKORY, N70E 7.30'
- PK NAIL IN 16" ASH, S5E 8.29'
- PK NAIL IN TRIPLE HICKORY, N40W 2.95'
- 14" W. CHERRY, N60E 8.2'
- 8" ASH, S40E 7.6'

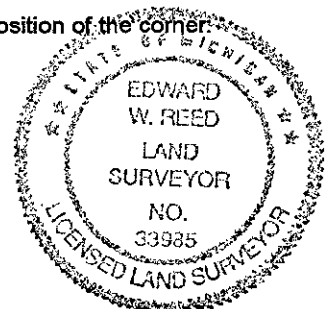

AND IS ACCEPTED AS A CAREFUL AND FAITHFUL PERPETUATION OF THE POSITION OF THE ORIGINAL CORNER

Signed by Edward W. Reed  
EDWARD W. REED

Date OCTOBER 8, 1997

Surveyor's Michigan License No. 33985

ACCEPTED BY THE BRANCH COUNTY SURVEY PEER GROUP AS THE OFFICIAL CORNER UNDER MICHIGAN PUBLIC ACT 345 OF 1990 AT A MEETING HELD ON 12.08.97

FORM APPROVED BY MICHIGAN STATE BOARD OF PROFESSIONAL SURVEYORS, JAN. 28  
REVISED MAY 14, 1975

E.R. Reed  
E.R. REED