

**SURVEY & REMONUMENTATION**

**MAR 13 1998**

**SECTION**

**BRANCH COUNTY REMONUMENTATION CORNER  
LAND CORNER RECORDATION CERTIFICATE  
Filing Requirement of Act 74, Mich. P.A. 1970**

For corners in

BRANCH (County)	Located In:	Corner Code #
KINDERHOOK TWP. 1. Public Land Survey	T 8 S R 6 W	I-5
	T ___ R ___	_____
	T ___ R ___	_____
	T ___ R ___	_____
2. Property Controlling in Section	S ___ T ___ R ___	_____
	S ___ T ___ R ___	_____
3. Miscellaneous Property in Sec.	S ___ T ___ R ___	_____
	S ___ T ___ R ___	_____

STATE OF MICHIGAN  
Branch County  
Recorded

12-30-1997 10:05:46

Linda Lee Morrison-Mathews  
REGISTER OF DEEDS

Liber **00003** Page **0195**

Register of Deeds Stamp & File Number

4. Lot No. \_\_\_\_\_, Recorded Plat \_\_\_\_\_

5. Private Claims \_\_\_\_\_

I, EDWARD W. REED, in a field survey on OCTOBER 8, 1997 do hereby state that under requirements of P.A. 74, Michigan P.A. of 1970, the corner points mentioned in lines 1 and 2 above were in conformance with regulations and rules therefore as required in the current manual of survey instructions of the United States Department of the Interior, Bureau of Land Management or by a decree of a Court of Law and /or that the corner points mentioned in lines 3, 4 and 5 above were in conformance with the rules of the Michigan Board of Land Surveyors or by a Decree of a Court of Law; established, re-established, monumented, recovered, found as expressed below:

	A	B	C	D	E	F	G	H	I	J	K	L	M
1													
2	6		5		4		3		2		1		
3													
4	7		8		9		10		11		12		
5													
6	18		17		16		15		14		13		
7													
8	19		20		21		22		23		24		
9													
10	30		29		28		27		26		25		
11													
12	31		32		33		34		35		36		
13													

**NOTE: Not more than 2 corners, all in the same town and range, may be recorded on this certificate.**

A. Description of original monument and accessories and/or subsequent restoration:  
CORNER COMMON TO SECTIONS 10-11-14-15

- 1828: R. CLARK, jr, D.S. - CORNER SET
- 1963: D. HOOTH, SURVEY CHIEF, MDOT - FOUND 5/8" STL. ROD
- 1973: E.R. REED, CO. SURVEYOR - TIED PLAT OF "HARBAUGH BEACH NO. 2" TO PLAT, SET CONCRETE PLAT MONUMENT AT CORNER.

B. Description of corner evidence found and/or method applied in restoring or reestablishing corner:

FOUND CONCRETE PLAT MONUMENT AS SHOWN ON PLAT OF "HARBAUGH BEACH NO. 2"  
SET REMON CAP ON TOP OF IRON IN MONUMENT

C. Description of monument for corner and accessories established to perpetuate locating the position of the corner:

- SET CARSONITE MARKER ALONG SIDE MONUMENT
- CONC. PLAT MONUMENT, S 00° 29' 53" E 134.61'
- CONC. PLAT MONUMENT, N 00° 04' 32" E 58.87'
- NW CORNER HOUSE, S71E 22.15'
- SW CORNER HOUSE, S26E 37.00'

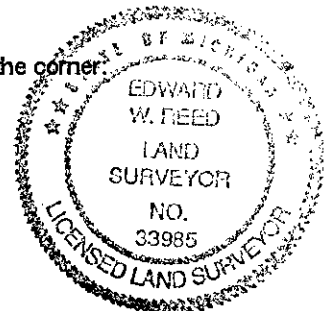

AND IS ACCEPTED AS A CAREFUL AND FAITHFUL PERPETUATION OF THE POSITION OF THE ORIGINAL CORNER

Signed by Edward W. Reed

Date OCTOBER 8, 1997

EDWARD W. REED

Surveyor's Michigan License No. 33985

ACCEPTED BY THE BRANCH COUNTY SURVEY PEER GROUP AS THE OFFICIAL CORNER UNDER MICHIGAN PUBLIC ACT 345 OF 1990 AT A MEETING HELD ON 12-08-97

FORM APPROVED BY MICHIGAN STATE BOARD OF PROFESSIONAL SURVEYORS, JAN. 28  
REVISED MAY 14, 1975

REVISED JAN. 198  
REVISED OCT. 199

F.R. Reed  
F.R. REED