

APPROVED

Date Sept 18 1996
CALHOUN COUNTY
REMONUMENTATION.
For corners in

CALHOUN COUNTY REMONUMENTATION
LAND CORNER RECORDATION CERTIFICATE
Filing Requirement of Act 74, Mich. P.A. 1970

STATE OF MICHIGAN
CALHOUN COUNTY
RECORDED

24 SEP 96 10:58 A.M.

ANNE B. NORLANDER
CLERK - REGISTER OF DEEDS

CALHOUN
(County)

Located In: _____ Corner Code # D-11

1. Public Land Survey T 2S R 8W _____
 1/4 CORNER COMMON TO T _____ R _____
 SECTIONS 29 AND 32 T _____ R _____
 CITY OF BATTLE CREEK T _____ R _____
 2. Property Controlling S _____ T _____ R _____
 in Section S _____ T _____ R _____
 3. Miscellaneous S _____ T _____ R _____
 Property in Sec. S _____ T _____ R _____

SURVEY & REMONUMENTATION

MAR 21 1997

4. Lot No. _____, Recorded Plat _____
 5. Private Claims _____

COMMISSION

Register of Deeds Stamp & File Number

I, BRIAN REYNOLDS, in a field survey on JUNE 26, 19 96, do hereby certify that under requirements of P.A. 74, Michigan P.A. of 1970, the corner points mentioned in lines 1 and 2 above were in conformance with regulations and rules thereore as required in the current manual of survey instructions of the United States Department of the Interior, Bureau of Land Management or by a decree of a Court of Law and/or that the corner points mentioned in lines 3, 4 and 5 above were in conformance with the rules of the Michigan Board of Land Surveyors or by a Decree of a Court of Law; established, re-established, monumented, re-monumented, recovered, found as expressed below:

A	B	C	D	E	F	G	H	I	J	K	L	M
2	6	5	4	3	2	1						
3												
4	7	8	9	10	11	12						
5												
6	18	17	16	15	14	13						
7												
8	19	20	21	22	23	24						
9												
10	30	29	28	27	26	25						
11												
12	31	32	33	34	35	36						
13												

NOTE: Not more than 4 corners, all in the same town and range, may be recorded on this certificate.

A. Description of original monument and accessories and/or subsequent restoration:

1. GENERAL LAND OFFICE: SYLVESTER SIBLEY D.S., APRIL 1826, " WEST CORRECTED TRUE LINE BETWEEN SECTIONS 29 AND 32 40.24 SET QR. SEC. POST FROM WHICH A HICKORY 8 IN DIAM. S32W 24 LKS DIST. A HICKORY 6 IN. DIAM N26E 37 LKS. DIST.
2. COUNTY SURVEYOR RECORDS: RESURVEY OF BATTLE CREEK TOWNSHIP BY FRANCIS HODGMAN, MAY 1887 "FOUND OLD STAKE IN CENTER OF ROAD GRADE IN LINE WITH FENCE EAST, SET POST, HICKORY 9" DI. EAST 69 LKS

SEE REVERSE OF THIS FORM FOR ADDITIONAL HISTORICAL INFORMATION (CONTINUATION OF PART "A")

B. Description of corner evidence found and/or method applied in restoring or reestablishing corner:

FOUND TWO IRONS, ONE NEAR THE INTERSECTION OF CENTERLINES, THE OTHER 6+/- FEET WEST OF CENTERLINE OF HEDGES ROAD (1 1/2 MILE ROAD). ALSO FOUND 22" OAK S15°+/-E 82+/- FEET (NAIL OVERGROWN) AND NAIL IN OAK STUMP S10°+/-E 102 +/- FEET. EXCAVATED BELOW IRON RECORDED BY DeKEYSER, FOUND A 3"X12" SOLID CORE TILE VERY TIGHTLY FITTED WITH STONES AROUND IT, WITH ANOTHER 3"X24" SOLID CORE TILE BELOW IT. THE MEASURED DISTANCE BETWEEN E-11 AND THE IRON AT C/L-C/L IS 2653.45 FEET; STATIONING BETWEEN CORNERS AS SHOWN ON THE MDOT RIGHT OF WAY BOOK PLANS IS 2654.16 FEET. IT APPEARS THAT THE IRON NEAR INTERSECTION OF CENTERLINES WAS PLACED BY MDOT AS STATION 0+00 FOR BECKLEY ROAD CONSTRUCTION CENTERLINE, AND DOES NOT REPRESENT THE GRID CORNER. ACCEPTED FOUND TILE AS TRUE CORNER POSITION AS PERPETUATED BY HODGMAN AND DeKEYSER, DISREGARDED OTHER FOUND IRON. TRIED TO INSTALL REMON MONUMENT ABOVE LOWER TILE, BUT MONUMENT EXTENDED ABOVE GRADE. REMOVED LOWER TILE, PLACED REMON MONUMENT WITH TOP 6" BELOW GRADE. INSTALLED MONUMENT BOX.

LIBER 1887 PAGE 975

C. Description of monument for corner and accessories established to perpetuate locating the position of the corner:

- SET STANDARD CALHOUN COUNTY REMONUMENTATION BERNSTEN MONUMENT AND MONUMENT BOX
- SET 20d NAIL W/PLASTIC TAG IN THE WEST SIDE OF 5" HICKORY S37°E 57.27 FEET
- SET 20d NAIL W/PLASTIC TAG OVER FD. NAIL OVERGROWN IN THE W SIDE OF 14" TW. CHERRY S25°E 63.21 FT.
- SET 20d NAIL W/PLASTIC TAG IN THE EAST SIDE OF 22" OAK S18°E 81.97 FEET
- FOUND P.K. NAIL W/SHINER IN NW SIDE OF UTILITY POLE N17°W 70.82 FEET
- FOUND P.K. NAIL IN THE E SIDE OF UTILITY POLE S60°W 24.69 FEET
- ON APPROX C/L OF BITUMINOUS ROADWAY EAST
- 5.5+/- FEET WEST OF C/L OF N-S BITUMINOUS ROADWAY

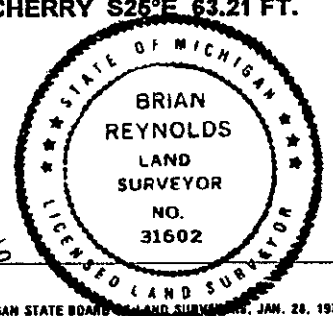

Signed by [Signature]

Date SEPT 18, 1996

Surveyor's Michigan License No. 31602

PART "A" (CONTINUED)

3. MICHIGAN STATE HIGHWAY DEPARTMENT SURVEY OF S. LINE OF SE 1/4 OF SEC. 29, EXT. OF BECKLEY ROAD AS PART OF CONSTRUCTION OF I-94 FREEWAY, CORNER SHOWN AS STATION 0+00 BECKLEY ROAD C/L. CORNER AND WITNESSES ARE NOT SHOWN ON CONST. PLANS FOR I-94, CONST. PLANS FOR BECKLEY ROAD EXTENSION COULD NOT BE FOUND BY MDOT PERSONNEL.
4. LAND CORNER RECORDATION CERTIFICATE BOOK I, PAGE 53, MILTON E. DeKEYSER, P.S. #12019, DATED DECEMBER 8, 1971 RECORDED MAY 31, 1972 "FOUND TILE 8" BELOW SURFACE OF ROAD 6 FEET WEST OF CENTERLINE OF 1 1/2 MILE ROAD.....PLACED 5/8" IRON ON TOP OF TILE 10" OAK S14°E 82.22 FEET (SPOTTER) SPOTTER IN 18" OAK S10°20'E 102.20 FEET R/W MARKER S45°15'E 50.65 FEET STREET SIGN N67°50'E 46.25 FEET
5. UNRECORDED SURVEY BY BRIAN REYNOLDS, P.S. #31602, NOVEMBER 1985, FOUND IRON AND 3 WITNESSES BY DeKEYSER (ITEM # 4 ABOVE)
10" OAK (LARGER NOW) S14°E 82.22 FEET SPOTTER IN 18" OAK (FOUND STUMP) S10°20'E 102.20 FEET
R/W MARKER S45°15'E 50.65 FEET STREET SIGN GONE
ALSO FOUND OLD NAIL W/SHINER IN POWER POLE N15°W 70.85 FEET