

APPROVED

CALHOUN COUNTY REMONUMENTAION
LAND CORNER RECORDATION CERTIFICATE
Filing Requirement of Act 74, Mich. P.A. 1970

STATE OF MICHIGAN
CALHOUN COUNTY
RECORDED

Date 3-19-97

CALHOUN COUNTY
REMONUMENTATION.

31 MAR 97 11:38 A.M.

ANNE B. NORLANDER
CLERK - REGISTER OF DEEDS

LIBER 1922 PAGE 728

Register of Deeds Stamp & File Number

CALHOUN

Located In:

Corner Code #

(County)

Tekonsha Township
1. Public Land Survey

T 4S R 6W

I-8

T R

T R

T R

S T R

2. Property Controlling
in Section

S

S T R

3. Miscellaneous
Property in Sec.

S

S T R

S

T R

4. Lot No. _____, Recorded Plat _____

5. Private Claims _____

I, Michael A. Groat, in a field survey on February 26, 1997 do hereby state that under requirements of P.A. 74, Michigan P.A. of 1970, the corner points mentioned in lines 1 and 2 above were in conformance with regulations and rules therefore as required in the current manual of survey instructions of the United States Department of the Interior, Bureau of Land Management or by a decree of a Court of Law and/or that the corner points mentioned in lines 3, 4 and 5 above were in conformance with the rules of the Michigan Board of Land Surveyors or by a Decree of a Court of Law; established, re-established, monumented, recovered, found as expressed below:

	A	B	C	D	E	F	G	H	I	J	K	L	M
1													
2	6		5		4		3		2		1		
3													
4	7		8		9		10		11		12		
5													
6	18		17		16		15		14		13		
7													
8	19		20		21		22		23		24		
9													
10	30		29		28		27		26		25		
11													
12	31		32		33		34		35		36		
13													

NOTE: Not more than 2 corners, all in the same town and range, may be recorded on this certificate.

A. Description of original monument and accessories and/or subsequent restoration:

R. Clark, Deputy Surveyor, 1826, set post 40 chains North of I-9
W. Oak, 18", S37°W, 98 Lks, W. Oak, 8", S82°E, 58 Lks.

Gifford, 1891, found corner set by Lewis and stump of one government bearing tree. Set post.
W. Oak, 10" N86°W, 22 Lks, W. Oak, N41½°E, 39 Lks.

B. Description of corner evidence found and/or method applied in restoring or reestablishing corner:

Found 3" hollow tile in rock pile at intersection of old fences East, West and North. Accepted the tile as careful and faithful perpetuation of the original corner and placed a Berntsen monument in its place.

C. Description of monument for corner and accessories established to perpetuate locating the position of the corner:

Set Berntsen monument with standard Calhoun County brass cap stamped with P.S. #39079 and corner information.

- Nail and tag in 18" Cherry, N60°W, 16.74 feet
- Nail and tag in 6" Cherry, S5°W, 16.74 feet
- Nail and tag in 6" Cherry, S80°E, 8.34 feet
- Nail and tag in 14" Maple, N72°E, 20.24 feet
- Nail and tag in 30" Cottonwood, S30°W, 13.85 feet
- Carsonite sign on North side

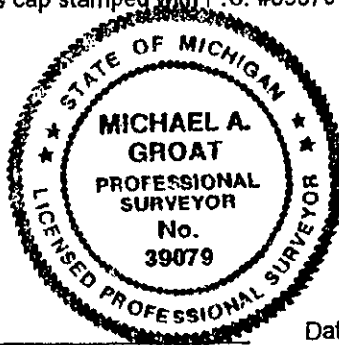

Signed by Michael A. Groat
Surveyor's Michigan License No. 39079

Date March 19, 1997

FORM APPROVED BY MICHIGAN STATE BOARD OF PROFESSIONAL SURVEYORS, JAN. 28, 1971

REVISED JAN., 1983
REVISED OCT., 1986

SURVEY &
REMONUMENTATION

APR 07 1998

SECTION