

FEB 19 1998

Liber 00003 Page 0157

SECTION

LAND CORNER RECORDATION CERTIFICATE
Filing Requirement of Act 74, Mich. P.A. 1970
CASS COUNTY REMONUMENTATION

For corners in CASS (County) Located In: Corner Code #
1. Public Land Survey NEWBERG TOWNSHIP T.6S R.13W M-8
2. Property Controlling in Section S T R
3. Miscellaneous Property in Sec. S T R

STATE OF MICHIGAN
COUNTY OF CASS
Recorded
12-26-1997 12:03:12
Ann L. Simmons
REGISTER OF DEEDS

Ratified by Peer Group
In Accordance With P.A. 345
Chairman Dale Kesler

Register of Deeds Stamp & File Number

4. Lot No. , Recorded Plat
5. Private Claims

Grid table with columns A-M and rows 1-13. Contains numbers 1-36 in a grid pattern.

I, DALE L. KESLER, in a field survey on SEPT. 22, 1997 do hereby state that under requirements of P.A. 74, Michigan P.A. of 1970, the corner points mentioned in lines 1 and 2 above were in conformance with regulations and rules therefore as required in the current manual of survey instructions of the United States Department of the Interior, Bureau of Land Management or by a decree of a Court of Law and /or that the corner points mentioned in lines 3, 4 and 5 above were in conformance with the rules of the Michigan Board of Land Surveyors or by a Decree of a Court of Law; established, re-established, monumented, recovered, found as expressed below:

NOTE: Not more than 2 corners, all in the same town and range, may be recorded on this certificate.

A. Description of original monument and accessories and/or subsequent restoration:

- *June 25, 1828 Government survey by Calvin Brittain indicates set 1/4 section post.
Witnesses: white oak 18" S 88 3/4 degrees W 1.03 ch.
*Dec. 5, 1949 Survey by Earl N. James indicates marker found at E 1/4, Section 24.
*April 1, 1955 Survey by Jay White, Jr. indicates marker found at E 1/4 post of Section 24.
*May 26, 1957 Survey by John L. Corbit shows no iron but gives reference to E 1/4 corner, Section 24.

B. Description of corner evidence found and/or method applied in restoring or reestablishing corner:

Found R.R. spike in road. Measured South 3.96 feet found 1/2" iron at the West Quarter of Section 19, T6S, R12W, St. Joseph County, Michigan. Accepted R.R. spike as best evidence of corner.

C. Description of monument for corner and accessories established to perpetuate locating the position of the corner:

Set 3/4" x 2' iron pipe with aluminum cap in place of R.R. spike in a monument box and is accepted as the best available evidence of the position of the original corner.

- PK nail West side 28" maple N 27 degrees 20' E 60.04'
PK nail West side 30" oak N 63 degrees 14' E 30.74'
PK nail West side 12" pine tree S 33 degrees 48' E 55.50'
PK nail SW side 12" maple N 45 degrees 09' W 26.76'
W 1/4 corner Section 19, T6S, R12W South 3.96'

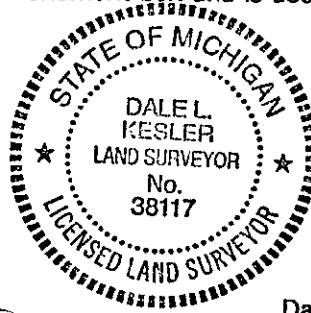

Signed by Dale Kesler
Surveyor's Michigan License No. 38117

Date 12/4/97