

SURVEY & REMONUMENTATION

FEB 19 1998

Liber 00003 Page 0129

LAND CORNER RECORDATION CERTIFICATE
Filing Requirement of Act 74, Mich. P.A. 1970
CASS COUNTY REMONUMENTATION

SECTION

For corners in CASS Located In: T 6S R 15W Corner Code # G-13
 (County)

1. Public Land Survey T 6S R 15W G-13
LAGRANGE TWP.
 T R
 T R
 T R

2. Property Controlling S T R
 in Section S T R

3. Miscellaneous S T R
 Property in Sec. S T R

STATE OF MICHIGAN
 COUNTY OF CASS
 Recorded

12-26-1997 11:56:12

Ann L. Simmons
 REGISTER OF DEEDS

Printed by Post Group
 In Accordance With P.A. 645
 Chairman Dale L. Kesler

Register of Deeds Stamp & File Number

4. Lot No. _____, Recorded Plat _____
 5. Private Claims _____

	A	B	C	D	E	F	G	H	I	J	K	L	M
1													
2	6		5		4		3		2		1		
3													
4	7		8		9		10		11		12		
5													
6	18		17		16		15		14		13		
7													
8	19		20		21		22		23		24		
9													
10	30		29		28		27		26		25		
11													
12	31		32		33		34		35		36		
13													

I, DALE L. KESLER, in a field survey on AUG. 13, 1997 do hereby state that under requirements of P.A. 74, Michigan P.A. of 1970, the corner points mentioned in lines 1 and 2 above were in conformance with regulations and rules therefore as required in the current manual of survey instructions of the United States Department of the Interior, Bureau of Land Management or by a decree of a Court of Law and /or that the corner points mentioned in lines 3, 4 and 5 above were in conformance with the rules of the Michigan Board of Land Surveyors or by a Decree of a Court of Law; established, re-established, monumented, recovered, found as expressed below:

NOTE: Not more than 2 corners, all in the same town and range, may be recorded on this certificate.

A. Description of original monument and accessories and/or subsequent restoration:

*1827 WILLIAM BROOKFIELD. WEST 80.00 CH., 7" OAK N 29 1/2 W 63, 12" OAK N 78 1/4 E 58.

*MAR. 16-19, 1916 W.W. REYNOLDS, COUNTY SURVEYOR FOUND GOOD STONE - SET. WITNESSES: WHITE OAK 24" N 30 1/2 DEGREES W 61 1/2 LKS., MAPLE 14" S 9 3/4 DEGREES E 45 LKS.

*JULY 1946 E. JAMES FOUND CORNER - MEASURED NORTH 50 FEET TO R.O.W. CORNER.

*JAN. 27, 1977 SURVEY BY ROBERT PRESTINE NOTES THAT P.K. NAIL WAS SET AT SE CORNER SECTION 33-6-15, 1.2' S OF CL ASPHALT PAVEMENT; 209.88' E OF NE CORNER SEC. 4-7-15. WITNESSES C.L. 24" ASH S 60 DEGREES E, 96.8', FACE 18" CONCRETE FENCE POST, NORTH 50.25'.

*NOV. 21, 1978 CORNER NOTED IN CERTIFIED SURVEY BY ROBERT PRESTINE, RLS, RECORDED IN LIBER 1 OF SURVEYS ON PAGE 778. GOVERNMENT SURVEY NOTES JEFFERSON TOWNSHIP CORNER IS 209.9 FEET WEST.

*NOV. 21, 1978 WENLEY Q. SMITH FOUND PK SPIKE OVER CAST IRON MONUMENT BOX IN CONCRETE PAVING. BOX OVER COULD NOT BE REMOVED WITH AVAILABLE EQUIPMENT, INCLUDING A COBRA IMPACT HAMMER. REPLACED PK SPIKE WITH A R.R. SPIKE; FROM WHICH A 24" ASH BEARS SOUTH 60 DEGREES EAST 96.8 FEET TO CENTERLINE, AND FACE OF 18" FENCE POST BEARS NORTH 50.25 FEET, AND CENTER LINE OF M-60 PAVING IS NORTH 1.2 FEET.

B. Description of corner evidence found and/or method applied in restoring or reestablishing corner:

FOUND P.K. NAIL IN HIGHWAY, DUG 6" BELOW SURFACE FOUND 1/2" PIPE IN MONUMENT BOX. THE ACCESSORIES OF THE 1977 SURVEY BY ROBERT PRESTINE VERIFY LOCATION OF CORNER. DISTANCES TO ADJACENT CORNERS WERE REASONABLE AND CONSISTENT. ACCEPTED P.K. NAIL AS BEST EVIDENCE OF CORNER.

C. Description of monument for corner and accessories established to perpetuate locating the position of the corner:

SET 3/4" IRON PIPE WITH ALUMINUM CAP IN MONUMENT BOX AND IS ACCEPTED AS THE BEST AVAILABLE EVIDENCE OF THE POSITION OF THE ORIGINAL CORNER.

- C/L FACE CONCRETE PILLAR NORTH 50.35'
- PK NAIL IN POWER POLE 27" MAPLE S 73 DEGREES 16' E 138.80'
- PK NAIL IN POWER POLE N 9 DEGREES 46' E 52.48'
- PK NAIL IN POWER POLE S 73 DEGREES 16' W 175.65'
- NE COR. SECTION 4, T7S, R15W, WEST 209.88'

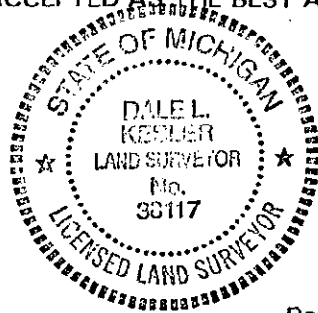

Signed by Dale L. Kesler
 Surveyor's Michigan License No. 38117

Date 12/24/97