

**LAND CORNER RECORDATION CERTIFICATE**  
**Filing Requirement of Act 74, Mich. P.A. 1970**

For corners in

CASE	Located In:	Corner Code //
(County)		
1. Public Land Survey	T 7S R 14W	K6
	T 7S R 14W	K7
	T 7S R 14W	MC S. of K6
	T R	
2. Property Controlling in Section	S T R	
	S T R	
3. Miscellaneous Property in Sec.	S T R	
	S T R	

**Register of Deeds Stamp & File Number**

4. Lot No. \_\_\_\_\_, Recorded Plat  
 5. Private Claims

MC March 03, 1992  
 K7 February 06, 1992

I, Gary C. Bilow, in a field survey on K6 February 07, 1992, do hereby certify that under requirements of P.A. 74, Michigan P.A. of 1970, the corner points mentioned in lines 1 and 2 above were in conformance with regulations and rules therefore as required in the current manual of survey instructions of the United States Department of the Interior, Bureau of Land Management or by a decree of a Court of Law and/or that the corner points mentioned in lines 3, 4 and 5 above were in conformance with the rules of the Michigan Board of Land Surveyors or by a Decree of a Court of Law; established, re-established, monumented, re-monumented, recovered, found as expressed below:

**NOTE: Not more than 4 corners, all in the same town and range, may be recorded on this certificate.**

	A	B	C	D	E	F	G	H	I	J	K	L	M
2	6		5		4		3		2		1		
3													
4	7		8		9		10		11		12		
5													
6	18		17		16		15		14		13		
7													
8	19		20		21		22		23		24		
9													
10	30		29		28		27		26		25		
11													
12	31		32		33		34		35		36		
13													

**A. Description of original monument and accessories and/or subsequent restoration:**

**K6:** Post established by U.S. Deputy Surveyor C. Britain in 1828 - accessories: Beech 14 S55E 35 and Beech 17 N16W 18. Plat of Chain Lake Acres dated 1961 is tied to corner. Field notes of Department of Natural Resources Surveyor D. Scott dated October 1970 show "Found iron - accessories: S46-1/2W 44.8' 12" Oak, S31W 31.6' 12" Ash, and S48E 34.7' Twin Maple."  
**K7:** Post established by U.S. Deputy Surveyor C. Britain in 1828 - accessories: White Oak 14 S86E 1.82 and White Ash 19 S20W 1.88. Found no other record.  
**Meander Corner south of K6:** Post established by U.S. Deputy Surveyor C. Britain in 1828 - accessories: Cherry 4 N7W 90 and White Oak 12 N34E 3.02. No other record found.

**B. Description of corner evidence found and/or method applied in restoring or reestablishing corner:**

**K6:** Found 3/4" iron bar in centerline of Chain Lake Street on southerly projection of tree line to north and agreeing with Plat dimensions. Accepted this corner as the best evidence of the original GLO post.  
**K7:** Found 1" x 5" iron pipe by projecting the east line of the Plat of Chain Lake Acres south from corner K6 at record GLO measure. This pipe falls 27 feet short of record GLO measurement of 40 chains from corner K6 at the end of an old downed fence going west. The line formed by this pipe and corner K6 is approximately 119.5 feet east of the east line of the Chain Lake Acres Plat compared to the 120 feet shown on the plat. Accepted 1" Iron pipe as the best evidence of the original GLO post. (This corner is in a wetland accessible only in very dry or very cold times of the year.)  
**Meander Corner south of K6:** Reestablished corner at single proportionate distance between corners K6 and K7.

**C. Description of monument for corner and accessories established to perpetuate locating the position of the corner:**

<b>K6:</b> Left 3/4" iron bar in place S60E 58.83'. Nail & Tag in Power pole North 46.95'. Nail & Tag in Power pole South 33.00'. MDNR monument East 90'. Centerline entrance road to small factory to the south	<b>K7:</b> Left 1" x 60" iron pipe in place. Added 2" x 60" iron pipe projecting 1' above the ground over the original pipe S4W 19.80'. Nail & Tag in 12" Basswood N82W 16.29'. Nail & Tag in 6" Basswood N68E 7.16'. Nail & Tag in 6" Basswood S67E 23.89'. Nail & Tag in 10" Basswood East 50'. West edge North-South street	<b>Meander Corner south of K6:</b> Set 1/2" x 3/8" rebar in a 4" diameter concrete cylinder and capped with a cast aluminum Michigan Department of Natural Resource Tablet S8E 10.81'. 1/2" iron bar S84W 119.84'. Plat monument N22W 316.14'. Plat monument North 293.56'. 3/4" iron pipe
--	--	--

Signed by Gary C. Bilow  
 Surveyor's Michigan License No. 26453

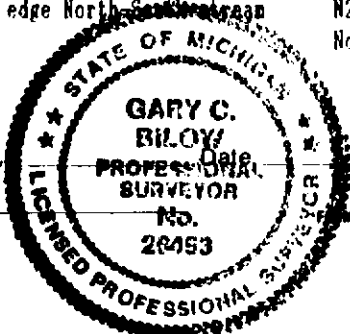

4/30/93  
 APPROVED BY MICHIGAN STATE BOARD OF LAND SURVEYORS, JAN. 26, 1971  
 REVISED MAY 14, 1975  
 REVISED JAN., 1983