

**CASS COUNTY REMONUMENTATION
LAND CORNER RECORDATION CERTIFICATE**
Filing Requirement of Act 74, Mich. P.A. 1970

For corners in **MILTON TOWNSHIP**

<u>CASS</u> (County)	Located In:	Corner Code #
1. Public Land Survey	T <u>8S</u> R <u>16W</u>	<u>B-9</u>
	T _____ R _____	_____
	T _____ R _____	_____
	T _____ R _____	_____
2. Property Controlling in Section	S _____ T _____ R _____	_____
	S _____ T _____ R _____	_____
3. Miscellaneous Property in Sec.	S _____ T _____ R _____	_____
	S _____ T _____ R _____	_____
4. Lot No. _____, Recorded Plat _____		
5. Private Claims _____		

STATE OF MICHIGAN
COUNTY OF CASS
Recorded
12-22-1999 12:37:28
Ann L. Simmons
REGISTER OF DEEDS
Register of Deeds Stamp & File Number

Ratified by Peer Group
In Accordance With P.A. 345
Chairman *[Signature]*

I, **CHRISTIAN F. MARBACH** in a field survey on **DECEMBER 7**, 19 **99**, do hereby certify that under requirements of P.A. 74, Michigan P.A. of 1970, the corner points mentioned in lines 1 and 2 above were in conformance with regulations and rules therefore as required in the current manual of survey instructions of the United States Department of the Interior, Bureau of Land Management or by a decree of a Court of Law and/or that the corner points mentioned in lines 3, 4 and 5 above were in conformance with the rules of the Michigan Board of Land Surveyors or by a Decree of a Court of Law; established, re-established, monumented, re-monumented, recovered, found as expressed below:

A	B	C	D	E	F	G	H	I	J	K	L	M
2	6	5	4	3	2	1						
3												
4	7	8	9	10	11	12						
5												
6	18	17	16	15	14	13						
7												
8	19	20	21	22	23	24						
9	▲											
10	30	29	28	27	26	25						
11												
12	31	32	33	34	35	36						
13												

NOTE: Not more than 4 corners, all in the same town and range, may be recorded on this certificate.

A. Description of original monument and accessories and/or subsequent restoration:

ORIGINAL MONUMENT: NOTHING SET
ACCESSORIES: NONE
SUBSEQUENT RESTORATION: SET STONE (F.E. SMITH, CO. SURVEYOR 4-7-1891)
FOUND STONE (H.L. DREHER 1941)
MONUMENT (H.L. DREHER 1955 PLAT GROFF ACRES)
MONUMENT (WIGHTMAN PIERCE 1989)
MONUMENT (ABONMARCHE 1995)

B. Description of corner evidence found and/or method applied in restoring or reestablishing corner:

FOUND ANGLE IRON NEXT TO CONCRETE MONUMENT AT SE CORNER OF GROFF ACRES, 1955 PLAT

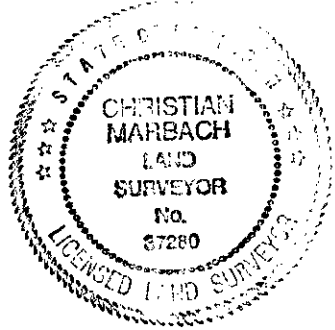

C. Description of monument for corner and accessories established to perpetuate locating the position of the corner:

MONUMENT: CONCRETE MONUMENT (36" LONG/REBAR WITH ALUMINUM TABLET) TABLET IS STAMPED "CASS COUNTY REMONUMENTATION". THIS POSITION NOT ESTABLISHED BY ORIGINAL GOVERNMENT SURVEYORS, THIS MONUMENT IS ACCEPTED AS THE BEST AVAILABLE EVIDENCE OF THE POSITION OF THE CORNER.

- PK NORTH SIDE 12" CHERRY N90°W-6.30'
- PK WEST SIDE 30" OAK N5°E-11.00'
- PK WEST SIDE 8" OAK N10°E-13.50'
- IRON PIPE FOUND N90°E-73.70'

Signed by *Christian F. Marbach* RF Date 12/21/99
 Surveyor's Michigan License No. 37280 FEB 4 2000

SECTION