

MAR 09 1994

Chippewa County Remonumentation Corner

RECEIVED FOR RECORD  
CHIPPEWA COUNTY  
STATE OF MICHIGAN

COMMISSION

LAND CORNER RECORDATION CERTIFICATE  
Filing Requirement of Act 74, Mich. P.A. 1970

93 DEC 29 AM 10:27

For corners in  
Chippewa

(County)	Located In:	Corner Code #/
1. Public Land Survey	T <u>44N</u> R <u>1E</u>	<u>I-3</u>
	T _____ R _____	_____
	T _____ R _____	_____
	T _____ R _____	_____
2. Property Controlling in Section	S _____ T _____ R _____	_____
	S _____ T _____ R _____	_____
3. Miscellaneous Property in Sec.	S _____ T _____ R _____	_____
	S _____ T _____ R _____	_____

*J. Roger Malott*  
REGISTER OF DEEDS

Register of Deeds Stamp & File Number

4. Lot No. \_\_\_\_\_, Recorded Plat \_\_\_\_\_  
5. Private Claims \_\_\_\_\_

I, Larry R. Rogers, in a field survey on November 15, 19 93, do hereby certify that under requirements of P.A. 74, Michigan P.A. of 1970, the corner points mentioned in lines 1 and 2 above were in conformance with regulations and rules therefore as required in the current manual of survey instructions of the United States Department of the Interior, Bureau of Land Management or by a decree of a Court of Law and/or that the corner points mentioned in lines 3, 4 and 5 above were in conformance with the rules of the Michigan Board of Land Surveyors or by a Decree of a Court of Law; established, re-established, monumented, re-monumented, recovered, found as expressed below:

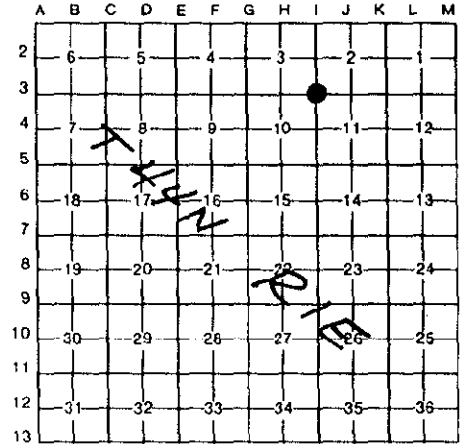

**NOTE:** Not more than 4 corners, all in the same town and range, may be recorded on this certificate.

A. Description of original monument and accessories and/or subsequent restoration:  
(I-3) Section Corner Common to Sections 2, 3, 10 & 11 (T44N-R1E)

Corner was set in 1930 by C.M. Cade as part of a survey of the Munoscong State Forest with the following witnesses:

Monument	East	33.0'	Pole	N67°E	39.0'
Pole	S62°E	30.7'	5" Spruce	N65°W	101.5'
Post	S47°E	36.1'	5" Spruce	S58°W	63.3'

Billy Buckler (M.D.N.R.) found witness monument and Southwest Spruce witness in 1973, set a 1/2" iron below the road at corner and recorded it in Liber 1, Page 72 of the Chippewa County Corner Records.

B. Description of corner evidence found and/or method applied in restoring or reestablishing corner:

(I-3) This corner is being perpetuated as part of the Chippewa County Remonumentation Program.

The Buckler iron was used in several surveys by Northwoods Land Surveying prior to its removal during reconstruction of Riverside Drive. Corner position was re-established from existing survey control stations. Position checks with Witness Monument to East and Cade 14" Spruce (dead) to the Southwest. Established four new witnesses.

C. Description of monument for corner and accessories established to perpetuate locating the position of the corner:  
(I-3) Corner is a 3/4" x 24" iron, 8" below grade of gravel road, on centerline (extended) of Riverside Drive to the North, Krause Road to the South and Nineteen Mile Road to the West.

Witnesses: DNR Witness Monument	S87°E	32.40'
"V" Cut in East End 20" C.M.P.	S56°E	29.34'
Utility Pole (PD2/21/75)	N20°W	184.71'
10" Spruce	S79°W	198.31'
14" Dead Spruce	S43°W	63.66'

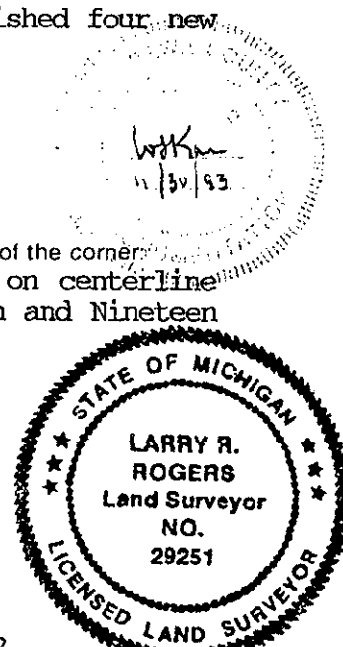

Signed by [Signature] 29251

Date 23 Dec 1993

Surveyor's Michigan License No.

**NOTE:** Bearings are compass bearings corrected for declination.  
Distances are to a nail in side of witness objects unless noted.