

1999

SECTION

LAND CORNER RECORDATION CERTIFICATE
Filing Requirement of Act 74, Mich. P.A. 1970
Chippewa County Remonumentation Corner

For corners in

Table with columns: Chippewa County, Located in:, Corner Code #. Rows include Public Land Survey, Property Controlling in Section, Miscellaneous Property in Sec., Lot No., and Private Claims.

47.00 LAND CORNER
\$2.00 MSSR
5 MAR 1999 2:07:04 PM Receipt #14029
RECEIVED FOR RECORD
CHIPPewa COUNTY - STATE OF MICHIGAN
SHARON H. KENNEDY, REGISTER OF DEEDS

BOOK 11 PAGE 22
Register of Deeds Stamp & File Number

I, Keith R. Waters, in a field survey on April 13, 1998, do hereby state that under requirements of P.A. 74, Michigan P.A. of 1970, the corner points mentioned in lines 1 and 2 above were in conformance with regulations and rules therefore as required in the current manual of survey instructions of the United States Department of the Interior, Bureau of Land Management or by a decree of a Court of Law and /or that the corner points mentioned in lines 3, 4 and 5 above were in conformance with the rules of the Michigan Board of Land Surveyors or by a Decree of a Court of Law; established, re-established, monumented, recovered, found as expressed below:

NOTE: Not more than 2 corners, all in the same town and range, may be recorded on this certificate.

A. Description of original monument and accessories and/or subsequent restoration:

G-3 Corner Common to Sections 3, 4, 9, & 10, T44N, R2W

- 1845 - Original corner (6" Aspen) established by James Mullett.
1897 - Chippewa County Surveyor Frederick H. Brown, RLS 944, notes for Section 3 indicate "corner by Chamberlain of Mackinac County."
1915 - Brown's note for Section 9 state "took the corner as it was used for roads."
1927 - Chippewa County Surveyor corner tie book shows a cement post and 1 1/2" gas pipe, with various witnesses.
1959 - Liber 3, page 227, Chippewa County corner records. Michigan State Highway Department surveyor Ray Walker, this corner is a 1" iron pipe alongside wood hub. Witnesses:
Power Pole, N35°W 40.76' - Telephone Pole, S42°E 40.47' - Fence Post, S57°W 42.47'.

B. Description of corner evidence found and/or method applied in restoring or reestablishing corner:

This corner is being perpetuated as part of the Chippewa County Remonumentation Program. Found a 1" iron pipe in the intersection of Hantz Road and 19 Mile Road. All previous witness objects mentioned above are gone. Distances to adjacent corners check well with above mentioned 1897 and 1915 County Surveyor notes. Accepted corner as found.

C. Description of monument for corner and accessories established to perpetuate locating the position of the corner:

Found a 1" iron pipe at the corner location, which falls in the centerline intersection of Hantz Road and 19 Mile Road (M-48). Witnesses:

- Nail and plastic witness tag #33142 in side of Power Pole, N80°E 151.82'
Nail and plastic witness tag #33142 in side of Corner Fence Post, N44°W 67.86'
Northwesterly corner of triangular concrete Right-of-way Marker, S61°E 58.88'
Nail and plastic witness tag #33142 in side of Power Pole, S08°W 312.12'

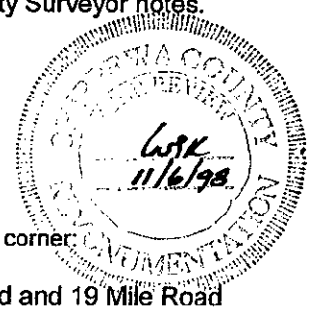
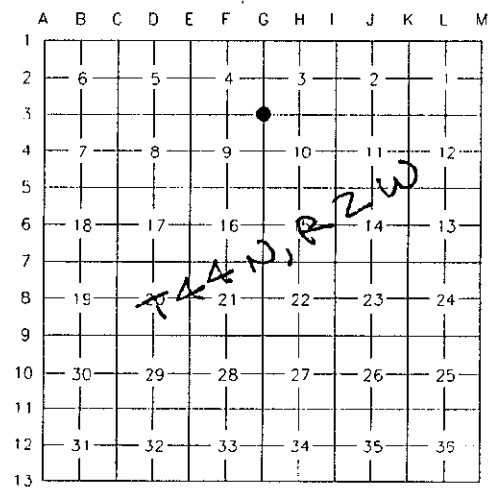

Signed by Keith R. Waters

Date 12-30-98

Surveyor's Michigan License No. 33142