

LAND CORNER RECORDATION CERTIFICATE
Filing Requirement of Act 74, Mich. P.A. 1970
Chippewa County Remonumentation Corner

SECTION
 For corners in

Chippewa County	Located in:	Corner Code #
1. Public Land Survey	T44N R2W	G-9
	T R	
	T R	
	T R	
2. Property Controlling in Section	S T R	
	S T R	
3. Miscellaneous Property in Sec.	S T R	
	S T R	
4. Lot No. , Recorded Plat		
5. Private Claims		

\$7.00 LAND CORNER
 \$2.00 MSSR
 5 MAR 1999 2:13:02 PM Receipt #14029
 RECEIVED FOR RECORD
 CHIPPEWA COUNTY - STATE OF MICHIGAN
 SHARON H. KENNEDY, REGISTER OF DEEDS

BOOK **11** PAGE **28**
 Register of Deeds Stamp & File Number

I, Keith R. Waters, in a field survey on April 13, 1998, do hereby state that under requirements of P.A. 74, Michigan P.A. of 1970, the corner points mentioned in lines 1 and 2 above were in conformance with regulations and rules therefore as required in the current manual of survey instructions of the United States Department of the Interior, Bureau of Land Management or by a decree of a Court of Law and for that the corner points mentioned in lines 3, 4 and 5 above were in conformance with the rules of the Michigan Board of Land Surveyors or by a Decree of a Court of Law; established, re-established, monumented, recovered, found as expressed below:

NOTE: Not more than 2 corners, all in the same town and range, may be recorded on this certificate.

A. Description of original monument and accessories and/or subsequent restoration:

G-9 Corner Common to Sections 21, 22, 27, & 28, T44N, R2W

- 1845 - Original corner established by James Mullett.
 Witnesses: Cedar 12, N38°E 22 links - Cedar 12, S46°W 28 links.
- 1905 - Chippewa County Surveyor Frederick H. Brown, RLS 944, notes for Section 28, "corner fixed by roads and fences when I began to survey in T44N, R2W, and think they were surveyed by Mackinac County Surveyor."
- 1915 - Brown notes that Chamberlain made the corner, which was probably measured from the northwest corner of Section 28, which was only 1 mile north of the only known original government corner in the area.
- Circa 1930's - Chippewa County Surveyor corner tie book shows corner with several witnesses.
- 1959 - Liber 2, page 257, Chippewa County corner records. Michigan State Highway Department surveyor Ray Walker, standard MSHD iron monument box, located in macadam on M-48. No witnesses are shown.

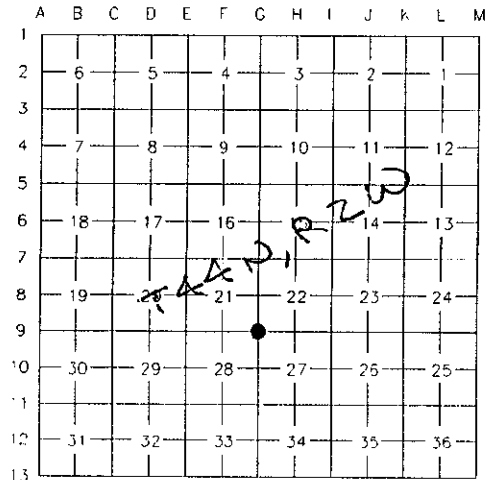

B. Description of corner evidence found and/or method applied in restoring or reestablishing corner:

This corner is being perpetuated as part of the Chippewa County Remonumentation Program. Found a 3/4" iron in a monument box in the centerline of Highway M-48, at the intersection of Hantz Road north and south. Distances to adjacent corners check well with those as shown in the above mentioned County Surveyor notes. The distance to section corner E-9 one mile to the east, which according to Brown's 1905 notes this corner was established from, is within 0.9 feet of the distance as shown by Brown. Accepted corner as found.

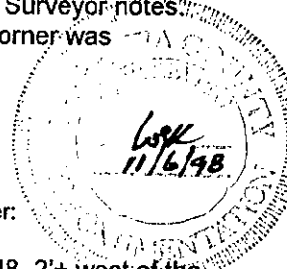

C. Description of monument for corner and accessories established to perpetuate locating the position of the corner:

Found a 3/4" iron in a monument box at the corner location, which falls in the centerline of Highway M-48, 2'± west of the centerline of Hantz Road north and south. Witnesses:

- Nail and plastic witness tag #33142 in side of Power Pole (RU2/24A/1), N05°W 200.62'
- Nail and plastic witness tag #33142 in side of Cut-off Power Pole, N35°E 80.80'
- Nail and plastic witness tag #33142 in side of Stop Sign Post, S28°E 46.02'
- Nail and plastic witness tag #33142 in side of Power Pole (RU2/24/17), S24°W 75.02'



Signed by Keith R. Waters

Date 12-30-98

Surveyor's Michigan License No. 33142