

**LAND CORNER RECORDATION CERTIFICATE**  
**Filing Requirement of Act 74, Mich. P.A. 1970**

For corners in  
Chippewa  
 (County)

Located In: Corner Code #

1. Public Land Survey	T <u>45N</u> R <u>1W</u>	<u>C4</u>
	T <u>    </u> R <u>    </u>	<u>    </u>
	T <u>    </u> R <u>    </u>	<u>    </u>
	T <u>    </u> R <u>    </u>	<u>    </u>
2. Property Controlling in Section	S <u>    </u> T <u>    </u> R <u>    </u>	<u>    </u>
	S <u>    </u> T <u>    </u> R <u>    </u>	<u>    </u>
3. Miscellaneous Property in Sec.	S <u>    </u> T <u>    </u> R <u>    </u>	<u>    </u>
	S <u>    </u> T <u>    </u> R <u>    </u>	<u>    </u>

Register of Deeds Stamp & File Number

4. Lot No. \_\_\_\_\_, Recorded Plat \_\_\_\_\_  
 5. Private Claims \_\_\_\_\_

Jun 12 2002

I, Stephan J. Szyszkoski, in a field survey on \_\_\_\_\_, 19\_\_\_\_ do hereby state that under requirements of P.A. 74, Michigan P.A. of 1970, the corner points mentioned in lines 1 and 2 above were in conformance with regulations and rules therefore as required in the current manual of survey instructions of the United States Department of the Interior, Bureau of Land Management or by a decree of a Court of Law and /or that the corner points mentioned in lines 3, 4 and 5 above were in conformance with the rules of the Michigan Board of Land Surveyors or by a Decree of a Court of Law; established, re-established, monumented, recovered, found as expressed below:

NOTE: Not more than 2 corners, all in the same town and range, may be recorded on this certificate.

1	A	B	C	D	E	F	G	H	I	J	K	L	M
2		6		5		4		3		2		1	
3													
4		7	●	8		9		10		11		12	
5													
6		18		17		16		15		14		13	
7													
8		19		20		21		22		23		24	
9													
10		30		29		28		27		26		25	
11													
12		31		32		33		34		35		36	
13													

**A. Description of original monument and accessories and/or subsequent restoration:**

(C4) Quarter corner common to Sections 7-8. 1845: Established by James Mullett, D.S.: North between Sections 7 & 8...40.00 set quarter section post Birch 8 S88E 13, Birch 10 S41W 23 ...80.00 Section Corner. 1973: Corner shown on "Assessor's Plat No. 1 of Dafter Twp." by M.D. Alix RLS 6254 (surveyed in 1970). No description of the monument or witnesses are shown. The platted bearing and distance north to C3 is N03 deg. 29'39"E 2640.63' and that to a monument at the intersection of the E-W 1/4 line of Sec. 8 with the W'ly R/W of Interstate Hwy. I-75 is S 85 deg. 43'30"E 2255.14'.

**B. Description of corner evidence found and/or method applied in restoring or reestablishing corner:**

(C4) The original post and accessories were not recovered. Found a 5" dia. brass cap stamped "Chippewa County T45N R1W N1/4 Sec. 8" set in either a concrete cylinder or in a concrete collar. I found distances north and east to C3 and plat monument noted above to be 2639.29' and 2255.85', respectively, forming an angle of 90 deg. 49' 43" (plat = 90 deg. 46' 51"). I accept the monument as the best available evidence of the position of the original corner. A 1/2" dia. iron pipe of unknown origin is S50W (mag) 1.1' from the monument. The centerline of a road is East, 60'.

**C. Description of monument for corner and accessories established to perpetuate locating the position of the corner:**

(C4) Found 5" dia. brass Chippewa County cap in concrete. Blazed, scribed, and set measuring nails in:  
 8" Maple clump N85E 10.65' "1/4S N8T"  
 6" Balsam N17W 7.3' do  
 10" Maple West 25.05' do  
 5" Maple clump S09W 13.25' do  
 1/2" ID I.pipe S50W 1.1'  
 Bearings are magnetic. Distances are to nail with tag.

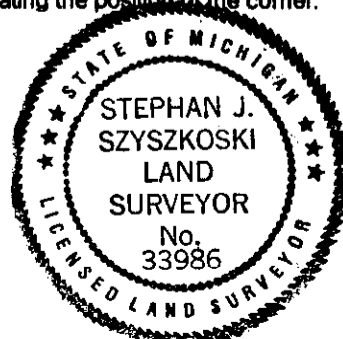

Signed by Stephan J. Szyszkoski  
 Surveyor's Michigan License No. 33986

Date 9/10/02