

LAND CORNER RECORDATION CERTIFICATE
Filing Requirement of Act 74, Mich. P.A. 1970 as Amended

For corners in

<u>Chippewa</u> (County)	Located In:	Corner Code #
1. Public Land Survey	T <u>45N</u> R <u>1W</u>	<u>F10</u>
	T <u> </u> R <u> </u>	<u> </u>
	T <u> </u> R <u> </u>	<u> </u>
2. Property Controlling in Section	S <u> </u> T <u> </u> R <u> </u>	<u> </u>
3. Miscellaneous Property in Sec.	S <u>28</u> T <u>45N</u> R <u>1W</u>	<u>8</u>
	S <u> </u> T <u> </u> R <u> </u>	<u> </u>
	S <u> </u> T <u> </u> R <u> </u>	<u> </u>

Register of Deeds Stamp & File Number

4. Lot No. _____, Recorded Plat _____
 5. Private Claims

F10 Apr 07 2005
 8 Apr 11 2005

I, Stephan J. Szyszkoski, in a field survey on _____, 20____ do hereby state that under requirements of P.A. 74, Michigan P.A. of 1970, the corner points mentioned in lines 1 and 2 above were in conformance with regulations and rules therefore as required in the current manual of survey instructions of the United States Department of the Interior, Bureau of Land Management or by a decree of a Court of Law and /or that the corner points mentioned in lines 3, 4 and 5 above were in conformance with the rules of the Michigan Board of Land Surveyors or by a Decree of a Court of Law; established, re-established, monumented, recovered, found as expressed below:

A	B	C	D	E	F	G	H	I	J	K	L	M
1												
2	6	5	4	3	2	1						
3												
4	7	8	9	10	11	12						
5												
6	10	17	16	15	14	13						
7												
8	19	20	21	22	23	24						
9												
10	30	29	28	27	26	25						
11												
12	31	32	33	34	35	36						
13												

NOTE: Not more than 2 corners, all in the same town and range, may be recorded on this certificate.

A. Description of original monument and accessories and/or subsequent restoration:

(F10) Center of Section 28. Not established in the original survey.
 (8-Sec. 28) West 1/16 corner, Section 28. Not established in the original survey.

B. Description of corner evidence found and/or method applied in restoring or reestablishing corner:

(F10) Established the corner at the intersection of straight lines connecting opposite 1/4 corners.
 (8-Sec. 28) Established the corner midway and on a straight line between Quarter corner 1322.48' West and Center of Section 1322.48' East.

C. Description of monument for corner and accessories established to perpetuate locating the position of the corner:

(F10) Set 1"IDx36" I.pipe with 4" alum. MDNR cap. Set measuring nails in: 5" W.Birch S66W 5.95' mrkd "CS BT" 4" Oak N55W 6.3' do 18" Maple clump S58E 38.45' do 5" Oak N22W 34.15' do Bearings are magnetic. Distances are to nail with tag.	(8) Set 1"IDx36" I.pipe with 4" alum. MDNR cap. Set measuring nails in: 5" Oak S54W 34.95' mrkd "W1/16 BT" 6" Aspen S04W 28.2' do 4" Oak S79E 25.45' do 5" Oak S89E 26.2' do Bearings are magnetic. Distances are to nail with tag.
--	---

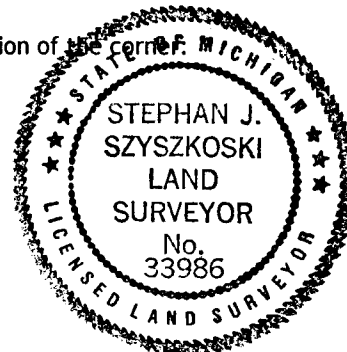

Signed by Stephan J. Szyszkoski
 Surveyor's Michigan License No. 33986

Date 6/1/05

For the Michigan Department of Natural Resources, Office of Land and Facilities