

MAR 27 1996

CHIPPEWA COUNTY REMONUMENTATION CORNER

LAND CORNER RECORDATION CERTIFICATE

Filing Requirement of Act 74, Mich. P.A. 1970

For corners in

Chippewa

(County)

Located in:

Corner Code #

1. Public Land Survey

T46N R2W

T45NR2W

T R

T R

2. Property Controlling in Section

S T R

S T R

3. Miscellaneous Property in Sec.

S T R

S T R

T-13 Same  
I-13 Corner

\$ 7.00 LAND CORNER

\$ 2.00 MSSR

29 FEB 96 9:33 A.M. RECEIPT# 462

RECEIVED FOR RECORD

CHIPPEWA COUNTY - STATE OF MICHIGAN  
SHARON H. KENNEDY, REGISTER OF DEEDS

Register of Deeds Stamp & File Number

4. Lot No. \_\_\_\_\_, Recorded Plat \_\_\_\_\_

5. Private Claims \_\_\_\_\_

I, Larry R. Rogers, in a field survey on Oct. 23, 1995 do hereby state that under requirements of P.A. 74, Michigan P.A. of 1970, the corner points mentioned in lines 1 and 2 above were in conformance with regulations and rules therefore as required in the current manual of survey instructions of the United States Department of the Interior, Bureau of Land Management or by a Decree of a Court of Law and for that the corner points mentioned in lines 3, 4 and 5 above were in conformance with the rules of the Michigan Board of Land Surveyors or by a Decree of a Court of Law; established, re-established, monumented, recovered, found as expressed below.

NOTE: Not more than 2 corners, all in the same town and range, may be recorded on this certificate.

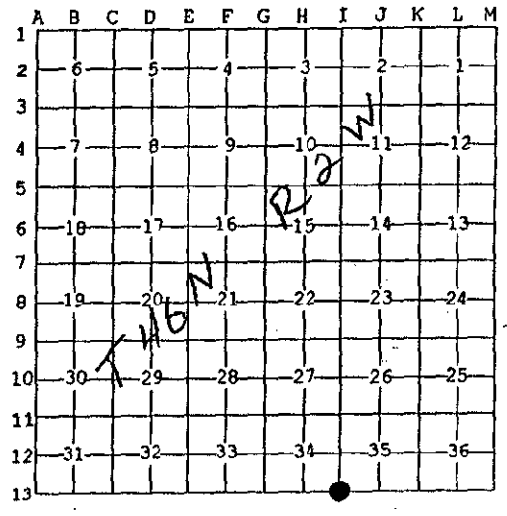
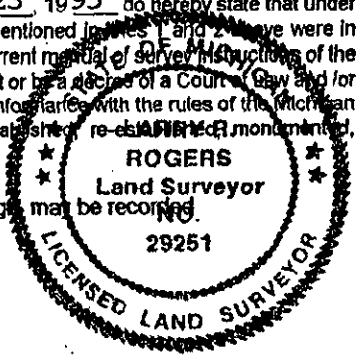

A. Description of original monument and accessories and/or subsequent restoration:  
(I-13) Southwest Corner of Section 35, T46N, R2W

1927: County Surveyor F.H. Brown refers to corner as "cement and cedar" with a distance along the South line of Section 35 being 5260 feet.

1991: Gerald L. Wiggins, P.S. 23521. Corner recorded in Liber 7, Page 306 of the Chippewa County Corner Records. Wiggins set 1" iron pipe midway on line between Section corners 1 mile East and West and established four new witnesses.

B. Description of corner evidence found and/or method applied in restoring or reestablishing corner:  
(I-13) This corner is being perpetuated as part of the Chippewa County Remonumentation Program.

Found bent "Wiggins" iron pipe. Also found "Brown" concrete monument with small gauge wire next to cut off wood post, N30°E, 11.74 feet from "Wiggins" pipe. Distance from concrete monument to concrete monument at Southeast corner of Section 35 is 5259.3 feet (5260 Co. Surv.). Accepted concrete monument as best evidence of the perpetuation of the original corner position and established three new witnesses.

C. Description of monument for corner and accessories established to perpetuate locating the position of the corner:  
(I-13) Corner is a concrete monument with small gauge wire, 8" below grade of 12 Mile Road (gravel), and 1.5 feet North of centerline.

Witnesses:	5" Spruce	N36°W	54.95'
	5" Spruce	N28°E	50.90'
	Utility Pole (REA/Co-op/B/213)	S32°E	35.78'
	"Wiggins" Pipe	S30°W	11.74'



Witnessed by [Signature]  
Surveyor's Michigan License No. 29251

Date 25 DEC 1995

NOTE: All bearings are compass bearings corrected for declination. All distances are to a nail in side of witness objects unless otherwise noted.

FORM APPROVED BY MICHIGAN STATE BOARD OF PROFESSIONAL SURVEYORS, JAN. 28, 1971

REVISED MAY 14, 1975  
REVISED JAN., 1983  
REVISED OCT., 1985