

APR 26 1995

CHIPPEWA COUNTY REMONUMENTATION CORNER

COMMISSION

**LAND CORNER RECORDATION CERTIFICATE**  
**Filing Requirement of Act 74, Mich. P.A. 1970**

For corners in  
Chippewa  
(County)

Located In: \_\_\_\_\_ Corner Code ##

- 1. Public Land Survey T 45N R 1W  
 T 45N R 2W  
 T \_\_\_\_\_ R \_\_\_\_\_  
 T \_\_\_\_\_ R \_\_\_\_\_
- 2. Property Controlling S \_\_\_\_\_ T \_\_\_\_\_ R \_\_\_\_\_  
 in Section S \_\_\_\_\_ T \_\_\_\_\_ R \_\_\_\_\_
- 3. Miscellaneous S \_\_\_\_\_ T \_\_\_\_\_ R \_\_\_\_\_  
 Property in Sec. S \_\_\_\_\_ T \_\_\_\_\_ R \_\_\_\_\_
- 4. Lot No. \_\_\_\_\_, Recorded Plat \_\_\_\_\_
- 5. Private Claims \_\_\_\_\_

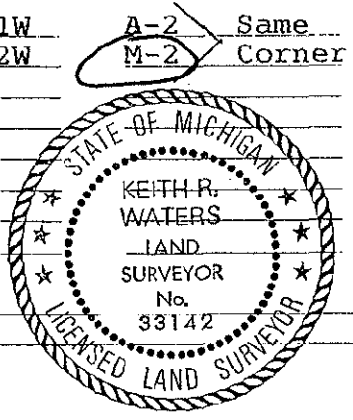

\$ 7.00 LAND CORNER  
 \$ 2.00 MSSR  
 5 DEC 94 12:36 P.M. RECEIPT# 1520  
 RECEIVED FOR RECORD  
 CHIPPEWA COUNTY - STATE OF MICHIGAN  
 SHARON H. KENNEDY, REGISTER OF DEEDS

Register of Deeds Stamp & File Number

	A	B	C	D	E	F	G	H	I	J	K	L	M
2	6	5	4	3	2	1							
3													
4	7	8	9	10	11	12							
5													
6	18	17	16	15	14	13							
7													
8	19	20	21	22	23	24							
9													
10	30	29	28	27	26	25							
11													
12	31	32	33	34	35	36							
13													

I, Keith R. Waters, in a field survey on November 12, 1994, do hereby certify that under requirements of P.A. 74, Michigan P.A. of 1970, the corner points mentioned in lines 1 and 2 above were in conformance with regulations and rules therefore as required in the current manual of survey instructions of the United States Department of the Interior, Bureau of Land Management or by a decree of a Court of Law and/or that the corner points mentioned in lines 3, 4 and 5 above were in conformance with the rules of the Michigan Board of Land Surveyors or by a Decree of a Court of Law; established, re-established, monumented, re-monumented, recovered, found as expressed below:

**NOTE: Not more than 4 corners, all in the same town and range, may be recorded on this certificate.**

A. Description of original monument and accessories and/or subsequent restoration:

A-2 1/4 Corner Common to Section 6, T45N, R1W & Section 1, T45N, R2W.

Original ties to post: Cedar 9, N36°W 15 links  
 Hemlock 8, N06°W 11 links

1908 - County Surveyor notes by F.H. Brown indicate found original corner and original bearing trees.

B. Description of corner evidence found and/or method applied in restoring or reestablishing corner:

A-2 (T45N, R1W)  
 This corner is being re-established as part of the Chippewa County Remonumentation Program.  
 Found no evidence of corner or its accessories. Re-established corner by single proportionate measurement on range line between Southwest corner of Section 18, T45N, R1W to the south and Northwest corner of Section 6, T45N, R1W (Township corner) to the north.

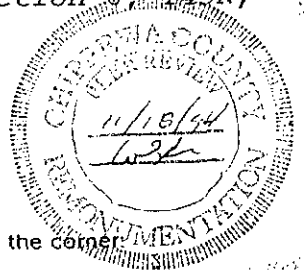

C. Description of monument for corner and accessories established to perpetuate locating the position of the corner:

A-2 (T45N, R1W)  
 Corner is a 3/4" x 24" rebar with 3 1/4" aluminum Chippewa County Remonumentation cap. Witnesses:  
 10" Spruce, S18°E 5.19'  
 4" Red Maple, S68°W 24.87'  
 6" Red Maple, N46°W 10.92'  
 6" Spruce, N04°E 20.13'

Note: Distances are to a nail and tag in the side of the tree. Trees are blazed and painted. Bearings are compass bearings corrected for declination.

Signed by Keith R. Waters Date 12-1-94

Surveyor's Michigan License No. 33142