

MAY 28 1997

CHIPPEWA COUNTY REMONUMENTATION CORNER COMMISSION

LAND CORNER RECORDATION CERTIFICATE Filing Requirement of Act 74, Mich. P.A. 1970

\$7.00 RECORDING FEE

For corners in

Chippewa

(County)

Located In:

Corner Code #

- 1. Public Land Survey T46N R 1W L-5
2. Property Controlling in Section S T R
3. Miscellaneous Property in Sec. S T R

\$2.00 MSSR

3/3/1997 5:21:16 PM Receipt #275 RECEIVED FOR RECORD CHIPPEWA COUNTY - STATE OF MICHIGAN SHARON H. KENNEDY, REGISTER OF DEEDS

BOOK 10 PAGE 53

Register of Deeds Stamp & File Number

- 4. Lot No. Recorded Plat
5. Private Claims

Keith R. Waters 08/20 96 in a field survey on 19 do hereby state that under requirements of P.A. 74, Michigan P.A. of 1970, the corner points mentioned in lines 1 and 2 above were in conformance with regulations and rules therefore as required in the current manual of survey instructions of the United States Department of the Interior, Bureau of Land Management or by a decree of a Court of Law and/or that the corner points mentioned in lines 3, 4 and 5 above were in conformance with the rules of the Michigan Board of Land Surveyors or by a Decree of a Court of Law; established, re-established, monumented, recovered, found as expressed below:

NOTE: Not more than 2 corners, all in the same town and range, may be recorded on this certificate.

Grid table with columns A-M and rows 1-13. A dot is present at row 5, column L.

A. Description of original monument and accessories and/or subsequent restoration:

L-5 1/4 Corner Common to Sections 12 & 13, Town 46 North, Range 1 West
1845 - Original ties (James Mullett): Birch 10, N20°E 25 links - Spruce 4, S20°W 13 links.
Circa 1900 - County Surveyor Frederick H. Brown states that the bearing tree had been grubbed out and lay beside the road. He located where it had been and re-established the corner accordingly.
1985 - Larry R. Rogers, P.S. 29251, LCRC recorded in liber 6, page 289. Found a 3/4" square iron 10 feet out of position. Re-established corner using County Surveyor notes and maintaining latitude of found iron. Set a 1/2" iron with cap #29251 at corner position.
Witnesses: Power Pole (DR4-6A-17), N74°W 170.42' - Power Pole, N82°E 230.75'
Square MBT box, S84°W 219.30' - Wood Post, S10°E 33.69'

B. Description of corner evidence found and/or method applied in restoring or reestablishing corner:

This corner is being perpetuated as part of the Chippewa County Remonumentation Program. Found a 1/2" iron pin with cap #29251 approximately 6 feet north of the centerline of 8 Mile Road (gravel). Also found three witnesses as called for in LCRC liber 6, page 289. Distances east and west to recovered section corners are within 0.4 feet of those as shown in above mentioned Frederick H. Brown notes.

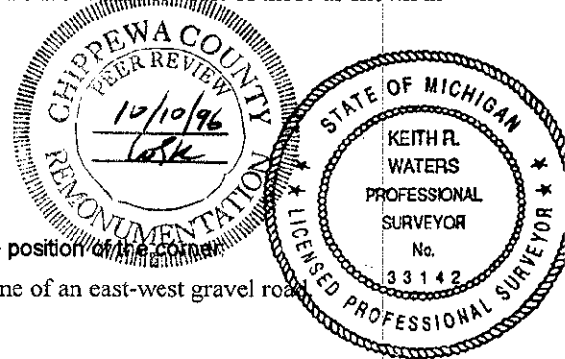

C. Description of monument for corner and accessories established to perpetuate locating the position of the corner:

Corner is a 1/2" iron pin with plastic cap #29251 approximately 6 feet north of the centerline of an east-west gravel road (8 Mile Road), at a fence line to the north. Witnesses:
Power Pole, N82°E 230.68'
6" Scotch Pine, S06°W 78.42' (Side blaze only)
Corner Fence Post, N03°E 29.09'
Power Pole (DR4-6A-17), N74°W 170.29'

Note: Distances are to a nail/tag #33142 in the side of the witness object. Bearings are compass bearings corrected for declination.

Signed by Keith R. Waters
Surveyor's Michigan License No. 33142

Date 12-30-96

BOOK 10 PAGE 53