

MAR 10 1999

**LAND CORNER RECORDATION CERTIFICATE**  
 Filing Requirement of Act 74, Mich. P.A. 1970  
 Chippewa County Remonumentation Corner

For corners in SECTION

<u>Chippewa</u>	Located In:	Corner Code #
1. Public Land Survey	T <u>46N</u> R <u>2E</u>	<u>B/C-5</u>
	T _____ R _____	
	T _____ R _____	
	T _____ R _____	<u>#5</u>
2. Property Controlling in Section	S _____ T _____ R _____	
	S _____ T _____ R _____	
3. Miscellaneous Property in Sec.	S _____ T _____ R _____	
	S _____ T _____ R _____	
4. Lot No. _____, Recorded Plat _____		
5. Private Claims _____		

\$7.00 LAND CORNER  
 \$2.00 MSSR  
 21 JAN 1999 10:15:12 AM Receipt #13123  
 RECEIVED FOR RECORD  
 CHIPPEWA COUNTY - STATE OF MICHIGAN  
 SHARON H. KENNEDY, REGISTER OF DEEDS  
 BOOK 10 PAGE 336  
 Register of Deeds Stamp & File Number

I, Larry R. Rogers in a field survey on November 10, 1998, do hereby state that under requirements of P.A. 74, Michigan P.A. of 1970, the corner points mentioned in lines 1 and 2 above were in conformance with regulations and rules therefore as required in the current manual of survey instructions of the United States Department of the Interior, Bureau of Land Management or by a decree of a Court of Law and/or that the corner points mentioned in lines 3, 4 and 5 above were in conformance with the rules of the Michigan Board of Land Surveyors or by a Decree of a Court of Law; established, re-established, monumented, recovered, found as expressed below:

**NOTE: Not more than 2 corners, all in the same town and range, may be recorded on this certificate.**

1	A	B	C	D	E	F	G	H	I	J	K	L	M
2		6		5		4		3		2		1	
3										2E			
4		7		8		9		10		2E		11	
5													
6		18		17		16		15		14		13	
7													
8		19		20		21		22		23		24	
9													
10		30		29		28		27		26		25	
11													
12		31		32		33		34		35		36	
13													

- A. Description of original monument and accessories and/or subsequent restoration:  
(B/C-5) Meander Corner between Sections 7 and 18, Township 46 North, Range 2 East.  
 The original corner was placed in 1845 by James H. Mullett. County Surveyor records make no specific reference to this corner. Line between Section 7 and 18 is shown on the Plat of "Clover Beach Subdivision" as recorded in Liber 4 of Plats, Page 6 of the Chippewa County Records in 1922. A 1975 B.L.M. dependent resurvey shows the Meander Corner to be 861.3 feet into the St. Mary's River; no witness corner was set.
- B. Description of corner evidence found and/or method applied in restoring or reestablishing corner:  
(B/C-5) Meander Corner between Sections 7 and 18, Township 46 North, Range 2 East.  
 This corner is being perpetuated as part of the Chippewa County Remonumentation Program. Found no evidence of original corner position. Established a Witness Corner to the Meander Corner at the intersection of the extension of the South line of Section 8 extended Westery to the Northwesterly line of Lot 12 of said "Clover Beach Subdivision". Distance to Southwest corner of Section 8 is 396.34 feet (775.16 feet short of original Meander Corner).
- C. Description of monument for corner and accessories established to perpetuate locating the position of the corner:  
(B/C-5) Witness Corner to the Meander Corner between Sections 7 and 18, Township 46 North, Range 2 East.  
 Corner is 3/4" x 48" rebar with stamped aluminum cap set 6" above grade.

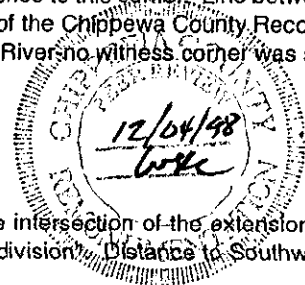

- Witnesses:
- |                              |       |             |
|------------------------------|-------|-------------|
| 8" Ash                       | N03°E | 49.00 feet  |
| 6" Ash                       | N51°E | 47.74 feet  |
| 8" Ash                       | S47°E | 32.56 feet  |
| 8" Ash                       | S49°W | 2.28 feet   |
| 1/2" iron (SW corner Lot 12) | S46°W | 9.62 feet   |
| 1/2" iron (NW corner Lot 13) | N46°E | 480.38 feet |
| Steel Fence Post             | North | 2.0 feet    |



Signed by [Signature] Date 30 DEC 1998

Surveyor's Michigan License No. 29251

NOTE: All bearings are compass bearings corrected for declination (6°W). All distances are to a nail and tag in the side of witness object unless otherwise noted.