

LAND CORNER RECORDATION CERTIFICATE
Filing Requirement of Act 74, Mich. P.A. 1970
Chippewa County Remonumentation Corner

SECTION

For corners in

Chippewa County	Located in:	Corner Code #
1. Public Land Survey	T47N R1E	G-6
	T R	
	T R	
	T R	
2. Property Controlling in Section	S T R	
	S T R	
3. Miscellaneous Property in Sec.	S T R	
	S T R	
4. Lot No. , Recorded Plat		
5. Private Claims		

BOOK 11 PAGE 85

\$9.00 LAND CORNER
 \$2.00 MSSR
 23 FEB 2000 3:53:36 PM Receipt #2117
 RECEIVED FOR RECORD
 CHIPPEWA COUNTY - STATE OF MICHIGAN
 SHARON H. KENNEDY, REGISTER OF DEEDS

Register of Deeds Stamp & File Number

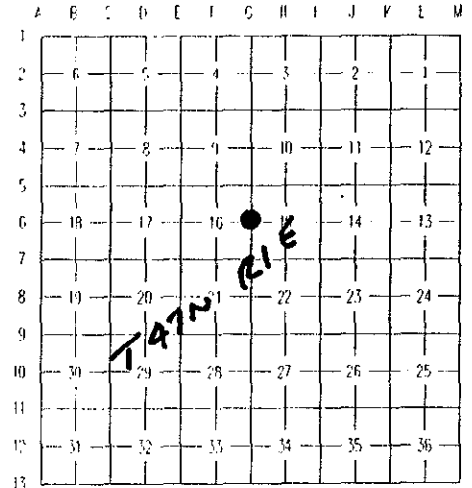

I, William L. Karr, in a field survey on December 14, 1999, do hereby state that under requirements of P.A. 74, Michigan P.A. of 1970, the corner points mentioned in lines 1 and 2 above were in conformance with regulations and rules therefore as required in the current manual of survey instructions of the United States Department of the Interior, Bureau of Land Management or by a decree of a Court of Law and /or that the corner points mentioned in lines 3, 4 and 5 above were in conformance with the rules of the Michigan Board of Land Surveyors or by a Decree of a Court of Law; established, re-established, monumented, recovered, found as expressed below:

NOTE: Not more than 2 corners, all in the same town and range, may be recorded on this certificate.

A. Description of original monument and accessories and/or subsequent restoration:

(G-6) 1/4 Corner common to Sections 15 and 16, Township 47 North, Range 1 East.

- 1845 James J. Mullett set post.
- 1889 F.H. Brown, County Surveyor. Re-survey of County Farm, field notes filed in County Surveyor's office Green Field book #7. Brown's field notes (Green field book #7), dissertation, and map of County Farm survey can be found in the County Surveyor's office. Brown indicates there is a discrepancy between his 1/4 post and that of Carletons by 193 links. Brown's survey establishes the 1/4 post 40 chains North of the Section corner and on line from the Section corner to the meander corner. Brown then measures the distance from the 1/4 post West to the East line of the Methodist Mission Reserve as 17.1 chains (1128.6 feet).
- 1963 L.E. Levin survey for M.N.P. Co. parcel 165 in Book 3 of Plats, County Surveyor's office in the location sketch for drawing. Levin identifies the 1/4 corner as an iron 40 chains North of Section corner and 11.7 chains South of meander corner. Section line is shown East of Gardenville Road.
- 1974 Neree D. Alix, P.E. survey sketch for E.L. Harvey (Job No.: 73070-s) field under T47N R1E Northwoods flat files. Note #2 on this drawing states "The West line of Section 15 is located 127 feet more or less East of the centerline of Ridge Road (See Court case of Chippewa County versus Sophia Pullar)."
- 1986 Earl S. Strater P.S. 28424 filed a LCRC in Liber 6, page 315. Strater set 1/2" iron with cap 40 chains from section corner approximately 2 feet West of the centerline of the Gardenville Road.
- 1990 William L. Karr, P.S. 27450, Hellow Estates filed in Liber 15, page 24 of Plats. Plat show corner as iron set by Strater.
- 1994 Lawrence E. Weinreis, P.S. 32343 filed a LCRC in Liber 8, page 275 in Chippewa County Corner

B. Description of corner evidence found and/or method applied in restoring or reestablishing corner:

(G-6) 1/4 Corner common to Sections 15 and 16, Township 47 North, Range 1 East.

This corner is being perpetuated as part of the Chippewa County Remonumentation Program. Found no evidence of the original corner. Found 1/2" iron with cap no. 32343, two feet West of centerline of Gardenville Road. Distance South to Section corner is 2639.99. Distance West to East line of Methodist Mission Reserve is 987.9 feet.

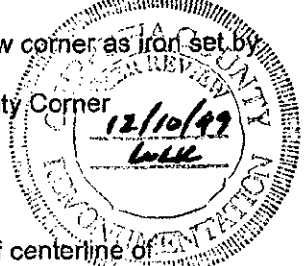

BOOK 11 PAGE 85

Continued on reverse side.

C. Description of monument for corner and accessories established to perpetuate locating the position of the corner:

(G-6) 1/4 Corner common to Sections 15 and 16, Township 47 North, Range 1 East.

Corner is a 3/4" iron with stamped 4" aluminum Chippewa County Remonumentation Cap in monument box. Falls 2.0 feet West of centerline of Gardenville Road.

Witnesses:

Power Pole J31/7 (new tag)	N31°E	62.26 feet (existing)	12" Ash	S76°W	83.19 feet (existing)
Power Pole	S02°E	187.54 feet (existing)	14" Aspen	N45°W	54.47 feet (existing)

(Most Westerly of Twin)

Bearings are compass bearings, corrected for declination (7°), all distances are to a nail and tag in the side of the witness object unless otherwise noted.

Signed by William L. Karr

Date 12-29-99

Surveyor's Michigan License No. 27450

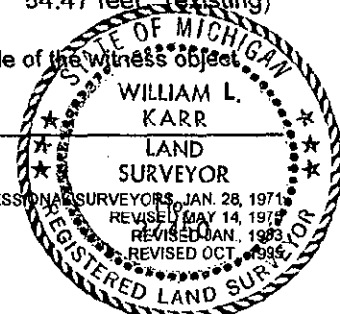

FORM APPROVED BY MICHIGAN STATE BOARD OF PROFESSIONAL SURVEYORS, JAN. 28, 1971
 REVISED MAY 14, 1977
 REVISED JAN. 1993
 REVISED OCT. 1995

B. Description of corner evidence found and/or method applied in restoring or reestablishing corner:
(G-6) 1/4 Corner common to Sections 15 and 16, Township 47 North, Range 1 East.

Brown also stated that his Section line fell on an old road bed "plainly visible". There is no road bed visible East of the Gardenville Road, which may now be on the Brown line. In addition, the Section corner to the South is consistent with the other corners of the Pullar Farm survey. To attempt to move this corner East would serve no purpose, especially since there are many surveys based on its current position. Accepted corner position as found and replaced 1/2" iron with a 3/4" x 24" iron with stamped aluminum Chippewa County Remonumentation cap and placed in a monument box.

RF

SECTION

BOOK 11 PAGE 86

Signed by William L. Karr

Date 12-29-99

Surveyor's Michigan License No. 27450

FORM APPROVED BY MICHIGAN STATE BOARD OF PROFESSIONAL SURVEYORS, JAN. 28, 1971

