

1899

LAND CORNER RECORDATION CERTIFICATE
Filing Requirement of Act 74, Mich. P.A. 1970
Chippewa County Remonumentation Corner

For corners in SECTION

Chippewa Located In: Corner Code #
1. Public Land Survey SAME CORNER { T 46N R 2E E-1
T 47N R 2E E-13
T R
T R
2. Property Controlling S T R
in Section S T R
3. Miscellaneous S T R
Property in Sec. S T R

\$7.00 LAND CORNER
\$2.00 MSSR
21 JAN 1999 10:19:45 AM Receipt #13103
RECEIVED FOR RECORD
CHIPPEWA COUNTY - STATE OF MICHIGAN
SHARON H. KENNEDY, REGISTER OF DEEDS

BOOK 10 PAGE 343
Register of Deeds Stamp & File Number

4. Lot No. Recorded Plat
5. Private Claims

I, Larry R. Rogers in a field survey on November 6, 1998, do hereby state that under requirements of P.A. 74, Michigan P.A. of 1970, the corner points mentioned in lines 1 and 2 above were in conformance with regulations and rules therefore as required in the current manual of survey instructions of the United States Department of the Interior, Bureau of Land Management or by a decree of a Court of Law and/or that the corner points mentioned in lines 3, 4 and 5 above were in conformance with the rules of the Michigan Board of Land Surveyors or by a Decree of a Court of Law; established, re-established, monumented, recovered, found as expressed below:

NOTE: Not more than 2 corners, all in the same town and range, may be recorded on this certificate.

Grid table with columns A-M and rows 1-12. Contains handwritten annotations: 'E' at (2,5), 'R' at (4,10), 'N' at (6,16), 'b' at (8,20), 'h' at (8,20), 'K' at (9,29).

A. Description of original monument and accessories and/or subsequent restoration:

(E-1) Northeast corner of Section 5, Township 46 North, Range 2 East.

The original corner was placed in 1845 by John Mullett. 1919 County Surveyor notes call for corner and two witnesses, and give a distance South to 1/4 Corner of 2646.8 feet. In 1975, a B.L.M. dependent resurvey found and accepted an iron pin firmly set below the surface, at the intersection of a gravel road (East and West) and the projection of a fence line (North and South) and recites a distance South to 1/4 corner of 2646.6 feet. In 1987, William L. Karr, P.S. 27450 found a 1/2" iron pin in centerline of 6 Mile Road (East-West, gravel) and on the extension of a fenceline to North and recorded a L.C.R.C. in Liber 8, Page 264 of the Chippewa County Corner Records.

B. Description of corner evidence found and/or method applied in restoring or reestablishing corner:

(E-1) Northeast corner of Section 5, Township 46 North, Range 2 East.

This corner is being perpetuated as part of the Chippewa County Remonumentation Program. Found a 1/2" iron pin as recorded by Karr and also a 1-1/4" iron pipe. The 1/2" iron pin matched witnesses so the pipe was removed. Distance South to 1/4 Corner measures 2646.72 feet. Distance West to 1/4 Corner is 39.6 feet shorter than distance recited in B.L.M. Resurvey, but both B.L.M. corners have been recovered. We believe the distance recited on the B.L.M. resurvey to be a blunder. Accepted corner position as found and replaced 1/2" iron pin with a 3/4" x 24" rerod with Chippewa County Remonumentation plastic cap.

C. Description of monument for corner and accessories established to perpetuate locating the position of the corner:

(E-1) Northeast corner of Section 5, Township 46 North, Range 2 East.

Corner is a 3/4" x 24" rerod with Chippewa County Remonumentation plastic cap set 4" below grade and 2 feet South of centerline of East-West gravel road (Six Mile Road).

Witnesses:
8" Balsam Fir N13°W 50.19 feet
Utility Pole N66°E 72.71 feet
6" Cedar S48°E 55.60 feet
12" Yellow Birch S20°W 78.72 feet

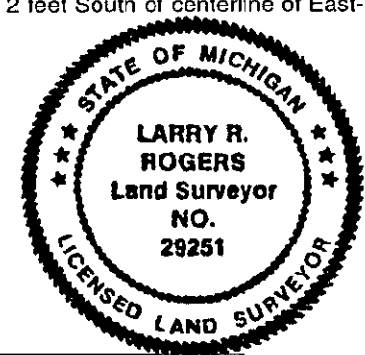
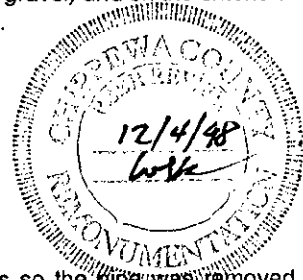

Signed by [Signature] Date 30 DEC 1998

Surveyor's Michigan License No. 29251

NOTE: All bearings are compass bearings corrected for declination (6°W). All distances are to a nail and tag in the side of witness object unless otherwise noted.