

MICHIGAN
DEPARTMENT OF CONSERVATION
FORESTRY DIVISION

LAND CORNER RECORD

T. 50N N.R. 6W

Chippewa COUNTY

DESCRIPTION OF CORNER Sec. Cor. for Secs. 31-32, on the 5th correction line

CORNER MONUMENT 1" pipe with 4" aluminum cap

DATE MONUMENT PLACED AND WITNESSED 6-15-69

WITNESSES TO CORNER..... 10" Jack Pine (S31 NBT) N6°W 23.2'

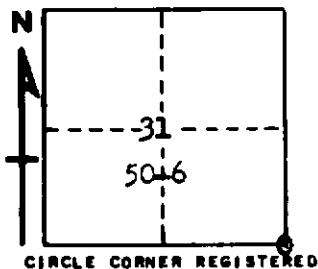

10" Jack Pine (S32 NBT) N75°E 16.1'

AND

DESCRIPTION IN DETAIL AS TO HOW CORNER WAS LOCATED AND IDENTIFIED OR RESTORED.

This corner replaced from two original witnesses; a jack pine, bearing N51°E, 46 links, tree down and badly rotted, with remains of both faces, scars and overgrowth. A jack pine, bearing N45°W, 47 links, only the stump bottom remains.

Found old blazes to east and west and north of this corner.

SURVEYOR'S SEAL

SIGNED *Billy D. Buckler*
Billy D. Buckler
REGISTERED LAND SURVEYOR

DATE 8-29-69