

SURVEY & MONUMENT

DEC 01 1995

COMMISSION

LAND CORNER RECORDATION CERTIFICATE

Filing Requirement of Act 74, Mich. P.A. 1970

RECEIVED
E 10 11 17 A L
95-95
95 OCT -3 PM 2:48
REGISTER OF DEEDS
CLARE COUNTY
DONNA M. CARR

For corners in CLARE Located In: _____ Corner Code # _____
(County)

1. Public Land Survey T 18N R 3W _____ H-7
T _____ R _____
T _____ R _____
T _____ R _____

2. Property Controlling S _____ T _____ R _____
in Section S _____ T _____ R _____

3. Miscellaneous S _____ T _____ R _____
Property in Section S _____ T _____ R _____

Register of Deeds Stamp & File Number

4. Lot No. _____, Recorded Plat _____
5. Private Claims _____

I, MARK R. ROBISON, in a field survey on JULY, 19 95, do hereby certify that under requirements of P.A. 74, Michigan P.A. of 1970, the corner points mentioned in lines 1 and 2 above were in conformance with regulations and rules therefore as required in the current manual of survey instructions of the United States Department of the Interior, Bureau of Land Management or by a decree of a Court of Law and/or that the corner points mentioned in lines 3, 4 and 5 above were in conformance with the rules of the Michigan Board of Professional Surveyors or by a Decree of a Court of Law; established, re-established, monumented, re-monumented, recovered, found as expressed below:

A	B	C	D	E	F	G	H	I	J	K	L	M
2	6	5	4	3	2	1						
3												
4	7	6	5	4	3	2	1					
5												
6	18	17	16	15	14	13						
7												
8	19	20	21	22	23	24						
9												
10	30	29	28	27	26	25						
11												
12	31	32	33	34	35	36						
13												

NOTE: Not more than 4 corners, all in the same town and range, may be recorded on this certificate.

- A. Description of original monument and accessories and/or subsequent restoration:
- 1856 CANNON - OLD COR POST, HEMLOCK 13 N63°W 23 1/2 HEMLOCK 20 S20°W 35
 - 06-79 LAPHAM FD 3/4"x3" BAR (MEAS 2619.55 EAST TO I-7) (132) SURVEY N20°E 30.85' FENCE POST NORTH 28.50' FENCE COR SOUTH 35.50' FENCE COR
 - 10-11 JOHNSON - NO COR MATERIAL FENCE POST 6 S 46, MEAS WEST 39.76' (GLO 39.41') TO G-7 AND EAST 39.76' (GLO 40.76') TO I-7
 - 09-79 LAPHAM SAME AS ABOVE LCRC
 - 09-88 LAPHAM SAME AS ABOVE (132) SURVEY

B. Description of corner evidence found and/or method applied in restoring or reestablishing corner:
FOUND 3/4"x3"x9" IRON BAR 4 FEET NORTH OF CENTER-LINE OF ROAD ON FENCE LINES EXTENDED NORTH & SOUTH. FOUND WITNESSES PER (132) SURVEY & L.C.R.C. MEASURED WEST 2628.71 TO G-7 & EAST (REC & MEAS) 2619.55 TO I-7 DEF ANGLE TO SOUTH IS 1°28'30", THE MEASURED DISTANCE BETWEEN SECTION CORNERS IS THE SAME AS THE C.S.R. RECORD AND 43 FEET SHORT OF THE G.L.O. RECORD. IT APPEARS THAT IN 1911 THE COUNTY SURVEYOR FOUND OR SET THIS CORNER MID-WAY BETWEEN SECTION CORNERS, RATHER THAN THE PROPORTIONATE MEASURE INDICATED BY G.L.O. THE FENCES AND IRON FOUND AT THIS LOCATION ARE 4 1/2 FEET OFF MID-POINT BETWEEN SECTION CORNERS.

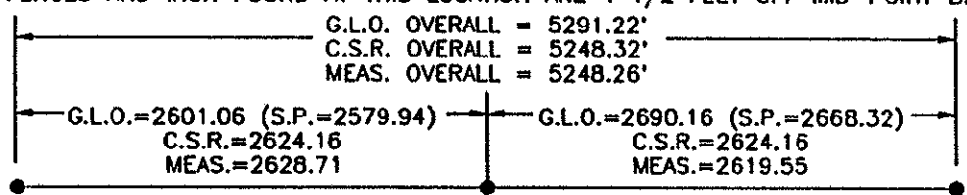

This Corner established in Clare County Remonumentation Program. See dossier for detailed report.

- C. Description of monument for corner and accessories established to perpetuate locating the position of the corner:
H-7, 15-22 1/4 COR.
SET 5/8"x 36" RE ROD WITH 3" CLARE COUNTY MONUMENT CAP.
ACCEPTED AS BEST AVAILABLE EVIDENCE OF THE ACCEPTED POSITION OF THE CORNER
- S10°W 37.90' N&T IN 10" ELM
 - S07°E 46.83' N&T IN 12" NORWAY
 - S40°E 49.80' N&T IN 18" JACK PINE
 - NORTH 28.50' SPIKE IN FENCE POST (OLD)
 - SOUTH 35.50' SPIKE IN FENCE POST (OLD)

APPROVED LAND CORNER
P.A. 345 of 1990
Clare County
Chairman *David Spill*
Date 9-26-95



Signed by Mark R. Robison Date 10-02-95
Surveyor's Michigan License No. 27458