

RECEIVED
ELECTRONIC
100-95

DEC 1 1995

LAND CORNER RECORDATION CERTIFICATE

Filing Requirement of Act 74, Mich. P.A. 1970

RECEIVED
ELECTRONIC
100-95
95 OCT -3 PM 2:49

REGISTER OF DEEDS
CLARE COUNTY
DONNA M. CARR

For corners in CLARE Located In: _____ Corner Code # _____
(County)

1. Public Land Survey T 18N R 3W _____ M-7
T _____ R _____
T _____ R _____
T _____ R _____

2. Property Controlling S _____ T _____ R _____
in Section S _____ T _____ R _____

3. Miscellaneous S _____ T _____ R _____
Property in Section S _____ T _____ R _____

Register of Deeds Stamp & File Number

4. Lot No. _____, Recorded Plat _____
5. Private Claims _____

A	B	C	D	E	F	G	H	I	J	K	L	M
2	6	5	4	3	2	1						
3												
4	7	8	9	10	11	12						
5												
6	18	17	16	15	14	13						
7												
8	19	20	21	22	23	24						
9												
10	30	29	28	27	26	25						
11												
12	31	32	33	34	35	36						
13												

I, MARK R. ROBISON, in a field survey on JULY, 19 95
do hereby certify that under requirements of P.A. 74, Michigan P.A. of 1970, the corner points mentioned
in lines 1 and 2 above were in conformance with regulations and rules therefore as required in the current
manual of survey instructions of the United States Department of the Interior, Bureau of Land
Management or by a decree of a Court of Law and/or that the corner points mentioned in lines 3, 4 and
5 above were in conformance with the rules of the Michigan Board of Professional Surveyors or by a
Decree of a Court of Law; established, re-established, monumented, re-monumented, recovered, found
as expressed below:

NOTE: Not more than 4 corners, all in the same town and range, may be recorded on this certificate.

- A. Description of original monument and accessories and/or subsequent restoration:
- 1838 NICHOLSON - TWP. LINES 8-77 SEDGMAN FIELD NOTES FROM P.B.L. & A. FILES
 - 1856 CANNON- POST, BEECH 6 S41°W 25 11-77 SEDGMAN SET 1/2" BAR AT INT OF N-S ROAD & FENCE EAST. LCRC
 - LYNN 9 N65°W 44 EAST 21.42' COR FENCE POST
 - 1909 NO SURVEYOR OR CORNER MATERIAL IDENTIFIED - S65°W 50.13' 4" ELM
 - FENCE POST 8 S83°E 47 CSR N55°W 59.73' FENCE POST
 - 4-72 URBANIAK, DRAWING FROM PAUL B. LAPHAM & ASSOC. FILES INDICATES CORNER FALLS ON FENCE LINE TO EAST. (G.L.O. INDICATE COMMON CORNERS) N30°E 49.67' 4" ELM.
- B. Description of corner evidence found and/or method applied in restoring or reestablishing corner:
FOUND 1/2"x18" RE-BAR IN CENTER-LINE OF GRAVEL ROAD ON EXTENSION OF FENCE TO EAST AND IN CENTER-LINE OF ABANDONED ROAD TO THE WEST. THERE IS A FENCE LINE TO WEST 33 FEET NORTH OF THE CORNER. A BRUSH ROW TO WEST IS APPROXIMATELY 28 FEET SOUTH OF THE CORNER. FOUND WITNESSES PER LCRC.

APPROVED LAND CORNER
P.A. 345 of 1990
Clare County
Chairman Paul A. Lapham
Date 9-26-95

This Corner established in Clare County Remonumentation Program.
See dossier for detailed report.

- C. Description of monument for corner and accessories established to perpetuate locating the position of the corner:
- M-7 13-24 SEC CORNER ON TWP. LINE
 - SET 5/8"x36" RE-ROD WITH 3" CLARE COUNTY MONUMENT CAP.
 - ACCEPTED AS BEST AVAILABLE EVIDENCE OF ACCEPTED POSITION OF THE CORNER.
 - EAST 21.42' N&T COR FENCE POST (OBT)
 - N52°W 59.73' N&T 3RD FENCE POST (OBT)
 - N30°E 49.67' N&T 12" ELM, CLUMP OF 3 (OBT)
 - S39°E 42.52' N&T 14" ELM

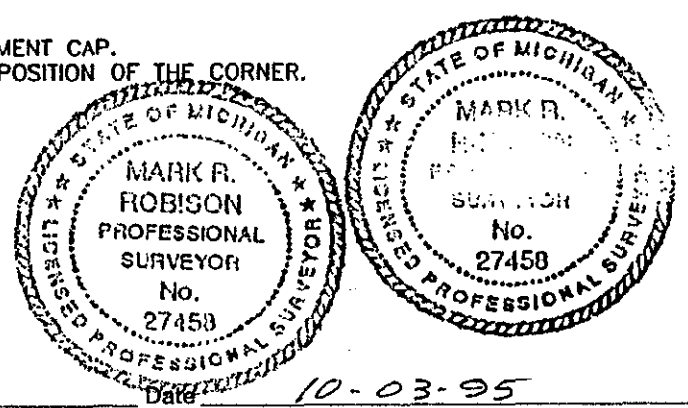

Signed by Mark R. Robison
Surveyor's Michigan License No. 27458

Date 10-03-95