

**LAND CORNER RECORDATION CERTIFICATE**  
**Filing Requirement of Act 74, Mich. P.A. 1970**

For corners in

<u>CLARE</u> <small>(County)</small>	Located In:	Corner Code #/
1. Public Land Survey	T <u>20N</u> R <u>5W</u>	<u>L-7</u>
	T _____ R _____	_____
	T _____ R _____	_____
	T _____ R _____	_____
2. Property Controlling in Section	S _____ T _____ R _____	_____
	S _____ T _____ R _____	_____
3. Miscellaneous Property in Sec.	S _____ T _____ R _____	_____
	S _____ T _____ R _____	_____
4. Lot No. _____, Recorded Plat _____		
5. Private Claims _____		

Register of Deeds Stamp & File Number

A	B	C	D	E	F	G	H	I	J	K	L	M
2	6	5	4	3	2	1						
3												
4	7	8	9	10	11	12						
5												
6	18	17	16	15	14	13						
7												
8	19	20	21	22	23	24						
9												
10	30	29	28	27	26	25						
11												
12	31	32	33	34	35	36						
13												

I, C. F. ROSER, in a field survey on 01-18, 19 92, do hereby certify that under requirements of P.A. 74, Michigan P.A. of 1970, the corner points mentioned in lines 1 and 2 above were in conformance with regulations and rules therefore as required in the current manual of survey instructions of the United States Department of the Interior, Bureau of Land Management or by a decree of a Court of Law and/or that the corner points mentioned in lines 3, 4 and 5 above were in conformance with the rules of the Michigan Board of Land Surveyors or by a Decree of a Court of Law; established, re-established, monumented, re-monumented, recovered, found as expressed below:

**NOTE: Not more than 4 corners, all in the same town and range, may be recorded on this certificate.**

A. Description of original monument and accessories and/or subsequent restoration:

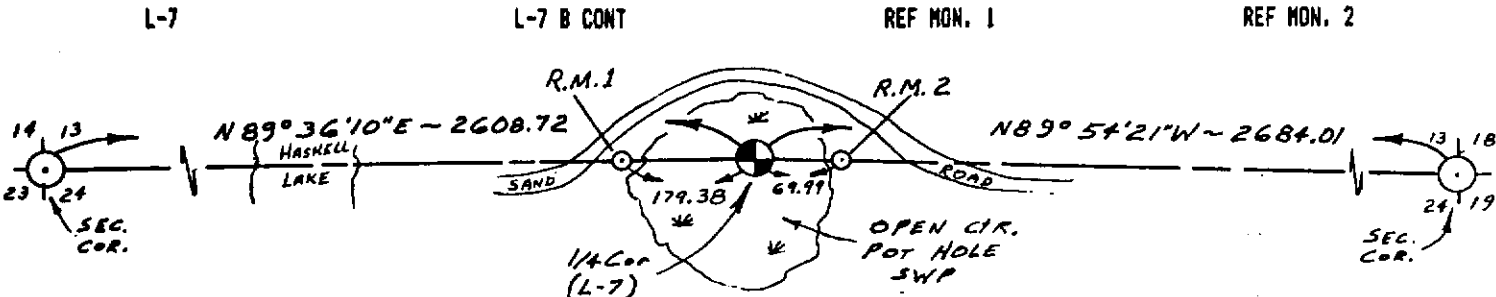

B. Description of corner evidence found and/or method applied in restoring or reestablishing corner:

<b>L-7</b> FD 3" SQ'D CED POST, LEANING (ON 1-03-89) APPROX 2' ABOVE ICE (2 1/2' OF ICE & WATER IN MUCK SWP POT HOLE) AS SET BY M. SCHAAF (4-29-43) FROM USBT (CED STUMP) S.E. AND FROM US ENT. SWP 2 CH'S TO WEST (FITS EXACT) AND US LV. SWP 0.75 CH'S TO EAST (FITS EXACT); FD 3" SQ'D CED ALSO FITS SCHAAF'S N.B.T. (N.PINE STP 22", N03 W, 62'- WE MEA. 61.8').	<b>L-7 B CONT</b> ON 4-04-91, WE REPLACED THE FD SQ'D CED POST WITH (DROVE) 1"x 96" GALV. IR PIPE WITH ALUM. DNR CAP, AND DROVE A 6' STUDDED ST FN POST WELDED ON A 1"x 96" GALV IR PIPE (ST FN POST ON TOP) AS A GUARD POST ALONG SIDE ABOVE DESCRIBED DNR MON. SINCE THE ABOVE DESCRIBED MON (L-7) IS BASICALLY INACCESSIBLE (WATER & MUCK-YOU CAN SINK TO YOUR ARM PITS),
---	---

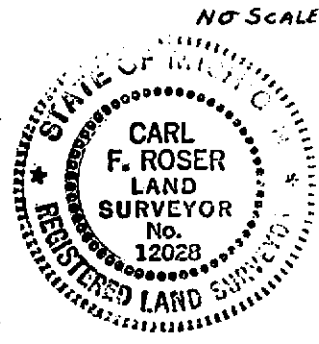

C. Description of monument for corner and accessories established to perpetuate locating the position of the corner:

<b>L-7</b> FD CEDAR POST, DROVE 1"x 96" GALV PIPE W/ALUM DNR CAP & STEEL FN POST WELDED ON 1" PIPE. REF MON 1-DROVE 5/8"x 34" REROD W/RLS CAP & SET CEDAR POST. 889 36' W 179.38' REF MON 2-DROVE 5/8"x 34" REROD W/RLS CAP & SET CEDAR POST. 889 54' E 69.99'	<b>L-7 B CONT</b> WE SET AND WITNESSED REFERENCE MONUMENTS "1" AND "2" AS NOTED TO RIGHT. REF MON. 1 179' W. OF L-7 DROVE 5/8"x 34" REROD W/RLS CAP, SET CEDAR POST. 26" N.PINE N55 W 41.51' 5" MAPLE N60 E 18.64' 4" N.PINE SOUTH 8.55' S1/4 COR SEC 13, DNR MON IN POND IS N89 36' E 179.38'	<b>REF MON. 2</b> 70' E. OF L-7 DROVE 5/8"x 34" REROD W/RLS CAP, SET CEDAR POST. 12" CEDAR N15 E 14.85' 5" W.OAK S80 E 29.13' 2" W.PINE S40 E 28.68' S1/4 COR SEC 13, DNR MON IN POND IS N89 54' W 69.99'
---	--	---

Signed by Carl F. Roser Date 02-24-92  
 Surveyor's Michigan License No. 12028