

SURVEY &  
REMONUMENTATION

FEB 02 1998

REMONUMENTATION

SECTION 7, BATH TOWNSHIP

SECTION

LAND CORNER RECORDATION CERTIFICATE

Filing Requirement of Act 74, Mich. P.A. 1970

RECORDED

For corners in

Clinton  
(County)

Located In:

Corner Code #

1. Public Land Survey	T	5N	R	1W	A-5
	T		R		
	T		R		
	T		R		
2. Property Controlling in Section	S		T	R	
	S		T	R	
3. Miscellaneous	S		T	R	
Property in Sec.	S		T	R	

Nov 4 1 25 PM '97

REGISTER OF DEEDS  
CLINTON COUNTY, MICH.

*Carole Woodley*

LIBER

4 PAGE 240

Register of Deeds Stamp & File Number

4. Lot No. \_\_\_\_\_, Recorded Plat \_\_\_\_\_  
5. Private Claims \_\_\_\_\_

I, Arden S. Pierson, PS, in a field survey on July 30 19 97, do hereby certify that under requirements of P.A. 74, Michigan P.A. of 1970, the corner points mentioned in lines 1 and 2 above were in conformance with regulations and rules therefore as required in the current manual of survey instructions of the United States Department of the Interior, Bureau of Land Management or by a decree of a Court of Law and/or that the corner points mentioned in lines 3, 4 and 5 above were in conformance with the rules of the Michigan Board of Land Surveyors or by a Decree of a Court of Law; established, re-established, monumented, re-monumented, recovered, found as expressed below:

NOTE: Not more than 2 corners, all in the same town and range, may be recorded on this certificate.

	A	B	C	D	E	F	G	H	I	J	K	L	M
1													
2	6	5	4	3	2	1							
3													
4	7	8	9	10	11	12							
5													
6	18	17	16	15	14	13							
7													
8	19	20	21	22	23	24							
9													
10	30	29	28	27	26	25							
11													
12	31	32	33	34	35	36							
13													

A. Description of original monument and accessories and/or subsequent restoration:

- ◆ Original survey by Hervey Parke, DS, 1826. Intersected Range Line 24 S. of Corner. Witnessed by: Hickory 6" - N-6½°E - 30 links; Hickory 9" - S70°E - 20 links.
- ◆ Survey by Chas Hollister, County Surveyor, dated September 6, 1880. Found stone set. Witnessed by: Sugar 18" - N32°W - 54-3/4 links, W. Oak 9" - S21½°E - 59-1/2 links.
- ◆ Clinton County Road Commission Field Book 24, survey by H.W. Coon, October 1926, PI at section corner common to Sections 7, 12, 13 and 18. Deflection = C°24' right, ¾" gal. iron pipe.
- ◆ Clinton County Survey Notes, stone, witnessed by: Maple 7" - N67°E - 125½ links; Maple 5" - N35°W - 56 links.

(OVER)

B. Description of corner evidence found and/or method applied in restoring or reestablishing corner:

1993 - Found ½" Rod, and accepted as a careful and faithful reestablishment of the position of the original corner.

Removed ½" rod and placed Standard Clinton County Monument.

Standard corner for T5N, R2W, is North 16.13'

(Alignment of Range Line not checked.)

APPROVED BY  
CLINTON COUNTY PEER GROUP  
DATED 8/20/97  
*J. J. J.*

C. Description of monument for corner and accessories established to perpetuate locating the position of the corner

Southwest Corner, Section 7

\*Standard Clinton County Monument and monument box

- DeWitt Twp. Corner - North - 16.13'
- Nail & tag #13039 power pole - N52°W - 164.73'
- Face of North Leg of arrow sign - N60°E - 23.29'
- S/W corner telephone riser box - S83°E - 30.80'
- N/E corner telephone riser box - S72°W - 46.87'

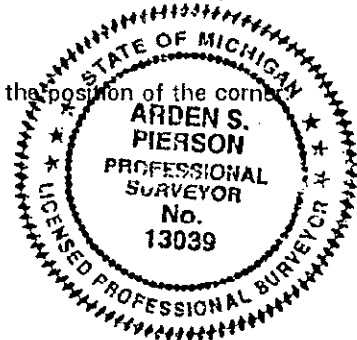

\*Standard Clinton County Monument is a 2½" diameter Steel tube 30" long with a stamped brass cap and a breakaway magnetic base.

Signed by *Arden S. Pierson*

Date July 31, 1997

Surveyor's Michigan License No. 13039

◆LCRC by Ronnie M. Lester, PS, #18998, dated August 13, 1975, Liber 1, Page 972. Excavated 4.0' deep at corner location and also Dewitt Township corner 15.84' to north. Found no physical evidence of monument in either location. Set ½" bar and cap on centerline of townline road and on old stump line to East. Measurements to North proportionately consistent. Measurement South long in first half mile. Witnesses:

Nail & tag in North side of anchor post - E.N.E. - 33.99'  
NE Corner Section 13, Dewitt Township - North - 15.84'  
Cut in South end of C.M.P. - W.S.W. - 44.65'  
Centerline of North rivet in North end of C.M.P. - N.N.W. - 59.52'

◆Certified Survey by James A. Porter, PS, #19003, dated April 29, 1992 (not recorded).

◆LCRC by Arden S. Pierson, PS, #13039, dated November 24, 1993, T5N, R2W, M-5, Liber 4, Page 3. Found ½" rod in centerline of Chandler Road and Herbison Road West. Closing distance agrees with existing monumentation. Accepted as corner position and removed ½" rod and placed Standard Clinton County Monument and monument box. Witnessed by:

N&T NE side cut off pole - S60°E - 35.31'  
N&T NE side Power Pole - N53°W - 157.65'  
NE Corner of Telephone Pole Riser Box - S60°W - 54.87'  
Face North Post Arrow Sign - S80°E - 18.48'