

REMONUMENTATION SECTION 7, DEWITT TOWNSHIP LAND CORNER RECORDATION CERTIFICATE Filing Requirement of Act 74, Mich. P.A. 1970

JAN 17 1996

For corners to COMMISSION Clinton (County)

Located In:

Corner Code #

RECORDED

Table with 3 columns: Description, T/R/S, and Corner Code #. Includes rows for Public Land Survey, Property Controlling, and Miscellaneous.

Dec 19 2 50 PM '95

REGISTER OF DEEDS CLINTON COUNTY, MICH.

LIBER 4, PAGE 112

Register of Deeds Stamp & File Number

4. Lot No. , Recorded Plat
5. Private Claims

Grid table with columns A-L and rows 1-13. A dot is marked in row 7, column A.

Arden S. Pierson P.S. in a field survey on September 12, 1995 do hereby certify that under requirements of P.A. 74, Michigan P.A. of 1970, the corner points mentioned in lines 1 and 2 above were in conformance with regulations and rules therefore as required in the current manual of survey instructions of the United States Department of the Interior, Bureau of Land Management or by a decree of a Court of Law and/or that the corner points mentioned in lines 3, 4 and 5 above were in conformance with the rules of the Michigan Board of Professional Surveyors or by a Decree of a Court of Law; established, re-established, monumented, re-monumented, recovered, found as expressed below:

NOTE: Not more than 4 corners, all in the same town and range, may be recorded on this certificate.

A. Description of original monument and accessories and/or subsequent restoration:

Original survey by Hervey Parke in 1827. (This corner was not set in original survey.)

Certified Boundary Survey Liber 1, Pages 293-294, by Ron Helsel #18994 dated February 5, 1973. (Lag Screw) Face of Concrete Anchor Post - East - 30.03' 6" Poplar - S85°W - 54.37' Double 18" Aspen - N10°E - 115' (OVER)

B. Description of corner evidence found and/or method applied in restoring or reestablishing corner:

Found lag screw - excavated and found stone down 2.0'. Accepted lag screw as a careful and faithful perpetuation of the position of the original corner.

Set Standard Clinton County Monument and monument box.

Standard corner is 50.21' south.

(The amended closing corner is 0.33' West of the closing corner monumented and described herein.)

C. Description of monument for corner and accessories established to perpetuate locating the position of the corner:

West 1/4 Corner, Section 7

- *Standard Clinton County Monument in monument box
West Face Concrete Anchor Post - East - 30.04'
Nail & Tag #13039 in NE Side Telephone Pole - N30°W - 55.01'
SE Corner Brick Face @ House Foundation - N55°W - 131.47'
NE Corner House Foundation - S53°W - 141.89'

*Standard Clinton County Monument is a 2 1/2" dia. steel tube 30" long with a stamped brass cap and a breakaway magnetic base.

Signed by Arden S. Pierson

Date October 28, 1995

Surveyor's Michigan License No. 13039

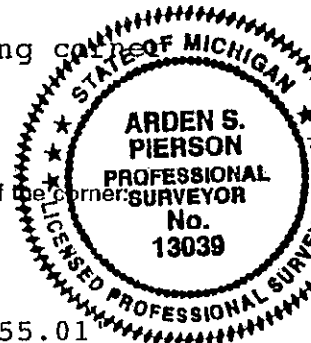

Certified Boundary Survey Liber 1, Page 519, by Ron Helsel #18994 dated August 19, 1974.

Certified Boundary Survey Liber 2, Page 364, by Richard Steadman #11370 dated February 9, 1981.

Lag screw
Concrete Anchor Post Face - East - 30.03'
6" Poplar - S85°W - 54.37'
Double 18" Aspen - N10°E - 115'

Certified Boundary Survey Liber 2, Page 639, by Richard Steadman #11370 dated December 14, 1983.

Found lag screw
Face of Concrete Anchor Post Face - East - 30.03'
6" Poplar - S85°W - 54.37'
Double 18" Aspen - N10°E - 115'