

SURVEY & REMONUMENTATION

FEB 02 1998

SECTION

**REMONUMENTATION
DEWITT TOWNSHIP
LAND CORNER RECORDATION CERTIFICATE
Filing Requirement of Act 74, Mich.P.A. 1970**

LIBER 004 PAGE 198

RECORDED

Oct 17 9 17 AM '97

**REGISTER OF DEEDS
CLINTON COUNTY, MICH.**

Carol Worley

For corners in

<u>Clinton</u> (County)	Located in:	Corner Code #
1. Public Land Survey	T <u>5N</u> R <u>2E</u>	<u>L-1</u>
	T _____ R _____	_____
	T _____ R _____	_____
	T _____ R _____	_____
2. Property Controlling In Section	S _____ T _____ R _____	_____
	S _____ T _____ R _____	_____
3. Miscellaneous Property in Sec.	S _____ T _____ R _____	_____
	S _____ T _____ R _____	_____
4. Lot No. _____	Recorded Plat _____	
5. Private Claims _____		

Register of Deeds Stamp & File Number

	A	B	C	D	E	F	G	H	I	J	K	L	M
2	6	5	4	3	2	1							
3													
4	7	8	9	10	11	12							
5													
6	18	17	16	15	14	13							
7													
8	19	20	21	22	23	24							
9													
10	30	29	28	27	26	25							
11													
12	31	32	33	34	35	36							
13													

VanRaemdonck, in a filed survey on August 21, 1997 do hereby certify that under requirements of P.A. 74, Michigan P.A. of 1970, the corner points mentioned in lines 1 and 2 above were in conformance with regulations and rules therefore as required in the current manual of survey instructions of the United States Department of the Interior, Bureau of Land Management or by a decree of a Court of Law and/or that the corner points mentioned in lines 3, 4 and 5 above were in conformance with the rules of the Michigan Board of Land Surveyors or by a Decree of a Court of Law; established, re-established, monumented, re-monumented, recovered, found as expressed below:

NOTE: Not more than 2 corners, all in the same town and range, may be recorded on this certificate.

A. Description of original monument and accessories and/or subsequent restoration:

Not a Glo corner

- Original: Glenn Fauser, Cert. Survey recorded L. 1, P. 860 2/7/77
Mon: 1/2" Bar Set 7.59 feet West of South 1/4 corner Section 36, T6N-R2W. (This is 1/2 of the G. L. O. Jog Distance at the Northwest corner of Section 1, T5N-R2W
Access: None given.
- Larry Bryan L.C.R.C. Rec. L. 2, P. 540 2/14/85
Mon: Found 1/2" bar
Access: P. K. Nail South side 12" Oak N20°E 28.17
P. K. Nail West side 18" Oak S70°E 28.45
Found 1/2" bar & cap #18657 South 1/4 corner Section 36, T6N-R2W East 7.63'
- L. Bryan, Cert. Survey Rec. L. 4, P. 155 4/4/83
Mon: 1/2" Rerod
Access: P. K. Nail South side 12" Oak N20°E 28.17
P. K. Nail West side 18" Oak S70°E 28.45
Found 1/2" bar & cap #18657 South 1/4 corner Section 36, T6N-R2W East 7.63'

B. Description of corner evidence found and/or method applied in restoring or re-establishing corner:

Found 1/2" rerod as referenced in No. 2 above. This location is 0.9' East of 1/2 the distance between corners M-1 and K-1 and is accepted as the careful and faithful establishment of the corner position. This position was not established by original government surveyors.

C. Description of monument for corner and accessories to perpetuate locating the position of the corner

Removed 1/2" rerod, replaced it with a standard Clinton County Remonumentation monument. The monument is witnessed by the following accessories:
S25E 32.05 Set Nail & Tag #24622 in W. face 24" Oak
S80E 29.17 Set Nail & Tag #24622 in SW face 18" Oak
N30E 16.74 Set Nail & Tag #24622 in W face 10" Cherry
S89°41'24"E 7.60 STD Clinton County Mon. at L-13, T6N-R2E
N89°41'24"W 2647.63 STD Clinton County Mon at K-1, T5N-R2E

NOTE: Monument is 660 feet more or less South of Round Lake Road.

Signed by *Mark L. Van Raemdonck*
Surveyor's Michigan License No. 24622

Date SEPT 29 1997

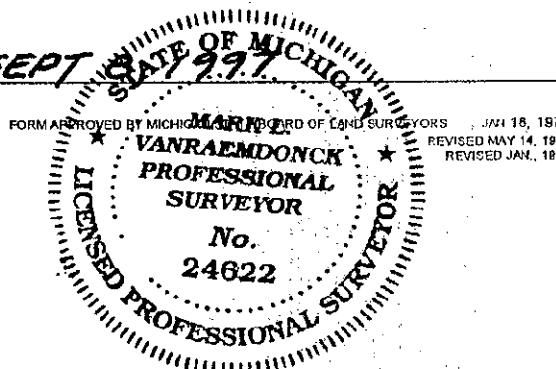

APPROVED BY
CLINTON COUNTY PEER GROUP
DATED 8/13/97
J 78