

9
2

Clinton County Remonumentation
South 1/4 Corner Section 32, T. 6N.-R. 1W., Victor Township
LAND CORNER RECORDATION CERTIFICATE
Filing Requirement of Act 74, Mich. P.A. 1970

004 PAGE 306

For corners in

<u>Clinton</u>	Located In:	Corner Code #
(County)		
1. Public Land Survey	T <u>6N</u> R <u>1W</u> D- <u>13</u>	
	T _____ R _____	
	T _____ R _____	
	T _____ R _____	
2. Property Controlling in Section	S _____ T _____ R _____	
	S _____ T _____ R _____	
3. Miscellaneous Property in Sec.	S _____ T _____ R _____	
	S _____ T _____ R _____	

RECORDED

DEC 28 3 48 PM '98

REGISTER OF DEEDS
CLINTON COUNTY, MICH.
Carol Worley

Register of Deeds Stamp & File Number

4. Lot No. _____, Recorded Plat _____

5. Private Claims _____

I, Samuel J. Clark, in a field survey on July 23, 1998 do hereby state that under requirements of P.A. 74, Michigan P.A. of 1970, the corner points mentioned in lines 1 and 2 above were in conformance with regulations and rules therefore as required in the current manual of survey instructions of the United States Department of the Interior, Bureau of Land Management or by a decree of a Court of Law and /or that the corner points mentioned in lines 3, 4 and 5 above were in conformance with the rules of the Michigan Board of Land Surveyors or by a Decree of a Court of Law; established, re-established, monumented, recovered, found as expressed below:

1	B	C	D	E	F	G	H	I	J	K	L	M
2	6		5		4		3		2		1	
3												
4	7		8		9		10		11		12	
5												
6	18		17		16		15		14		13	
7												
8	19		20		21		22		23		24	
9												
10	30		29		28		27		26		25	
11												
12	31		32		33		34		35		36	
13												

NOTE: Not more than 2 corners, all in the same town and range, may be recorded on this certificate.

A. Description of original monument and accessories and/or subsequent restoration:

D-13 South 1/4 corner Section 32, T.6 N.-R.1 W., Victor Twp.

Originally surveyed in 1826 by Lucius Lyon, Deputy Surveyor.
with the following witnesses:
5" Maple N.53-1/2°E., 57 lks
5" Tamarack N.57°W., 68 lks.

(Over)

B. Description of corner evidence found and/or method applied in restoring or reestablishing corner:

D-13 South 1/4 corner Section 32, T.6 N.-R.1 W., Victor Twp.

Found 1/2" Rerod and the following witnesses:
N82°E 42.76' Pinch pipe
N60°E 63.76' N & T face util. pole
S30°E 60.25' N & T face 36" Oak
and accepted as a careful and faithful perpetuation of the position of the original corner.

C. Description of monument for corner and accessories established to perpetuate locating the position of the corner:

D-13 South 1/4 corner Section 32, T.6 N.-R.1 W., Victor Twp.

*Set Standard Clinton County Monument

N82°E 42.76' Pinch pipe
N60°E 63.76' N & T face util. pole
S30°E 60.25' N & T face 36" Oak

Standard Clinton Co. Monument at C-13, Victor Twp., N.89°-58'-42"W., 2654.16'
*Standard Clinton County Monument being a 2 1/2" Diameter Steel Tube, 30" long, with a stamped brass cap, restamped #41096, and breakaway magnetic base.

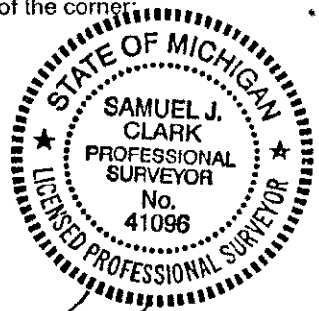

Signed by Samuel J. Clark Date 10/26/98
Surveyor's Michigan License No. 41096

APPROVED BY
CLINTON COUNTY PEER GROUP
DATED 9/23/98
878

- ◆ Rec'd survey by L. J. Hendrix, #3276, August 30, 1972, L. 1, Pg. 261 of Surveys
no description of corner, no witnesses provided
- ◆ Rec'd survey by L. J. Hendrix, #3276, August 30, 1972, L. 1, Pg. 262 of Surveys
no description of corner, no witnesses provided
- ◆ Rec'd survey by M. Van Raemdonck, #26422, July 16, 1991, L. 4, Pg. 275 of Surveys
Set 1/2" rerod 18" long with cap #26422 at intersection of apparent N-S 1/4 line extended and
North line of Section 5, Bath Twp. as established by A. Pierson, L. 1, Pg. 263 of surveys
N82°E 42.76' Pinch pipe
N60°E 63.76' Set N& T face utl. pole
S30°E 60.25' Set N& T face 36" Oak
West 33.00' Rerod & Cap #26422
- ◆ Rec'd survey by M. Van Raemdonck, #26422, July 16, 1991, L. 4, Pg. 320 of Surveys
Set 1/2" rerod 18" long with cap #26422 at intersection of apparent N-S 1/4 line extended and
North line of Section 5, Bath Twp. as established by A. Pierson, L. 1, Pg. 263 of surveys
N82°E 42.76' Pinch pipe
N60°E 63.76' Set N& T face utl. pole
S30°E 60.25' Set N& T face 36" Oak
West 33.00' Rerod & Cap #26422
- ◆ Rec'd survey by M. Van Raemdonck, #26422, July 16, 1991, L. 4, Pg. 326 of Surveys
Set 1/2" rerod 18" long with cap #26422 at intersection of apparent N-S 1/4 line extended and
North line of Section 5, Bath Twp. as established by A. Pierson, L. 1, Pg. 263 of surveys
N82°E 42.76' Pinch pipe
N60°E 63.76' Set N& T face utl. pole
S30°E 60.25' Set N& T face 36" Oak
West 33.00' Rerod & Cap #26422

SURVEY &
RECORDS SECTION

FEB 18 1999

SECTION