

SURVEY & REMONUMENTATION

MAR 21 1997

COMMISSION

REMONUMENTATION
SECTIONS 16, 17, 20 & 21, OLIVE TOWNSHIP
LAND CORNER RECORDATION CERTIFICATE
 Filing Requirement of Act 74, Mich. P.A. 1970

For corners in

<u>Clinton</u> (County)	Located In:	Corner Code #
1. Public Land Survey	T <u>6N</u> R <u>2W</u>	<u>E-7</u>
	T ___ R ___	_____
	T ___ R ___	_____
	T ___ R ___	_____
2. Property Controlling in Section	S ___ T ___ R ___	_____
	S ___ T ___ R ___	_____
3. Miscellaneous Property in Sec.	S ___ T ___ R ___	_____
	S ___ T ___ R ___	_____

RECORDED

OCT 11 8 53 AM '96

REGISTERED DEEDS
 CLINTON COUNTY, MICH.
Carrie Winkley

LIBER 4, PAGE 170

Register of Deeds Stamp & File Number

4. Lot No. _____, Recorded Plat _____
 5. Private Claims _____

I, Arden S. Pierson P.S., in a field survey on August 13, 19 96 do hereby state that under requirements of P.A. 74, Michigan P.A. of 1970, the corner points mentioned in lines 1 and 2 above were in conformance with regulations and rules therefore as required in the current manual of survey instructions of the United States Department of the Interior, Bureau of Land Management or by a decree of a Court of Law and/or that the corner points mentioned in lines 3, 4 and 5 above were in conformance with the rules of the Michigan Board of Land Surveyors or by a Decree of a Court of Law; established, re-established, monumented, recovered, found as expressed below:

	A	B	C	D	E	F	G	H	I	J	K	L	M
1													
2	6		5		4		3		2		1		
3													
4	7		8		9		10		11		12		
5													
6	18		17		16		15		14		13		
7													
8	19		20		21		22		23		24		
9													
10	30		29		28		27		26		25		
11													
12	31		32		33		34		35		36		
13													

NOTE: Not more than 2 corners, all in the same town and range, may be recorded on this certificate.

A. Description of original monument and accessories and/or subsequent restoration:

- ◆ Original survey by Hervey Parke, DS, 1826. Set Post Corner Sections 16, 17, 20 and 21. Witnessed by: Y. Oak 24" - S30°W - 39 links; W. Oak 12" - N35°E - 24 links.
- ◆ Certificate of Survey by James E. Stephens, PS, #16053, dated May 25, 1973, Liber 1, page 328. 1/2" pipe witnessed by:
 - Survey tag nailed to the South side of a 12" Hickory tree - N22°10'W - 53.83'
 - Survey tag nailed to the North side of a utility pole - S33°21'E - 60.88'
 - Survey tag nailed to the North side of a 24" Hickory tree - S63°50'W - 53.0'

(OVER)

B. Description of corner evidence found and/or method applied in restoring or reestablishing corner:

Found 1/2" rod in physical centerline road. Removed 1/2" rod - found 1/2" pipe down 14". Accepted as a careful and faithful reestablishment of the position of the original corner. (Pratt and Loomis Roads)

*Set Standard Clinton County Monument and monument box.

C. Description of monument for corner and accessories established to perpetuate locating the position of the corner

- Corner Common to Sections 16, 17, 20 & 21**
- *Set Standard Clinton County Monument and monument box.
- Nail & tag #13039 in SW side Telephone and Power Pole - S26°E - 61.13'
- Nail & tag #13039 in SE side Telephone Pole - N85°E - 167.85'
- SW Corner House Foundation - N48°E - 122.09'
- SE Corner Telephone Pedestal - N55°W - 48.78'

*Standard Clinton County Monument is a 2 1/2" dia. Steel tube 30" long with a stamped brass cap and a breakaway magnetic base.

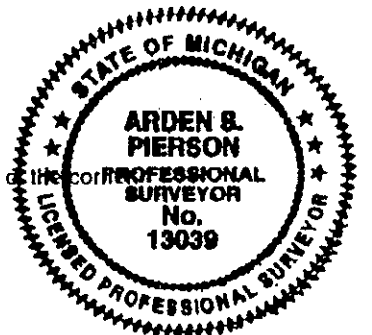

Signed by *Arden S. Pierson*
 Surveyor's Michigan License No. 13039

Date August 15, 1996

APPROVED BY
 CLINTON COUNTY PEER GROUP
 DATED 8/21/96
SFR

- ◆ Certificate of Survey by James E. Stephens, PS, #16053, dated July 17, 1973, Liber 1, page 348. 1/2" pipe witnessed by:
 - Survey tag nailed to the South side of a 12" Hickory tree - N22°10'W - 53.83'
 - Survey tag nailed to the North side of a utility pole - S33°21'E - 60.88'
 - Survey tag nailed to the North side of a 24" Hickory tree - S63°50'W - 53.0'

- ◆ LCRC by James E. Stephens, PS, #16053, dated September 18, 1973, Liber 1, page 685. A 1/2" iron pipe was found in the centerline of the two section line roads (Pratt Road and Loomis Road). Witnessed by:
 - Survey tag in the South side of a 12" Hickory tree - N22°10'W - 53.83'
 - Survey tag in the North side of a utility pole - S33°21'E - 60.88'
 - Survey tag in the North side of a 24" Hickory tree - S63°50'W - 53.0'
 - The bearing of the West section line is N0°37'20"W and is from Hwy. Survey of U.S. 27.

- ◆ Certificate of Survey by Fred White, PS, #12034, dated February 11, 1981, Liber 2, pages 402, 404-410.

- ◆ Certificate of Survey by Fred White, PS, #12034, dated June 9, 1981, Liber 2, page 417.

- ◆ Certificate of Survey by Fred White, PS, #12034, dated August 1985, Liber 2, pages 840-843.

- ◆ Certified Survey by Bruce Floyd, PS, #28068, dated October 29, 1986, Liber 2, pages 988-989.

- ◆ Certificate of Survey by Douglas Richardson, PS, #31603, dated December 17, 1986, Liber 3, pages 87-88.

- ◆ Certificate of Survey by Ronnie Lester, PS, #18998, dated May 1989, Liber 3, pages 371-374. 1/2" bar over pipe. Witnessed by:
 - Set nail and tag in West side 12" Maple - 30° az. - 75.9'
 - Found Stephens nail and tag in North side utility pole - 152° az. - 60.8'
 - SW corner block foundation, house #1960 - 49° az. - 122.0'
 - Set nail and tag in West side utility pole - 14° az. - 179.5'