

**SURVEY &
REMONUMENTATION**

MAR 21 1997

**REMONUMENTATION
SECTION 6, WATERTOWN TOWNSHIP
LAND CORNER RECORDATION CERTIFICATE
Filing Requirement of Act 74, Mich. P.A. 1970**

COMMISSION

RECORDED

For corners in

Clinton (County)	Located In:	Corner Code #
1. Public Land Survey	T 5N R 3W	A-1
	T 5N R 4W	M-1
	T 6N R 3W	A-13
	T 6N R 4W	M-13
2. Property Controlling in Section	S T R	
	S T R	
3. Miscellaneous Property in Sec.	S T R	
	S T R	

OCT 11 8 52 AM '96

REGISTER OF DEEDS
CLINTON COUNTY, MICH.
Wanda W. W...

LIBER 4, PAGE 159

Register of Deeds Stamp & File Number

4. Lot No. _____, Recorded Plat _____
5. Private Claims _____

I, Arden S. Pierson P.S., in a field survey on August 16, 1996 do hereby state that under requirements of P.A. 74, Michigan P.A. of 1970, the corner points mentioned in lines 1 and 2 above were in conformance with regulations and rules therefore as required in the current manual of survey instructions of the United States Department of the Interior, Bureau of Land Management or by a decree of a Court of Law and/or that the corner points mentioned in lines 3, 4 and 5 above were in conformance with the rules of the Michigan Board of Land Surveyors or by a Decree of a Court of Law; established, re-established, monumented, recovered, found as expressed below:

NOTE: Not more than 2 corners, all in the same town and range, may be recorded on this certificate.

	A	B	C	D	E	F	G	H	I	J	K	L	H
1													
2	6			5			4		3		2		1
3													
4	7			8			9		10		11		12
5													
6	19			17			16		15		14		13
7													
8	19			20			21		22		23		24
9													
10	30			29			28		27		26		25
11													
12	31			32			33		34		35		36
13													

A. Description of original monument and accessories and/or subsequent restoration:

- ◆ Original survey by Lucius Lyon, DS, 1826. Set temporary post, not witnesses given.
- ◆ Survey by Hervey Parkc, DS, 1826, T6N, R3W, W. Bdrs. 4 links South of temporary post. Witnesses: Beech 8" - S52°E - 28 links; Beech 8" - N64°W - 46 links.
- ◆ County Surveyor Witness Book, set large stone, witnessed by: Lynn 18" - N40°E - 18 links.

(OVER)

B. Description of corner evidence found and/or method applied in restoring or reestablishing corner:

Found railroad spike filed in LCRC by Art Ivy, PS. Excavated hole 3' x 3' — 3' deep, found nothing. Accepted railroad spike as a careful and faithful reestablishment of the position of the original corner, and set Standard Clinton County Monument*.

(Best available evidence of the position of corner.)

(This corner is common to Eagle, Watertown, Westphalia, and Riley Townships.)

C. Description of monument for corner and accessories established to perpetuate locating the position of the corner:

NW Corner, Section 6

- *Set Standard Clinton County Monument
- Nail & tag #13039 in SW side Power Pole - N57°W - 142.86'
- Nail & tag #13039 in E. Side 4" Hickory - N20°E - 24.41'
- SE Corner of House Foundation - N26°W - 141.40'
- Nail & tag #13039 in W. side Power Pole - N02°E - 70.20'

*Standard Clinton County Monument is a 2½" dia. Steel tube 30" long with a stamped brass cap and a breakaway magnetic base.

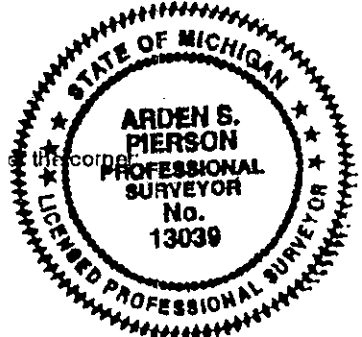

Signed by Arden S. Pierson
Surveyor's Michigan License No. 13039

Date August 24, 1996

APPROVED BY
CLINTON COUNTY PEER GROUP
DATED 8/21/96
1178

FORM APPROVED BY MICHIGAN STATE BOARD OF PROFESSIONAL SURVEYORS, JAN. 28, 1971
REVISED MAY 14, 1971
REVISED JAN. 1981
REVISED OCT., 1981

◆ Certified Boundary Survey by Duane Ankrom, PS, #21265, dated February 1977, Liber 1, pages 869-871. Found R.R. spike, witnessed by:

40" Ash - N15°E - 16.18'
Fence post - North - 33.54'
St. sign - N5°W - 22.73'

◆ LCRC by Arthur Ivey, PS, #6519, dated September 2, 1980, Liber 2, page 324, T6N, R3W, Riley Township, A-13. Found RR spike in gravel road (Cutler), in line with section line fence post. Also a Consumer's Power tag on anchor post. Witnesses:

Tagged Consumer's Power reference nail in west side of anchor post - North - 33.47'
Tagged nail (#6519) in SE side 42" White Oak - N25°E - 15.94'
Tagged nail (#6519) in NE side 1" Hickory - S45°E - 47.93'