

MICHIGAN
DEPARTMENT OF CONSERVATION
FORESTRY DIVISION

LAND CORNER RECORD

T. 28 N.R. 2 W

CRAWFORD COUNTY

DESCRIPTION OF CORNER 1/4 Corner common to Sections 30-31

CORNER MONUMENT Set. Dept. Mon.

DATE MONUMENT PLACED AND WITNESSED 10-30-68

WITNESSES TO CORNER.....

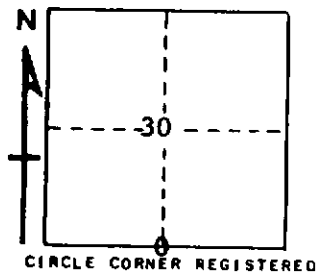

9" Tamarack N 35 W 92.0'
7" Poplar S 80 E 2.0'
AND
2" Spruce S 33 E 21.1'

DESCRIPTION IN DETAIL AS TO HOW CORNER WAS LOCATED AND IDENTIFIED OR RESTORED.

This corner was set by proportionate measurement, and on line over meander corner and section corner East. Checks lakeshore and E. Branch AuSable River very well for measurement. Could find nothing previously established, although G. F. DeLaMater had a partial survey of this section.

SURVEYOR'S SEAL

SIGNED *Kenneth J. Bell* DATE 6/9/69
REGISTERED LAND SURVEYOR 10068