

APR 27 1995

COMMISSION

CRAWFORD COUNTY
PEER GROUP APPROVAL
Date DEC 22, 1994
Marvin E. Myers
Marvin E. Myers, P.S.

LIBER 3 PAGE 208

CRAWFORD COUNTY REMONUMENTATION
LAND CORNER RECORDATION CERTIFICATE
Filing Requirement of Act 74, Mich. P.A. 1970

For corners in

ALSO ACT 345, PA 1990

STATE OF MICHIGAN
CRAWFORD COUNTY
RECORDED

10 FEB 95 8:42 A.M.

ELIZABETH H. WIELAND
REGISTER OF DEEDS

Register of Deeds Stamp & File Number

CRAWFORD (County)	Located In:	Corner Code #
1. Public Land Survey	T <u>28N</u> R <u>3W</u>	<u>G-9</u>
	T _____ R _____	_____
	T _____ R _____	_____
	T _____ R _____	_____
2. Property Controlling in Section	S _____ T _____ R _____	_____
	S _____ T _____ R _____	_____
3. Miscellaneous Property in Sec.	S _____ T _____ R _____	_____
	S _____ T _____ R _____	_____
4. Lot No. _____, Recorded Plat _____		
5. Private Claims _____		

	A	B	C	D	E	F	G	H	I	J	K	L	M
2	6		5		4		3		2		1		
3													
4	7		8		9		10		11		12		
5													
6	18		17		16		15		14		13		
7													
8	19		20		21		22		23		24		
9													
10	30		29		28		27		26		25		
11													
12	31		32		33		34		35		36		
13													

I, Wayne E. Boss, in a field survey on December 8, 19 94, do hereby certify that under requirements of P.A. 74, Michigan P.A. of 1970, the corner points mentioned in lines 1 and 2 above were in conformance with regulations and rules therefore as required in the current manual of survey instructions of the United States Department of the Interior, Bureau of Land Management or by a decree of a Court of Law and/or that the corner points mentioned in lines 3, 4 and 5 above were in conformance with the rules of the Michigan Board of Land Surveyors or by a Decree of a Court of Law; established, re-established, monumented, re-monumented, recovered, found as expressed below:

NOTE: Not more than 4 corners, all in the same town and range, may be recorded on this certificate.

A. Description of original monument and accessories and/or subsequent restoration:

- | | | | |
|--|---|---|---|
| G.L.O. Walter Warner 1857
Re-established old corner
of Sections 21, 22, 27, & 28.
1. Beech 7 N72°E, 15 lks.
2. Beech 15 S20°W, 32 lks. | A.E. Newman gave new
wit. to cor.
1. Sugar 16 N42°W, 44'.
Newman's dist. to F-9
was 2640.0' | 5/8" bar of unknown origin
Fd. & Wit. by N. Parker 1973
Cor. Record L.1 pg. 44.
1. Stop Sign S50°W, 60.0'.
2. Power Pole S45°E, 56.5'.
3. 1/2" Bar East 33.0'. | 1/2" X 1/8" bar set in Mon
Box by M. Myers 1991 and
LCRC L.3 pg 21.
1. 10' ± North of .
2. Nail NE Face util. Pole
S34°E, 58.15'.
3. Nail S. Face fence pole
S82°E, 33.76'.
4. N. edge Stop Sign post
S72°W, 75.02'.
5. N. edge GTE Sign post
S46°W, 70.70'. |
|--|---|---|---|

B. Description of corner evidence found and/or method applied in restoring or reestablishing corner:

- Fd. 1/2" Bar in Mon. Box set by M. Myer 1991
- | | |
|--------------------------------------|--|
| 1. Fd. Spk. Fence Post East 33.88'. | G.L.O. Warner dist. to G-8 2661.12' Meas. 2664.87'. |
| 2. Fd. Spk. P.P. S40°E, 58.13'. | G.L.O. Warner dist. to G-10 2641.98' 2653.44' (N. Parker), Meas. 2657.46'. |
| 3. N.E. Cor. Tele Box S28°W, 70.15'. | G.L.O. Warner dist. to F-9 2676.96' Meas. 2711.62'. |
| 4. Stop Sign S66°W, 74.92'. | |

C. Description of monument for corner and accessories established to perpetuate locating the position of the corner:

- G-9 Crawford Co. Mon. Set in Mon. Box at exact location of 1/2" Ir. Bar.
1. Fd. Spk. in Fence Post East 33.88'.
 2. Fd. Spk. in P.P. S40°E, 58.13'.
 3. N.E. Cor. Tele Box S28°W, 70.15'.
 4. Stop Sign S66°W, 74.92'.

This position not established by original government surveyors. This monument is accepted as the best available evidence of the position of the corner.

Signed by Wayne E. Boss
Surveyor's Michigan License No. 20703

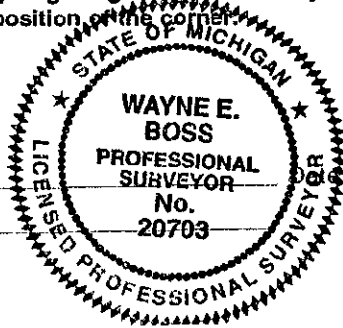

January 3, 1995