

SECTION

LAND CORNER RECORDATION CERTIFICATE  
Filing Requirement of Act 74, Mich. P.A. 1970

For corners in

CRAWFORD (County)	Located In:	Corner Code <i>77</i>
1. Public Land Survey	T <u>28N</u> R <u>3W</u>	<u>I-10</u>
	T _____ R _____	_____
	T _____ R _____	_____
	T _____ R _____	_____
2. Property Controlling in Section	S _____ T _____ R _____	_____
	S _____ T _____ R _____	_____
3. Miscellaneous Property in Sec.	S _____ T _____ R _____	_____
	S _____ T _____ R _____	_____

STATE OF MICHIGAN  
CRAWFORD COUNTY  
RECORDED

28 DEC 99 3:02 P.M.

SANDRA MOORE  
REGISTER OF DEEDS

Register of Deeds Stamp & File Number

- 4. Lot No. \_\_\_\_\_, Recorded Plat \_\_\_\_\_
- 5. Private Claims \_\_\_\_\_

**LIBER 4 PAGE 72**

I, Marvin E. Myers, in a field survey on April 9, 19 99, do hereby certify that under requirements of P.A. 74, Michigan P.A. of 1970, the corner points mentioned in lines 1 and 2 above were in conformance with regulations and rules therefore as required in the current manual of survey instructions of the United States Department of the Interior, Bureau of Land Management or by a decree of a Court of Law and/or that the corner points mentioned in lines 3, 4 and 5 above were in conformance with the rules of the Michigan Board of Land Surveyors or by a Decree of a Court of Law; established, re-established, monumented, re-monumented, recovered, found as expressed below:

A	B	C	D	E	F	G	H	I	J	K	L
2	6	5	4	3	2	1					
3											
4	7	8	9	10	11	12					
5											
6	18	17	16	15	14	13					
7											
8	19	20	21	22	23	24					
9											
10	30	29	28	27	26	25					
11											
12	31	32	33	34	35	36					
13											

**NOTE: Not more than 4 corners, all in the same town and range, may be recorded on this certificate.**

A. Description of original monument and accessories and/or subsequent restoration:

James H. Mullet, D.S.  
G.I.O. 1839  
Mon.-Post  
Wit: 10" Sugar Maple N75°W 21 links  
10" Sugar Maple N77°E 10 links

Norman F. Parker L.S.#16939  
Unrecorded survey of Section 26  
Mon: 1" Pipe  
Wit: fence East & West

Norman F. Parker R.L.S.#16939  
Liber 141, page 21 (dated 1974)  
Mon: 1" Pipe  
Wit: fence East & West

Norman F. Parker R.L.S.#16939  
Liber 179, page 38 (dated 1979)  
Mon: 1" Pipe  
Wit: ½" bar 33' West

B. Description of corner evidence found and/or method applied in restoring or reestablishing corner:

Found 1" pipe of record in the centerline of White Road North & South 0.7' below the asphalt surface in line with old fences East & West.  
Found ½" bar and old hub West 33' in old fence corner. Accepted as the best available evidence of the position of the original corner. Replaced pipe with Standard Crawford County Monument in pavement monument box.

**CRAWFORD COUNTY  
PEER GROUP APPROVAL  
DATE Sept 10, 1999**

*Marvin E. Myers*  
**Marvin E. Myers, P.S.  
County Surveyor**

C. Description of monument for corner and accessories established to perpetuate locating the position of the corner:

Mon: Standard Crawford County Corner in Monument box  
Wit: Set spike in 8" Elm S66°E 37.43'  
Set spike in 10" Maple S24°E 64.21'  
Set spike in 4" Scotch Pine S26°W 70.51'  
Found ½" bar in fence corner West 33.0'  
Set Carsonite Post West 33'

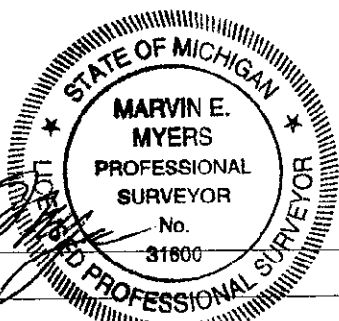

Signed by *Marvin E. Myers*  
Surveyor's Michigan License No. 31600

Date Dec 9, 1999