

STATE OF MICHIGAN  
 COUNTY OF CHARLEVOIX  
 RECEIVED FOR RECORD  
 1994 DEC 22 PM 1:59  
 Charlene M. Casbin  
 REGISTER OF DEEDS

2-317  
 CHARLEVOIX COUNTY REMONUMENTATION  
 LAND CORNER RECORDATION CERTIFICATE  
 Filing Requirement of Act 74, Mich. P.A. 1970  
 ALSO ACT 345, PA 1990

	Located In:	Corner Code #
1. Public Land Survey	T <u>32N</u> R <u>4W</u>	<u>A-9</u>
	T _____ R _____	_____
	T _____ R _____	_____
	T _____ R _____	_____
2. Property Controlling in Section	S _____ T _____ R _____	_____
	S _____ T _____ R _____	_____
3. Miscellaneous Property in Sec.	S _____ T _____ R _____	_____
	S _____ T _____ R _____	_____
4. Lot No. _____, Recorded Plat _____		
5. Private Claims _____		

Register of Deeds Stamp & File Number

	A	B	C	D	E	F	G	H	I	J	K	L	M
2	6	5	4	3	2	1							
3													
4	7	8	9	10	11	12							
5													
6	18	17	16	15	14	13							
7													
8	19	20	21	22	23	24							
9													
10	30	29	28	27	26	25							
11													
12	31	32	33	34	35	36							
13													

I, Wayne E. Boss, in a field survey on September 27, 19 94, do hereby certify that under requirements of P.A. 74, Michigan P.A. of 1970, the corner points mentioned in lines 1 and 2 above were in conformance with regulations and rules therefore as required in the current manual of survey instructions of the United States Department of the Interior, Bureau of Land Management or by a decree of a Court of Law and/or that the corner points mentioned in lines 3, 4 and 5 above were in conformance with the rules of the Michigan Board of Land Surveyors or by a Decree of a Court of Law; established, re-established, monumented, re-monumented, recovered, found as expressed below:

**NOTE: Not more than 4 corners, all in the same town and range, may be recorded on this certificate.**

- A. Description of original monument and accessories and/or subsequent restoration:
- |  |   |  |
|--|---|--|
| <b>Set Post corner Sec. 24 &amp; 25 (T32N-R5W also corner to Sec. 30 &amp; 19, T32N-R4W)</b> | <b>Re-wit. Sec. corner</b>                | <b>Conc. Mon. set June 1958 by Thomas Schweigert</b> |
| 1. Beech 8" N09°E 21   | 1. Beech 6" N08°E 22                      | 1. 5" H. Maple S59½°E 10.6'                          |
| 2. Beech 8" S36°W 18   | 2. Sugar 15" S33°E 18                     | 2. 16" H. Maple N16½°E 29.3'                         |
| John Mullett May 1840  | Burt 1850, E.K. Robinson added wit. 1902. |  |
|  | Beech 11" S87°E 15¾ Lks.                  |  |

B. Description of corner evidence found and/or method applied in restoring or reestablishing corner:

Corner location reestablished by Thomas Schweigert by proportional meas. N-E-W as shown in corner registry L1 page 13.  
 G.L.O. to A-8 2640 meas. 2645.22'  
 G.L.O. to A-10 2640 meas. 2647.54'

C. Description of monument for corner and accessories established to perpetuate locating the position of the corner:

- A-9 Found conc. mon. 300' North of clearing and 150' West of 2-track.
1. Fd. Spk. 5" Maple S08°W 9.50'
  2. Fd. Spk. 7" Maple S77°E 25.23'
  3. Set JLS Tag 13" Maple N55°E 18.48'
  4. Fd. Spk. 10" Maple N10°W 11.93'
- And is accepted as a careful and faithful reestablishment of the position of the original corner

Charlevoix Co. Surveyor  
**APPROVED**  
 Signature Wayne E. Boss  
 Date: December 14, 1994

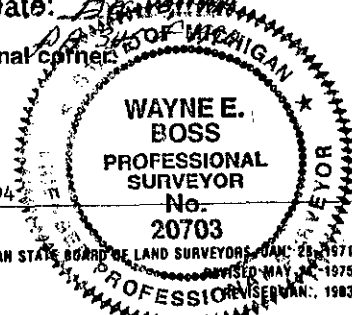

Signed by Wayne E. Boss, PS Date December 14, 1994  
 Surveyor's Michigan License No. 20703