

LAND CORNER RECORDATION CERTIFICATE
Filing Requirement of Act 74, Mich. P.A. 1970

For corners in

<u>Charlevoix</u> (County)	Located In:	Corner Code #
1. Public Land Survey	T _____ R _____	_____
	T _____ R _____	_____
2. Property Controlling in Section	S <u>24</u> T <u>32N</u> R <u>5W</u>	<u>3</u>
	S <u>24</u> T <u>32N</u> R <u>5W</u>	<u>5</u>
3. Miscellaneous Property in Sec.	S _____ T _____ R _____	_____
	S _____ T _____ R _____	_____

Register of Deeds Stamp & File Num

4. Lot No. _____, Recorded Plat _____

5. Private Claims _____

I, Carl T. Kiiskila, in a field survey on Feb. 10, 19 98 do hereby state that under requirements of P.A. 74, Michigan P.A. of 1970, the corner points mentioned in lines 1 and 2 above were in conformance with regulations and rules therefore as required in the current manual of survey instructions of the United States Department of the Interior, Bureau of Land Management or by a decree of a Court of Law and/or that the corner points mentioned in lines 3, 4 and 5 above were in conformance with the rules of the Michigan Board of Land Surveyors or by a Decree of a Court of Law; established, re-established, monumented, recovered, found as expressed below:

A	B	C	D	E	F	G	H	I	J	K	L	M
1												
2	6		5		4		3		2		1	
3												
4	7		8		9		10		11		12	
5												
6	18		17		16		15		14		13	
7												
8	19		20		21		22		23		24	
9												
10	30		29		28		27		26		25	
11												
12	31		32		33		34		35		36	
13												

NOTE: Not more than 2 corners, all in the same town and range, may be recorded on this certificate.

A. Description of original monument and accessories and/or subsequent restoration:

3 - This position was not established during the original government survey.

5 - This position was not established during the original government survey.

B. Description of corner evidence found and/or method applied in restoring or reestablishing corner:

3 - Established the Northwest corner of the Southwest quarter of the Northwest quarter of Section 24 per standard BLM instructions for subdivision of a section.

5 - Established the Northwest corner of the Southwest quarter of the Northeast quarter of Section 24 per standard BLM instructions for subdivision of a section.

C. Description of monument for corner and accessories established to perpetuate locating the position of the corner:

3 - Set 5/8" x 32" rerod with cap and set carsonite marker post.

5 - Set 5/8" x 32" rerod with cap and set carsonite marker post.

Wit: Set nail in 4" Maple S 18° E 12.10'
 Set nail in 6" Maple S 65° W 8.47'
 Set nail in 5" Maple N 55° E 3.68'
 Set nail in 7" Maple N 25° W 22.27'
 Set carsonite post North 1'

Wit: Set nail in 4" Beech N 7° E 42.07'
 Set nail in 4" Beech N 40° W 31.13'
 Set nail in 8" Poplar S 40° W 9.02'
 Set nail in 10" Poplar S 37° E 31.33'
 2.5' south of old fence line
 Set carsonite post North 1'

Signed by Carl T. Kiiskila

Surveyor's Michigan License No. 33981

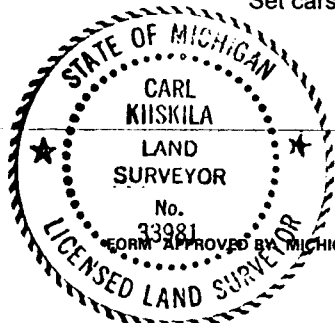

Date 7-26-99