

**SURVEY & REMONUMENTATION**

JAN 26 1998

SECTION

**LAND CORNER RECORDATION CERTIFICATE**  
Filing Requirement of Act 74, Mich. P.A. 1970

STATE OF MICHIGAN  
COUNTY OF CHARLEVOIX  
RECEIVED FOR RECORD

97 DEC 15 PM 2:41

*Charles M. Baker*  
REGISTER OF DEEDS

For corners in

Charlevoix

(County)

Located In:

Corner Code #

1. Public Land Survey

T 32N R 7W

A-5

T R

M-5

T 32N R 8W

T R

2. Property Controlling in Section

S T R

S T R

S T R

S T R

3. Miscellaneous Property in Sec.

4. Lot No. \_\_\_\_\_, Recorded Plat \_\_\_\_\_  
5. Private Claims \_\_\_\_\_

Wayne E. Boss

May 97

I, \_\_\_\_\_, in a field survey on \_\_\_\_\_, 19\_\_\_\_ do hereby state that under requirements of P.A. 74, Michigan P.A. of 1970, the corner points mentioned in lines 1 and 2 above were in conformance with regulations and rules therefore as required in the current manual of survey instructions of the United States Department of the Interior, Bureau of Land Management or by a decree of a Court of Law and for that the corner points mentioned in lines 3, 4 and 5 above were in conformance with the rules of the Michigan Board of Land Surveyors or by a Decree of a Court of Law, established, re-established, monumented, recovered, found as expressed below:

NOTE: Not more than 2 corners, all in the same town and range, may be recorded on this certificate.

	A	B	C	D	E	F	G	H	I	J	K	L	M
1													
2	6		5		4		3		2		1		
3													
4	7		8		9		10		11		12		
5													
6	19		17		16		15		14		13		
7													
8	19		20		21		22		23		24		
9													
10	30		29		28		27		26		25		
11													
12	31		32		33		34		35		36		
13													

A. Description of original monument and accessories and/or subsequent restoration:

- A-5 OCT. 1856  
E.D. ATWATER DEPUTY SURVEYOR  
SET CEDAR POST 5 INCH  
1. MAPLE 5" N50 3/4W 30 LKS.  
2. YELL. BIRCH 14 " S75W 26 LKS.
- APRIL 15, 1978  
BERYL M. JONES  
FOUND 1/2" IR  
3. SCRUB TREE N86E 87.35'  
4. FENCE POST S06E 48.0'  
Li. 002, Pg. 32
- LENNOX & ASSOCIATES  
FOUND 1/2" IR  
3. SCRUB TREE N86E 87.35'  
4. PWR. POLE S50E 71.45'  
5. FENCE POST S06E 48.0'
- NOV. 13, 1996, JOHN E. FERGUSON, FD. 1/2" IR, 4. PWR POLE N42E 71.31', 5. FENCE POST S06E 48.41', 6. 8" APPLE N85E 87.39', 7. FENCE POST S43W 128.74'

B. Description of corner evidence found and/or method applied in restoring or reestablishing corner:

- A-5 MAY 1997  
FOUND 1/2" IR  
4. POWER POLE N42E 71.31'  
5. FENCE POST S06E 48.41'  
6. 8" APPLE N85E 87.39'  
7. FENCE POST S43W128.74'  
8. UNDER GROUND TELEPHONE CABLE MARKER N32W 43.41'  
9. STREET SIGN POST N65E 50.35'

Charlevoix Co. Surveyor  
**APPROVED**  
Signature *Mary C. Ferris*  
Date: *12-23-97*

C. Description of monument for corner and accessories established to perpetuate locating the position of the corner:

- A-5 1/2" IRON REPLACED WITH STEEL CHARLEVOIX COUNTY MARKER  
4. POWER POLE N42E 71.31'  
5. FENCE POST S06E 48.41'  
6. 8" APPLE N85E 87.39'  
7. FENCE POST S43W 128.74'  
8. UNDER GROUND TELEPHONE CABLE MARKER N32W 43.41'  
9. STREET SIGN POST N65E 50.35'  
AND IS ACCEPTED AS A CAREFUL & FAITHFUL REESTABLISHMENT OF THE POSITION OF THE ORIGINAL CORNER

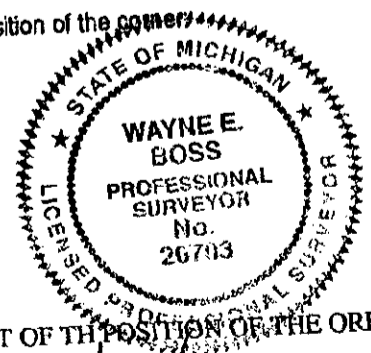

Signed by \_\_\_\_\_  
Surveyor's Michigan License No. 70703

Date 12/12/97